



Coral Academy of Science Las Vegas

Finance and Facilities Committee Meeting

Date and Time

Tuesday February 11, 2025 at 2:00 PM PST

Location

8985 S. Eastern Ave. #375
Las Vegas, NV 89123

Posting of Agenda: This agenda has been posted at the following locations:

Coral Academy of Science Las Vegas ("CASLV") Central Office, CASLV website at www.caslv.org, and Nevada Public Notice website at <http://notice.nv.gov>.

Format / Procedures / Rules: This is a notice of a public meeting held pursuant to NRS Chapter 241. Members of the public are invited to be present.

Certain items may be removed from open/public consideration if permitted or required by Nevada law. The Board may also (i) take agenda items out of order; (ii) combine two or more items for consideration; (iii) separate one item into multiple items; (iv) table an agenda item to a future meeting; and/or (v) remove an agenda item.

Reasonable efforts will be made to assist and accommodate persons with physical disabilities desiring to attend the meeting. Please contact Ms. Shepard at ashepard@coralacademylv.org at least 48 hours before the time of the meeting, if possible, so that reasonable arrangements may conveniently be made.

Please also contact Ms. Shepard if you would like a copy of the agenda and any public reference materials relating to agenda items. Those materials will also be available at the meeting location. Those materials would provide you with greater context and clarity as to the matters under discussion.

By law, no one may willfully disrupt the meeting to the extent that its orderly conduct becomes impractical.

All items are action or possible action items if denoted as such.

Agenda

	Purpose	Presenter	Time
I. Opening Items			2:00 PM
A. Call the Meeting to Order		Chan Lengsavath	5 m
Call to order			
Roll Call			
Pledge of Allegiance			
B. Public Comment			10 m
<p>Comments from the public are welcome at this time. You may present your comment during the meeting or beforehand, by contacting Ms. Shepard and relaying the comment to her. No person may sign up for another person, nor yield his/her time to another person. The Board may not deliberate on, or take any action regarding, a matter raised during the public comments sessions, unless the matter itself has already been specifically included on the agenda as an "Action" Item (and then, only at the time such Item is heard). The Board President will limit public comment to 3 to 5 minutes per person to ensure that all participants may speak and the Agenda is not unduly delayed, subject to any brief extension granted by the Board President in his/her sole discretion. No restrictions apply based on the speaker's viewpoints. If the Board hears public comments which exceed, in total, 20 minutes, the Board may postpone the remainder of the public comments to the same agenda item at the end of the meeting. The Board President may, in her discretion, forego Items I (B) and second-to-last item and instead solicit Public Comments during each individual action item below, as permitted by NRS 241.020(3)(d)(3); or alternatively keep Items I (B) and VII but still permit Public Comments during certain (but not necessarily all) individual action items below. The information above applies to all Public Comment periods.</p>			
II. Discussion & Possible Action Items			2:15 PM
A. Amendment to the HVAC Maintenance Vendor, Emcor's Agreement (For Possible Action)	Vote	Selim Tanyeri	5 m

	Purpose	Presenter	Time
B. Nellis Expansion Update (For Possible Action)	Vote	Selim Tanyeri	10 m
C. Construction Updates for Campuses (For Possible Action)	Vote	Selim Tanyeri	5 m
D. Eastgate Campus Facility Update (For Possible Action)	Vote	Dr. Ercan Aydogdu	10 m
E. Centennial Hills Expansion Update (For Possible Action)	Vote	Selim Tanyeri	15 m
F. Health Insurance Renewal (For Possible Action)	Vote	Bridget Johnson-Peevy	5 m
G. Windmill and Sandy Ridge Shade Structures (For Possible Action)	Vote	Selim Tanyeri	5 m
H. Amendment to the Cadence Additional Classroom Construction (For Possible Action)	Vote	Selim Tanyeri	5 m
I. Financial Update (Information)	FYI	Nick Sarisahin	5 m
<i>CALSV's Chief Financial Officer will update the Facility and Finance Committee about the current financial status.</i>			
J. Review of CASLV Investment Report (Information)	FYI	Nick Sarisahin	5 m
<i>CASLV's Chief Financial Officer will update the Facility and Finance Committee on the current reserve balance and the YTD income from the relevant investment accounts.</i>			
K. Review of Form 990 (Information)	FYI	Nick Sarisahin	5 m

III. Public Comments (Information)

Please see the procedures and rules in item I(B) above.

IV. Closing Items

A. Adjourn Meeting (For Action)	Vote
---	------

Coversheet

Amendment to the HVAC Maintenance Vendor, Emcor's Agreement (For Possible Action)

Section:	II. Discussion & Possible Action Items
Item: (For Possible Action)	A. Amendment to the HVAC Maintenance Vendor, Emcor's Agreement
Purpose:	Vote
Submitted by:	
Related Material:	Summary.docx Addendum to Existing Maintenance Contract -Coral Nellis.pdf Addendum to Existing Maintenance Contract - Coral Cadence.pdf

HVAC Preventative Maintenance Addendum Request

The vendor Emcor, which services Cadence and Nellis, wants to increase their quarterly pricing for each campus.

“The minor increases reflect minor increases to account for material and labor fluctuations over the past two years. We do our best to delay price increases as long as possible, but it has become necessary for us to do so.”

Cadence: Emcor wants to increase their annual cost from \$34,380 to \$35,520.

Nellis: Emcor wants to increase their annual cost from \$15,048 to \$16,248.

Recommendation: Approve each increase.



Mesa Energy Systems, Inc. Addendum



Prepared for:

Coral Academy – Nellis AFB Campus

Agreement:

By and between:

Coral Academy
8965 S. Eastern Ave. Suite
280
Las Vegas, NV 89123

and

Mesa Energy Systems Inc.,
dba EMCOR Services Nevada
2 Cromwell
Irvine, CA 92618

Addendum to Proposal# 22-023650:

Service Address: CORAL ACADEMY – NELLIS AFB CAMPUS
107 Stafford Dr., NAFB Las Vegas, NV 89115

Services:

	Service	Annual Services
✓	Scheduled Inspections	Quarterly
✓	Preventive Maintenance Actions	Quarterly
✓	Filter Service: Quarterly TYPE: MERV 13	
✓	Condenser Coil Cleaning	Annually
✓	Priority Service	Year Round
✓	Preferred Customer Discount	Year Round

Price:

Our services will be performed as outlined for an annual price of \$16,248.00. This amount will be billed at **\$ 1,354.00 Quarterly**.

All terms and conditions stated in proposal #24-023650 signed and dated 12/06/2022 by Ercan Aydogdu, are applicable to this addendum.

Customer Acceptance:

Signature

Printed Name

Title

Date

Mesa Energy Systems Acceptance:

Signature

Printed Name

Title

Date



Mesa Energy Systems, Inc. Addendum



Prepared for:

Coral Academy – Cadence Campus

Agreement:

By and between:

Coral Academy
8965 S. Eastern Ave. Suite
280
Las Vegas, NV 89123

and

Mesa Energy Systems Inc.,
dba EMCOR Services Nevada
2 Cromwell
Irvine, CA 92618

Addendum to Proposal# 22-023648:

Service Address: CORAL ACADEMY - CADENCE CAMPUS
10 Cadence Crest Ave. Henderson, NV 89011

Services:

	Service	Annual Services
✓	Scheduled Inspections	Quarterly
✓	Preventive Maintenance Actions	Quarterly
✓	Filter Service: Quarterly TYPE: MERV 13	
✓	Condenser Coil Cleaning	Annually
✓	Priority Service	Year Round
✓	Preferred Customer Discount	Year Round

Price:

Our services will be performed as outlined for an annual price of \$ 35,520.00. This amount will be billed at **\$ 2,960.00 Quarterly.**

All terms and conditions stated in proposal #24-023648 signed and dated 12/06/2022 by Ercan Aydogdu, are applicable to this addendum.

Customer Acceptance:

Signature

Printed Name

Title

Date

Mesa Energy Systems Acceptance:

Signature

Printed Name

Title

Date

Coversheet

Centennial Hills Expansion Update (For Possible Action)

Section:	II. Discussion & Possible Action Items
Item:	E. Centennial Hills Expansion Update (For Possible Action)
Purpose:	Vote
Submitted by:	
Related Material:	02_07_2025-Coral Academy Centennial_Site Analysis_.pdf



CORAL ACADEMY AT CENTENNIAL HILLS SITE ANALYSIS tsk

PROJECT SITE LOCATION

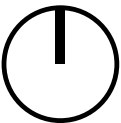

PROJECT SITE TOPOGRAPHY

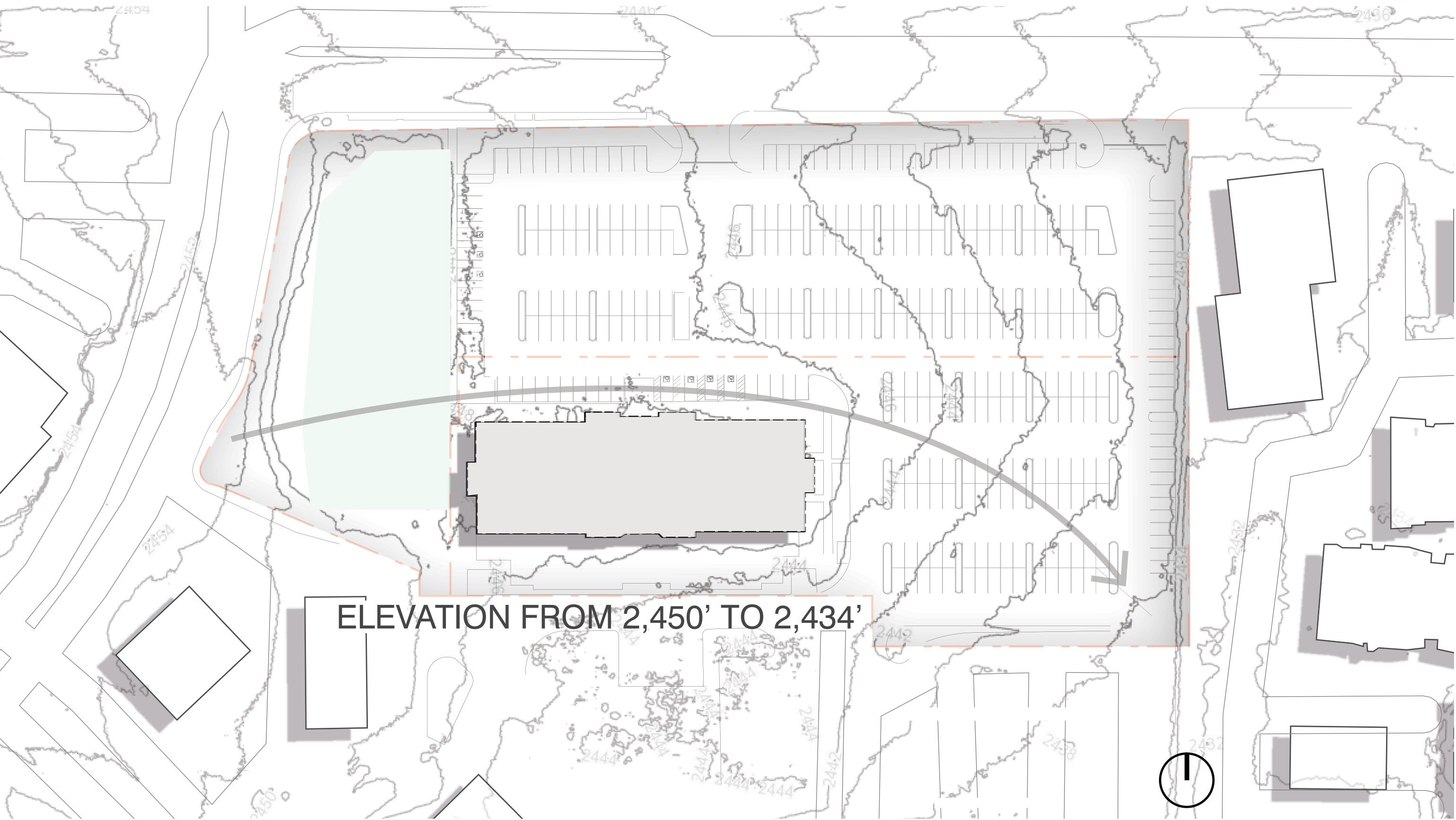

CAFETERIA PROPOSED EXPANSION

SITE PLAN

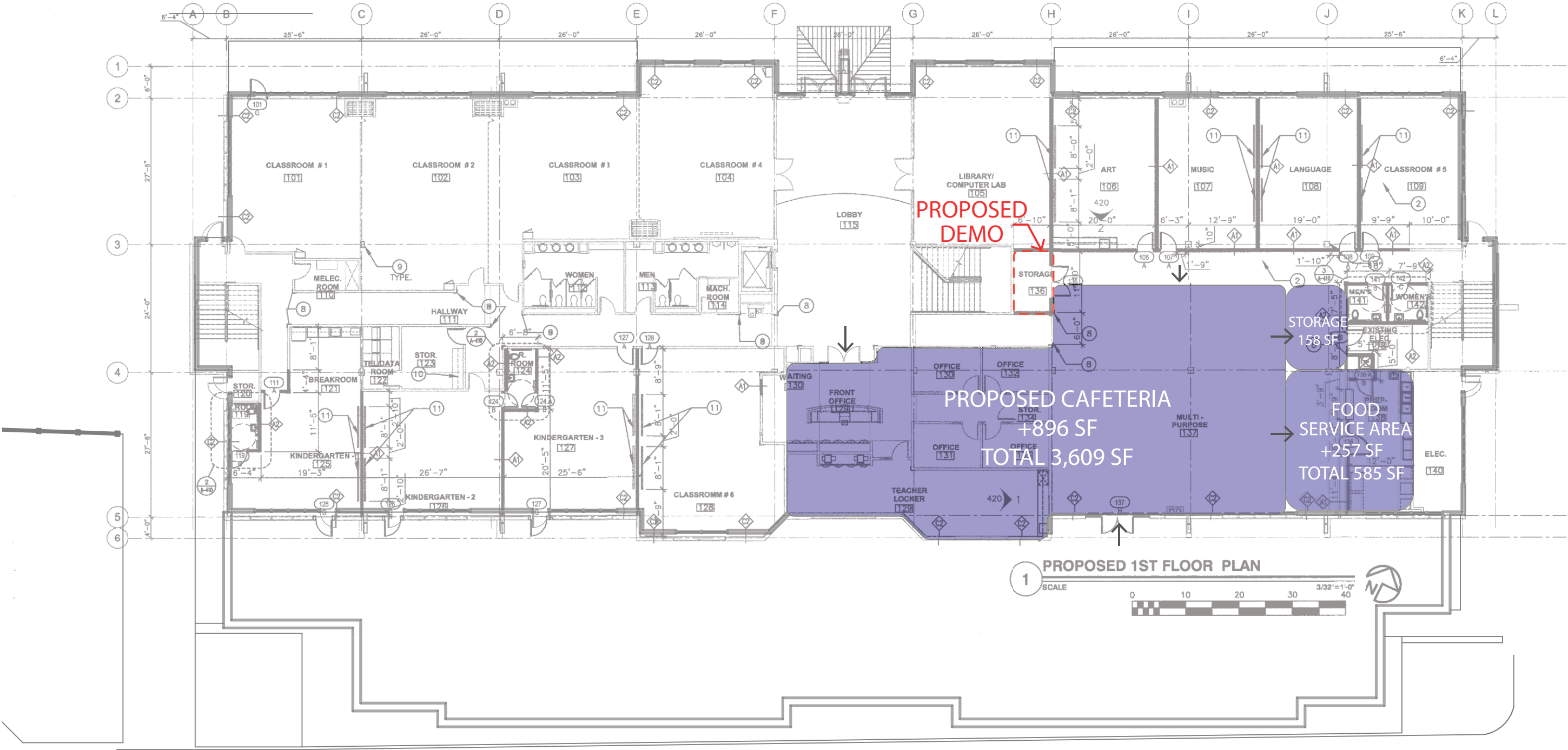

OPTION 1
SITE PLAN

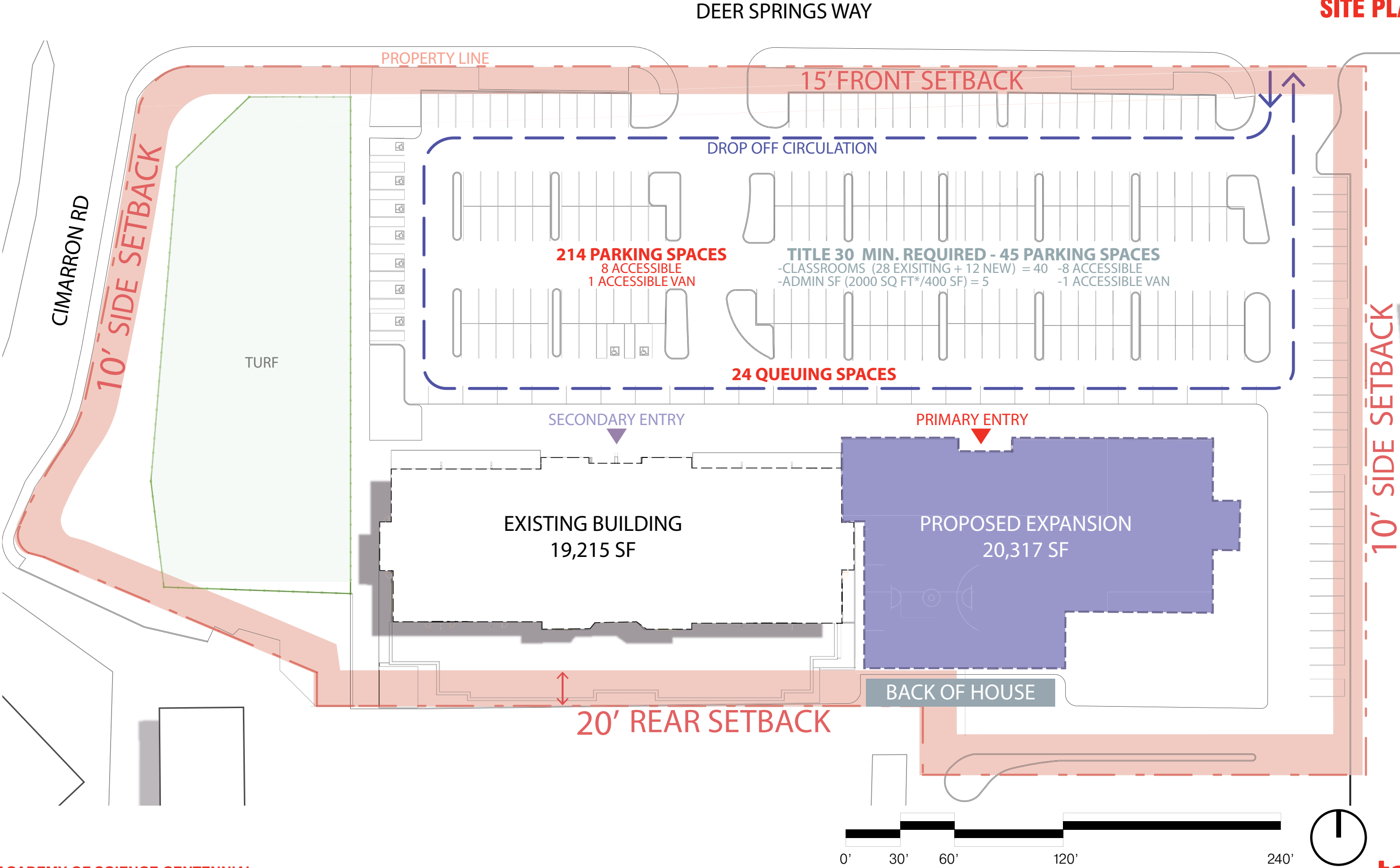

OPTION 1
FLOOR PLAN - LEVEL 1

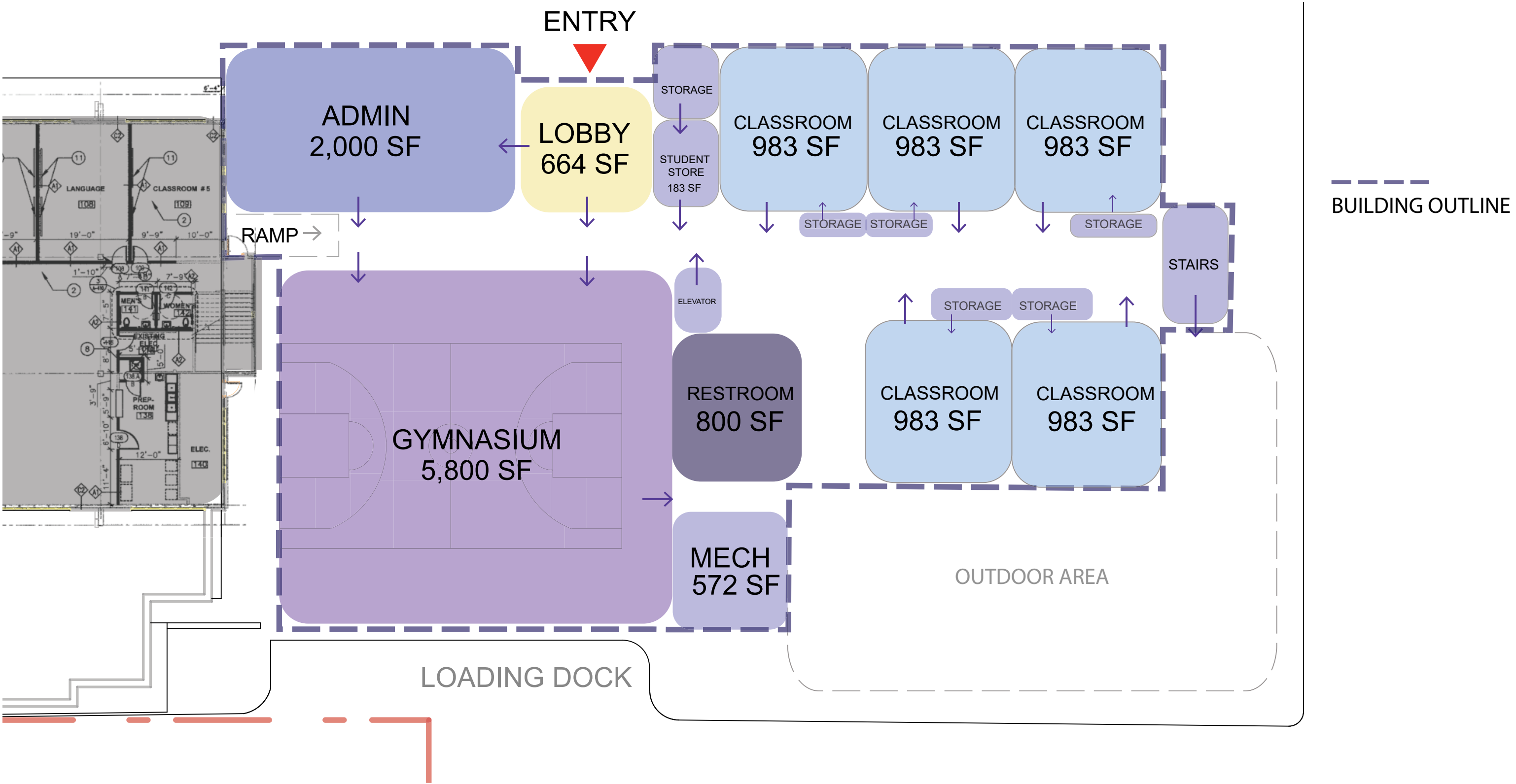

OPTION 1
FLOOR PLAN - LEVEL 2

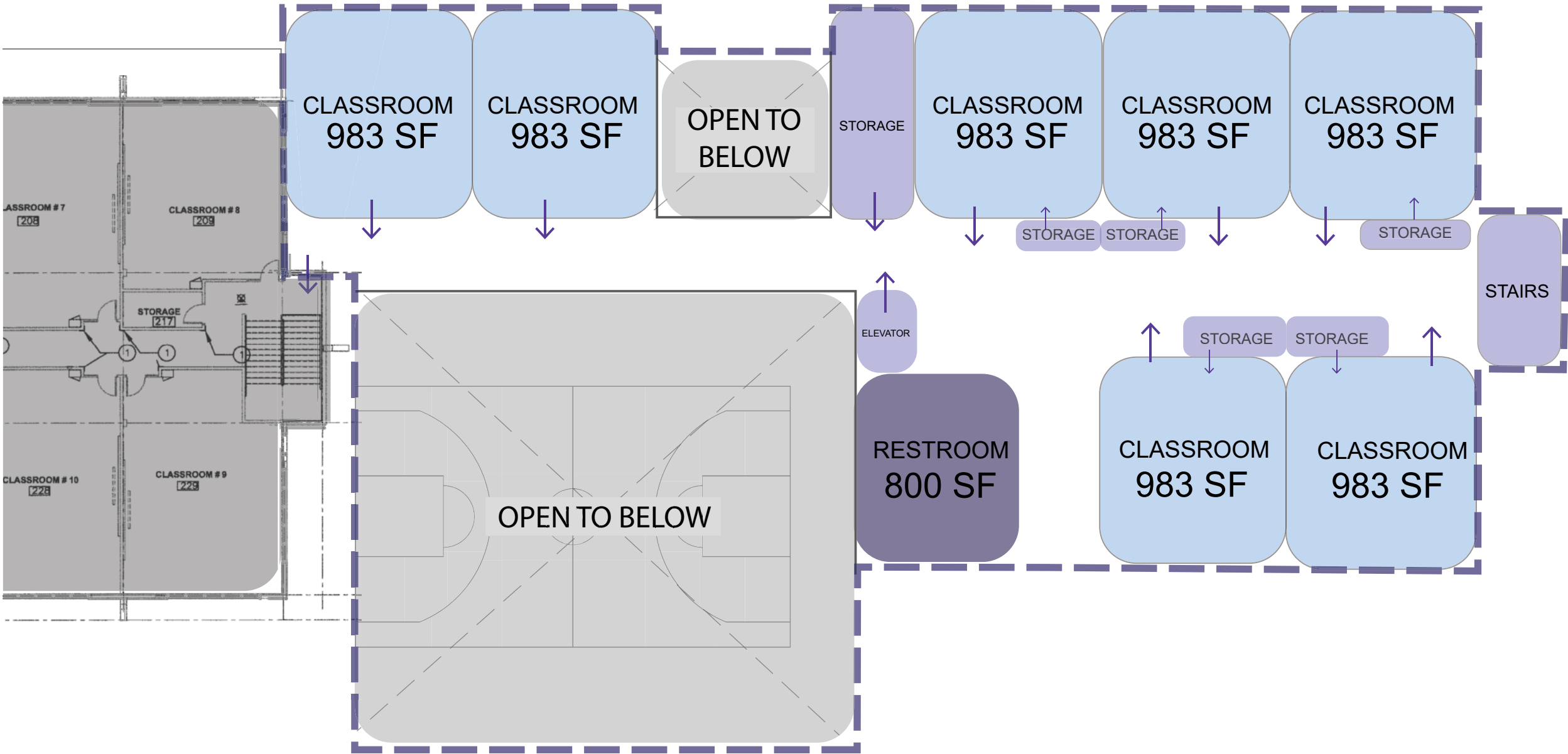

BUILDING OUTLINE

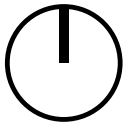

OPTION 1
MASSING

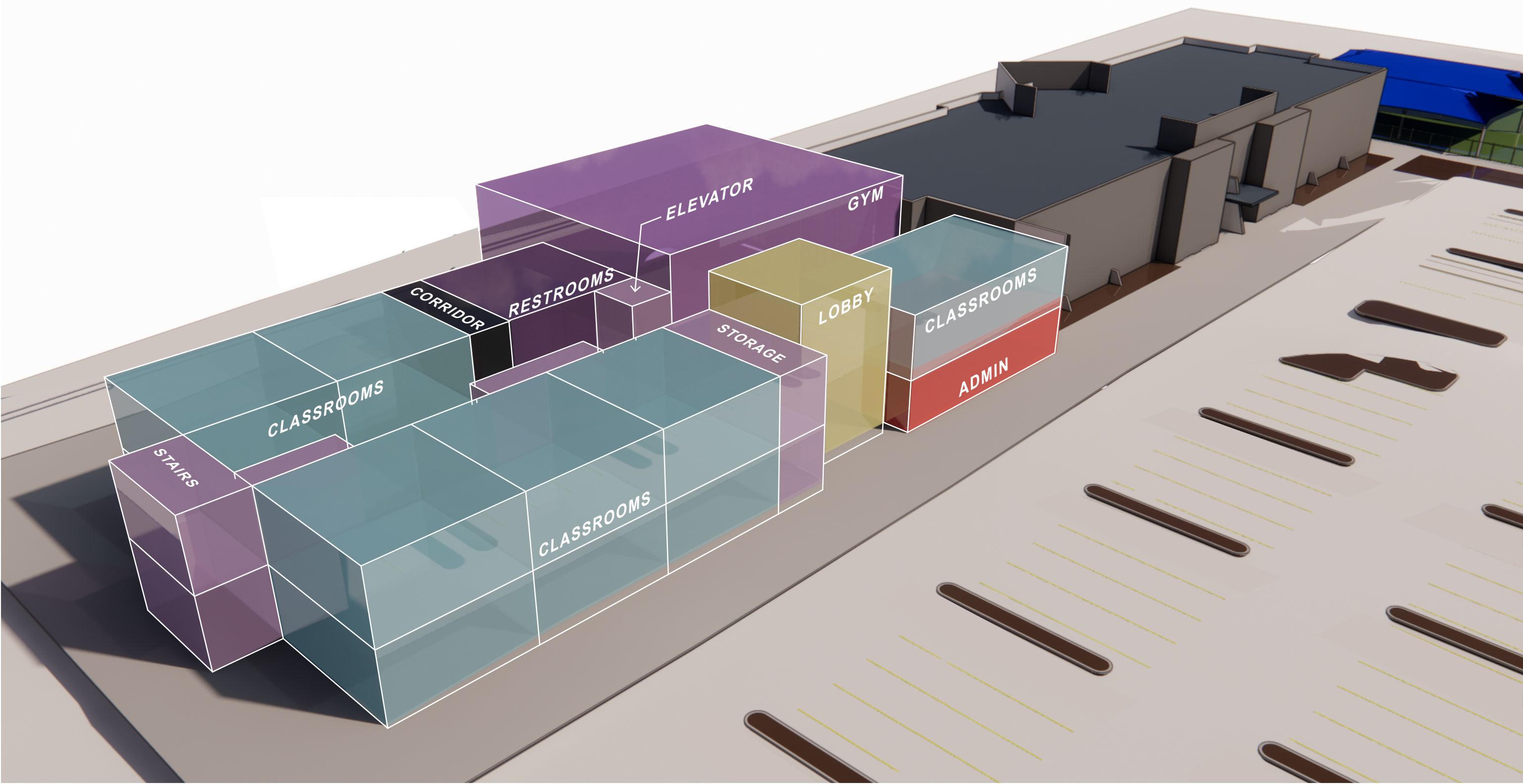

OPTION 2A SITE PLAN

DEER SPRINGS WAY

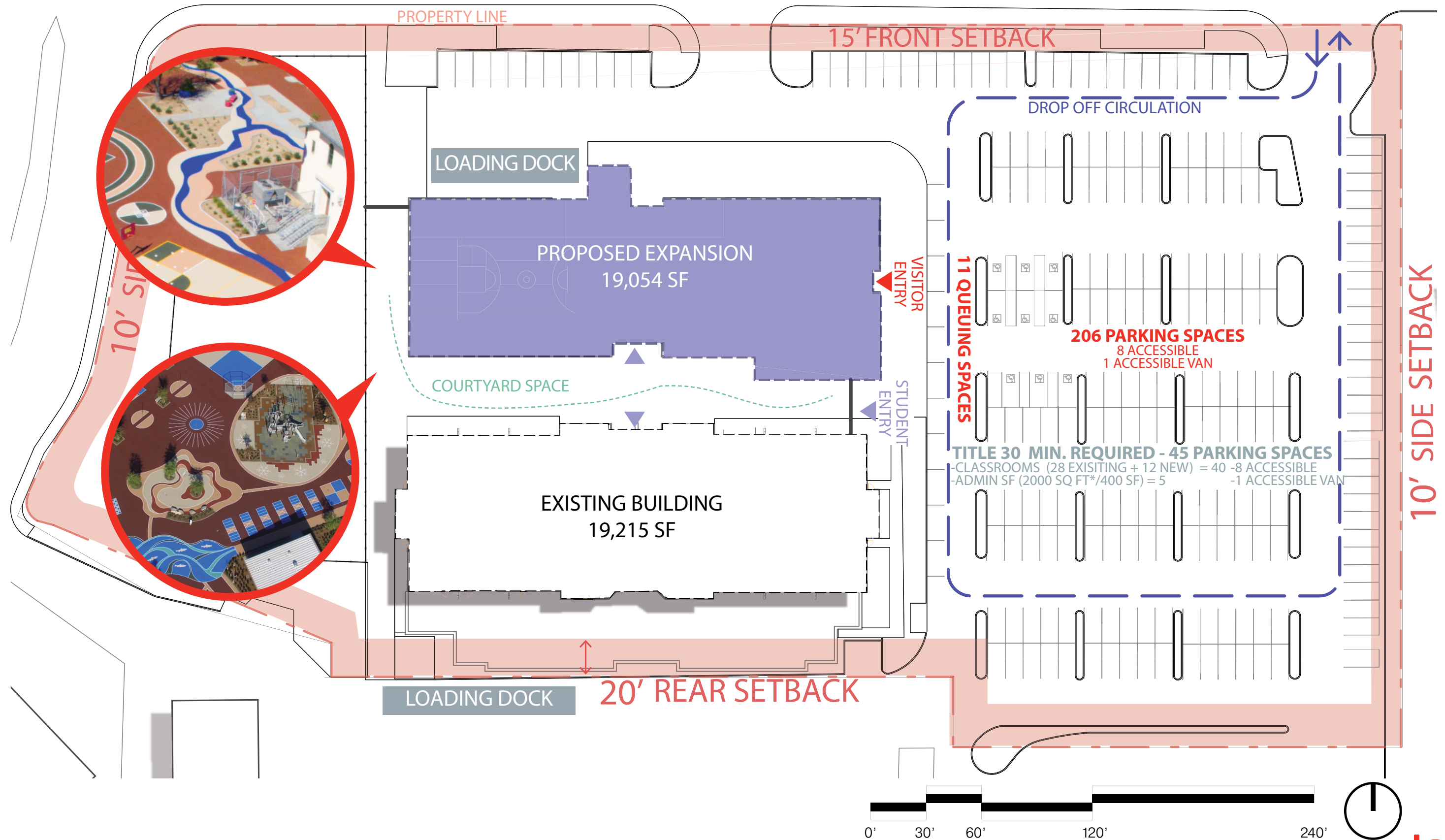

OPTION 2A
FLOOR PLAN - LEVEL 1

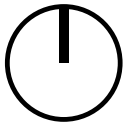
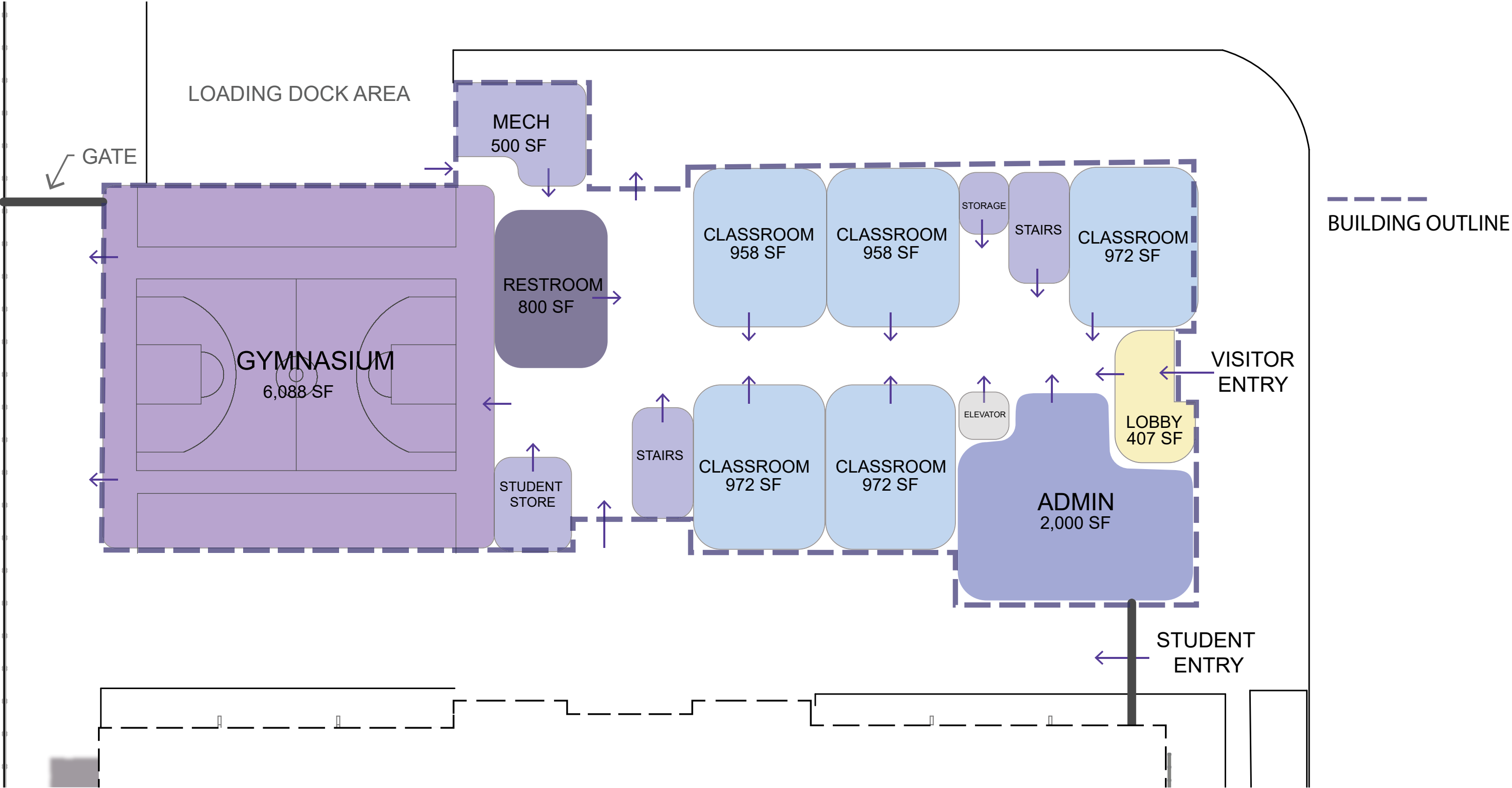

OPTION 2A
FLOOR PLAN - LEVEL 2

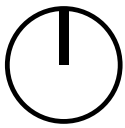
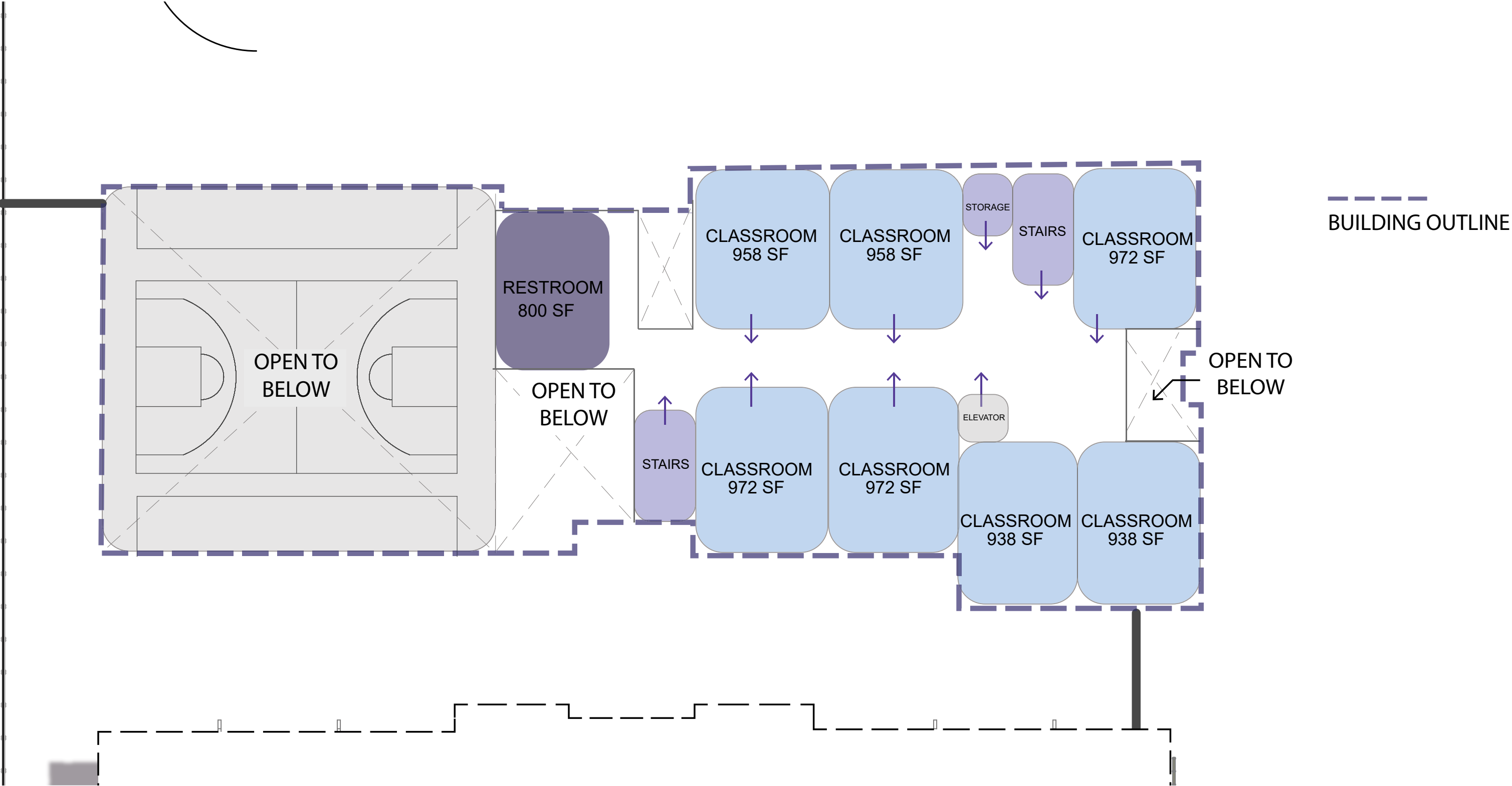

OPTION 2A
MASSING

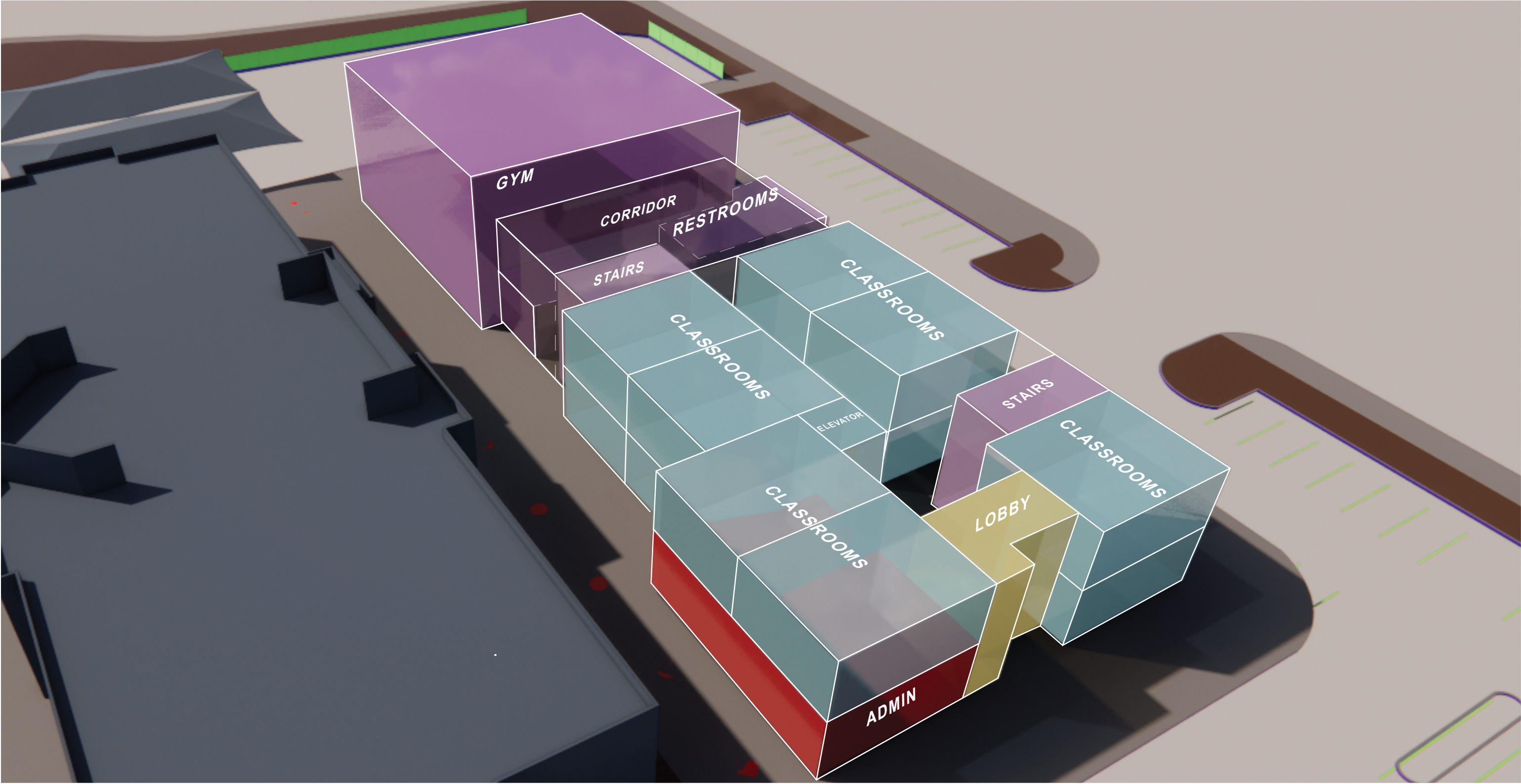

Coversheet

Health Insurance Renewal (For Possible Action)

Section: II. Discussion & Possible Action Items
Item: F. Health Insurance Renewal (For Possible Action)
Purpose: Vote
Submitted by:
Related Material:
Coral Academy Rate Analysis Final.xls
Coral Academy of Science Las Vegas - (BAFO) Dental Renewal - 4-2025 - sh.pdf
Coral Academy of Science Las Vegas_2025 Life Renewal.pdf
Coral Academy of Science Las Vegas - (BAFO) Vision Renewal - 4-2025 - sh.pdf
CASLV 2025 Dental and Vision Contributions.xlsx
CASLV 2025 Medical Contribution Analysis.xlsx

Notice

The following file is attached to this PDF. You will need to open this packet in an application that supports attachments to pdf files, e.g. [Adobe Reader](#):

Coral Academy Rate Analysis Final.xls



Renewal for CORAL ACADEMY OF SCIENCE LAS

Issued on: February 3, 2025



**United
Healthcare**

UnitedHealthcare**Dental Renewal for CORAL ACADEMY OF SCIENCE LAS**

Effective Date: 04/01/2025 | Policy Number: 00917423

Dental Services	Passive PPO 8P041 CS0		Incentive PPO 54P47 CS0	
Legal Entity	UnitedHealthcare Insurance Company		UnitedHealthcare Insurance Company	
	Primary Plan		Primary Plan	
	In Network	Out of Network	In Network	Out of Network
Diagnostic Service				
Periodic Oral Evaluation	100%	100%	100%	100%
Radiographs	100%	100%	100%	100%
Lab and Other Diagnostic Tests	100%	100%	100%	100%
Preventive Services				
Dental Prophylaxis (Cleaning)	100%	100%	100%	100%
Fluoride Treatment	100%	100%	100%	100%
Sealants	100%	100%	100%	100%
Space Maintainers	100%	100%	100%	100%
Basic Services				
Restorations (Amalgams or Composite)*	80%	80%	90%	80%
Posterior Composites	Excluded	Excluded	Included	Included
Emergency Treatment/General Services	80%	80%	90%	80%
Simple Extractions	80%	80%	90%	80%
Oral Surgery (incl. surgical extractions)	80%	80%	90%	80%
Periodontics	80%	80%	90%	80%
Endodontics	80%	80%	90%	80%
Major Services				
Inlays/Onlays/Crowns	50%	50%	60%	50%
Dentures and Removable Prosthetics	50%	50%	60%	50%
Fixed Partial Dentures (Bridges)	50%	50%	60%	50%
Orthodontic Services				
Orthodontia	50%	50%	50%	50%
Orthodontia Eligibility	Child Only (Up to Age 19)		Adult & Child	
Deductible (Individual/Family)	\$25/\$75	\$25/\$75	\$25/\$75	\$25/\$75
Deductible applies to Prev. & Diag.	No	No	No	No
Annual Max	\$1,500	\$1,500	\$2,500	\$2,500
Lifetime Ortho Max	\$1,500	\$1,500	\$2,500	\$2,500
Waiting Period	None		None	
Out of Network Basis	MAC		MAC	
PPO Network	Options PPO 20		Options PPO 20	
CMM—Annual Roll-Over	Yes		Yes	
Assumed Enrollment and Rates	Current	Renewal	Current	Renewal
Employee	200 \$36.90	\$36.90	61 \$50.09	\$50.09
Employee + Spouse	23 \$74.91	\$74.91	11 \$101.69	\$101.69
Employee + Child(ren)	40 \$98.59	\$98.59	20 \$133.83	\$133.83
Employee + Family	33 \$146.08	\$146.08	15 \$198.30	\$198.30
	296		107	
Monthly Premium	\$17,867.17	\$17,867.17	\$9,825.18	\$9,825.18
Annual Premium	\$214,406.04	\$214,406.04	\$117,902.16	\$117,902.16
Renewal Action	0.0%		0.0%	
Employer Contribution	Contributory		Voluntary	
Participation Requirements	75% of Eligible Employees		Minimum of 3 ees	
Dependent Children Coverage	To Age 26		To Age 26	
Contract Basis	Fully Insured		Fully Insured	
Benefit Period Basis	Calendar Year		Calendar Year	
Exclusions and Limitations	Standard		Standard	
Broker Commissions	10%		10%	
Rate Guarantee	12 Months		12 Months	

UnitedHealthcare

Assumptions for CORAL ACADEMY OF SCIENCE LAS

Effective Date: 04/01/2025 | Policy Number: 00917423

General Assumptions

- We reserve the right to change rates and/or plan provisions if the number of lives or volume of insurance change by more than 10% before, on, or after the effective date listed above or if factors used to generate this quote such as group demographics or effective date are changed, found to be incomplete or incorrect.
- Rates assume no changes in legislation or regulation that affects the benefits payable, eligibility or contract.
- Rates assume standard administrative services including Claims & Data processing, Enrollment & Billing, Customer Service, Case Management, Provider Relations, and Reporting.
- Assumed contract situs is Nevada.
- Employees must be U.S. citizens or residents regularly working and living in the U.S. Coverage for U.S. citizens working outside of the U.S. must be approved in writing by us. Approval depends on locale and length of assignment.
- Employer's assumed primary business is classified as 8211.
- Rates may increase on renewal in accordance with the terms of the policy.

Dental Assumptions

This premium may include state and federal taxes and fees.

Rates listed above assume the plan designs quoted. Rates may change, if plan design changes.

Our contract covers only those procedures performed in the United States.

One or more of these plan design offerings include the MaxMultiplier benefit.

Some of the unused portion of your annual maximum may be available in future periods.

Please contact your sales representative for more details on the network quoted in your proposal.

The In- and Out-of-Network Plan Deductibles, Maximums and Lifetime Ortho Maximums are combined.

* Please contact your sales representative to confirm specific plan Restorations (Amalgams or Composite) coverage.

Quote is based on total group Average Contract Size (ACS) of 1.74

United Healthcare reserves the right to adjust the above rates should enrollment or ACS fluctuate by +/- 10%.

Digital ID cards will be available on-line, upon initial enrollment, for employees enrolled in PPO, INO and Indemnity plans. Plastic ID cards will be issued, upon initial enrollment, for employees enrolled in Direct Compensation, Select Managed Care and DHMO plans.

Please note that the summary of benefits in this document provides a brief description of coverage. State mandates may preclude certain benefit plan design features. This is not a policy, certificate of insurance or coverage document. For complete details on coverage, exclusions, limitations and the terms under which coverage may continue, please contact your sales representative.

UnitedHealthcare

Disclaimers for CORAL ACADEMY OF SCIENCE LAS

Effective Date: 04/01/2025 | Policy Number: 00917423

This proposal is valid for 90 days from the issued date, unless otherwise noted within this document.

Brokers and agents may receive commissions, bonuses and other compensation for selling the products presented in this proposal. The cost of this compensation may be directly or indirectly reflected in the premium or fees for those products. Contact your broker and/or agent if you have questions regarding their compensation relating to products in this proposal.

This proposal is subject to negotiation and execution of a written agreement, which will supersede the proposal contents. This proposal does not constitute an agreement, and is based on assumptions made from the written information in our possession and provided by you. We retain the right to modify our proposal if the information upon which this proposal is based is changed or is supplemented.

We consider much of the information contained in the proposal to be proprietary or otherwise confidential, and are releasing this proposal to you on the understanding that you and your representatives will only use it, and any data included in the proposal, for the specific purpose of evaluating its content. If this is not consistent with your understanding, please notify us before reviewing the proposal.

In addition, by accepting and reviewing the contents of this proposal, you and your agents or other designees agree, to the extent permitted by law, that certain information contained herein, or other information provided to you in connection with this proposal response or associated request for proposal (RFP), is proprietary and/or confidential to UnitedHealthcare and its related entities, and may not be copied, used, distributed or disclosed without prior written consent from an authorized representative of UnitedHealthcare, other than is necessary to evaluate this proposal.





Renewal for Coral Academy of Science Las Vegas

Issued on: December 3, 2024



**United
Healthcare**

UnitedHealthcare

Life Renewal for Coral Academy of Science Las Vegas

Effective Date: 04/01/2025 | Policy Number: 00306247

Employee Basic Life Insurance	Class 1 BL6589 Primary	
Legal Entity	United Healthcare Insurance Company	
Eligibility	All Active Full Time Administrators and Central Staff Employees working a minimum of 30 hours per week.	
Basic Annual Earnings (BAE) Definition	The Annual Earnings received from the Covered Person's Employer for the year ending immediately prior to the Policy Anniversary period. Annual Earnings do not include commissions, bonuses, overtime pay and other extra compensation.	
Benefits Payable		
Benefit	2 X BAE Rounded to the Next higher \$1,000	
Benefit Maximum	\$200,000	
New Hire Guarantee Issue Limit	\$200,000	
Limitations and Exclusions		
Evidence of Insurability Requirements	Required for late entrants and amounts over Guarantee Issue amount. Also required for all coverage if minimum participation level is not met.	
Benefit Reduction	65%@65, 50%@70	
Coverage Termination	At Employee's Retirement	
Suicide Limitation	Excluded	
Additional Features		
Accelerated Death Benefit	50% of applicable benefit	
Life Expectancy	12 months	
Waiver of Premium	Included	
Elimination Period	9 months	
Disabled Prior To Age	Prior to age 60	
Benefits Payable to Age	To Age 65	
Portability	Excluded	
Conversion	Included; Must apply within 30 days of coverage termination	
Assumed Enrollment and Rates		
Number of Employees	417	
Volume of Insurance	\$32,746,600	
Rate Basis	Composite per \$1,000 of coverage	
	Current	Renewal
Monthly Rate	\$0.093	\$0.110
Monthly Premium	\$3,045.43	\$3,602.13
Annual Premium	\$36,545.21	\$43,225.51
Employer Contribution	100%	
Minimum Participation Requirement	100%	
Broker Commissions	10.0%	
Rate Guarantee	24 Months	

UnitedHealthcare

Life Renewal for Coral Academy of Science Las Vegas

Effective Date: 04/01/2025 | Policy Number: 00306247

Employee Basic AD&D Insurance	Class 1 ADD8178 Primary	
Legal Entity	United Healthcare Insurance Company	
Eligibility	All Active Full Time Administrators and Central Staff Employees working a minimum of 30 hours per week.	
Basic Annual Earnings Definition	The Annual Earnings received from the Covered Person's Employer for the year ending immediately prior to the Policy Anniversary period. Annual Earnings do not include commissions, bonuses, overtime pay and other extra compensation.	
Benefits Payable		
Benefit	2 X BAE Rounded to the Next higher \$1,000	
Benefit Maximum	\$200,000	
Loss Occurrence Period	365 days	
Seat Belt Benefit	10.0% to \$10,000	
Seat Belt & Air Bag Benefit	10.0% to \$20,000	
Loss of Life	100%	
Quadriplegia	100%	
Paraplegia	75%	
Hemiplegia	50%	
Loss of one hand	50%	
Loss of one foot	50%	
Loss of sight of one eye	50%	
Loss of both hands or both feet	100%	
Loss of sight of both eyes	100%	
Loss of one hand and sight of one eye	100%	
Loss of one foot and sight of one eye	100%	
Loss of thumb and index finger of same hand	25%	
Loss of speech	50%	
Loss of hearing	50%	
Limitations and Exclusions		
Benefit Reduction	65%@65, 50%@70	
Coverage Termination	At Employee's Retirement	
Exclusions	Standard	
Assumed Enrollment and Rates		
Number of Employees	417	
Volume of Insurance	\$32,746,600	
Rate Basis	Composite per \$1,000 of coverage	
	Current	Renewal
Monthly Rate	\$0.020	\$0.020
Monthly Premium	\$654.93	\$654.93
Annual Premium	\$7,859.18	\$7,859.18
Employer Contribution	100%	
Minimum Participation Requirement	100%	
Broker Commissions	10.0%	
Rate Guarantee	24 Months	
Optional Benefits		
Common Carrier Hazard Benefit	Amount equal to 100.0% of the AD&D benefit, not to exceed a maximum of \$100,000	

UnitedHealthcare

Assumptions for Coral Academy of Science Las Vegas

Effective Date: 04/01/2025 | Policy Number: 00306247

General Assumptions

- We reserve the right to change rates and/or plan provisions if the number of lives or volume of insurance change by more than 10% before, on, or after the effective date listed above or if factors used to generate this quote such
- Rates assume no changes in legislation or regulation that affects the benefits payable, eligibility or contract.
- Rates assume standard administrative services including Claims & Data processing, Enrollment & Billing, Customer Service, Case Management, Provider Relations, and Reporting.
- Assumed contract situs is Nevada
- Employees must be U.S. citizens or residents regularly working and living in the U.S. Coverage for U.S. citizens working outside of the U.S. must be approved in writing by us. Approval depends on locale and length of
- Employers assumed primary business is classified as 8211 SIC Code.
- Policy Form UHI-L-POL 2023
- Rates may increase on renewal in accordance with the terms of the policy.

Life and AD&D Assumptions

Continuity of Coverage/No Loss No Gain for previously covered employees is included.

Limitations for AD&D: Disease, bodily or mental infirmity, suicide or intentionally self-inflicted injury, commission of an assault or felony, war, use of any drug unless prescribed by a physician, driving while intoxicated, engaging in any hazardous activities, or travel in a private aircraft. Additional exclusions may apply depending upon the plan

Additional features included: Beneficiary Services, Will and Trust Preparation Service, Repatriation Benefit, Travel

UnitedHealthcare

Disclaimers for Coral Academy of Science Las Vegas

Effective Date: 04/01/2025 | Policy Number: 00306247

This proposal is valid for 90 days from the issued date, unless otherwise noted within this document.

Brokers and agents may receive commissions, bonuses and other compensation for selling the products presented in this proposal. The cost of this compensation may be directly or indirectly reflected in the premium or fees for those products. Contact your broker and/or agent if you have questions regarding their compensation relating to products in this proposal. This proposal is subject to negotiation and execution of a written agreement, which will supersede the proposal contents. This proposal does not constitute an agreement, and is based on assumptions made from the written information in our possession and provided by you. We retain the right to modify our proposal if the information upon which this proposal is based is changed or is supplemented.

We consider much of the information contained in the proposal to be proprietary or otherwise confidential, and are releasing this proposal to you on the understanding that you and your representatives will only use it, and any data included in the proposal, for the specific purpose of evaluating its content. If this is not consistent with your understanding, please notify us before reviewing the proposal.

In addition, by accepting and reviewing the contents of this proposal, you and your agents or other designees agree, to the extent permitted by law, that certain information contained herein, or other information provided to you in connection with this proposal response or associated request for proposal (RFP), is proprietary and/or confidential to UnitedHealthcare and its related entities, and may not be copied, used, distributed or disclosed without prior written consent from an authorized representative of UnitedHealthcare and its related entities, other than is necessary to evaluate this proposal."

The Plan Sponsor is responsible for identifying when EOI is required and providing EOI forms to the employee and/or dependent spouse for completion. The Plan Sponsor must confirm if EOI has been approved prior to beginning premium deductions for the coverage requiring EOI. If EOI is not submitted and approved as required under the policy and the Plan Sponsor incorrectly collects premiums for the coverage requiring EOI, the Plan Sponsor may be liable to the beneficiaries of the employee or their dependent.





Renewal for Coral Academy of Science Las

Issued on: February 3, 2025



United
Healthcare

UnitedHealthcare**Vision Renewal for Coral Academy of Science Las**

Effective Date: 04/01/2025 | Policy Number: 00917423

Vision Services	L008V			
Legal Entity	UnitedHealthcare Insurance Company			
	Primary Plan			
	In Network	Out of Network		
Plan Options				
Contribution	Voluntary			
Product Type	Exam with Materials			
Network Type	Standard Network			
Exam(s) Co-pay	\$10	Not Applicable		
Material Co-pay (Frames/Spectacle Lenses or Contact Lenses)	\$10	Not Applicable		
Service Frequency				
Exams/ Lenses/ Frames/Contacts	12/12/24/12			
Eye Examination				
Exam(s) (Includes additional eye exam for ages 0-18 and pregnant or breastfeeding women)	100%	Up to \$40		
Lenses				
Single Vision	100%	Up to \$40		
Lined Bifocal	100%	Up to \$60		
Lined Trifocal	100%	Up to \$80		
Lenticular	100%	Up to \$80		
Frames				
Retail Frame Allowance	Up to \$130	Up to \$45		
Discount on Frame Overage at participating providers	30%	Not Applicable		
Elective Contact Lenses				
Covered Formulary Contacts	Up to 4 boxes	Up to \$125		
Non-Formulary Contacts	Up to \$125	Up to \$125		
Necessary Contact Lenses	100%	Up to \$210		
Lens Options				
Covered-in-full Lens Options	Polycarbonate Lenses for Children up to Age: 19 Standard Scratch Coating	Not Applicable		
Other Lens Options	Pricing for lens options may range from 20-60% off retail pricing at participating providers (except where not permitted by state law).			
Value Services				
Laser Vision Discount	UnitedHealthcare is proud to add value to your vision care program by offering access to discounted laser vision correction procedures through QualSight LASIK, the largest LASIK manager in the United States. Member savings represent up to 35% off the national average price of LASIK. Discounts are also provided on newer technologies such as Custom Bladeless (all laser) LASIK. Visit myuhcvision.com for more information.			
Blue Light Protection Discount	UnitedHealthcare Vision has collaborated with industry partners to provide members with discount off the retail price on blue-light screen filters for their devices. Members can learn more and access discount information by visiting their plan website.			
Children's and Maternity Eye Care				
Replacement Eyeglasses				
Additional eyeglass frame/lenses due to prescription change (ages 0-18 and pregnant or breastfeeding women).	Members ages 0-18 and members pregnant or breastfeeding who have a prescription change of 0.5 diopter or more are eligible for a replacement frame and lenses. The replacement benefits are the same as the benefits for the initial frame and lenses. Not applicable for Exam Core or Exam with Discounted Material Plans.			
Assumed Enrollment and Rates		Current	Renewal	
Employee	264	\$7.42	\$7.61	
Employee + Spouse	27	\$14.07	\$14.42	
Employee + Child(ren)	60	\$16.50	\$16.91	
Employee + Family	50	\$23.19	\$23.77	
	401			
Monthly Premium	\$4,488.27	\$4,601.48		
Annual Premium	\$53,859.24	\$55,217.76		
Renewal Action		2.5%		
Participation Requirements	No Participation Requirement			
Dependent Children Coverage	To Age 26			
Contract Basis	Fully Insured			
Benefit Period Basis	Date of Service			
Exclusions and Limitations	Standard			
Broker Commissions	10%			
Rate Guarantee	24 months			

UnitedHealthcare

Proposed Vision Rates for Coral Academy of Science Las
Effective Date: 04/01/2025 | Policy Number: 00917423

Lens Options

The list below outlines the out of pocket charge a member may pay for particular lens options in-network, which reflect amounts of 20% to 60% of retail charges. In some cases members may pay less! Based on state guidelines, lens materials and options may not be available at these prices at all provider locations.

Type	L008V			
Scratch Warranty	\$10			
Tint	\$14			
UV Coating	\$16			
Photochromic for Adults	\$67			
Photochromic for Children	\$67			
Tier 1 Anti-Reflective	\$30			
Tier 2 Anti-Reflective	\$50			
Tier 3 Anti-Reflective	\$75			
Tier 4 Anti-Reflective	\$95			
Roll and Polish Edges	\$13			
Tier 1 Progressive	\$55			
Tier 2 Progressive	\$100			
Tier 3 Progressive	\$150			
Tier 4 Progressive	\$200			
Tier 5 Progressive	\$250			
High Index < 1.66	\$53			
High Index 1.66 - 1.73	\$63			
Polycarbonate for Adults	\$33			
Polycarbonate for Children	\$0			
Standard Scratch Coating	\$0			

Prices reflected are subject to change.

UnitedHealthcare

Assumptions for Coral Academy of Science Las

Effective Date: 04/01/2025 | Policy Number: 00917423

General Assumptions

- We reserve the right to change rates and/or plan provisions if the number of lives or volume of insurance change by more than 10% before, on, or after the effective date listed above or if factors used to generate this quote such as group demographics or effective date are changed, found to be incomplete or incorrect.
- Rates assume no changes in legislation or regulation that affects the benefits payable, eligibility or contract.
- Rates assume standard administrative services including Claims & Data processing, Enrollment & Billing, Customer Service, Case Management, Provider Relations, and Reporting
- Assumed contract situs is Nevada.
- Employees must be U.S. citizens or residents regularly working and living in the U.S. Coverage for U.S. citizens working outside of the U.S. must be approved in writing by us. Approval depends on locale and length of assignment.
- Employer's assumed primary business is classified as 8211 SIC Code.
- Rates may increase on renewal in accordance with the terms of the policy.

Vision Assumptions

This premium may include state and federal taxes and fees.

Quote assumes a complete product replacement.

Rates listed above are not included in quoted Medical rates (if applicable).

Rates listed above assume plan designs quoted. Rates may change, if plan design changes.

Please note that the summary of benefits in this document provides a brief description of coverage. State mandates may preclude certain benefit plan design features. This is not a policy, certificate of insurance or coverage document. For complete details on coverage, exclusions, limitations and the terms under which coverage may continue, please contact your sales representative.

UnitedHealthcare

Disclaimers for Coral Academy of Science Las

Effective Date: 04/01/2025 | Policy Number: 00917423

This proposal is valid for 90 days from the issued date, unless otherwise noted within this document. Brokers and agents may receive commissions, bonuses and other compensation for selling the products presented in this proposal. The cost of this compensation may be directly or indirectly reflected in the premium or fees for those products. Contact your broker and/or agent if you have questions regarding their compensation relating to products in this proposal.

This proposal is subject to negotiation and execution of a written agreement, which will supersede the proposal contents. This proposal does not constitute an agreement, and is based on assumptions made from the written information in our possession and provided by you. We retain the right to modify our proposal if the information upon which this proposal is based is changed or is supplemented.

We consider much of the information contained in the proposal to be proprietary or otherwise confidential, and are releasing this proposal to you on the understanding that you and your representatives will only use it, and any data included in the proposal, for the specific purpose of evaluating its content. If this is not consistent with your understanding, please notify us before reviewing the proposal.

In addition, by accepting and reviewing the contents of this proposal, you and your agents or other designees agree, to the extent permitted by law, that certain information contained herein, or other information provided to you in connection with this proposal response or associated request for proposal (RFP), is proprietary and/or confidential to UnitedHealthcare and its related entities, and may not be copied, used, distributed or disclosed without prior written consent from an authorized representative of UnitedHealthcare, other than is necessary to evaluate this proposal.



Notice

The following file is attached to this PDF. You will need to open this packet in an application that supports attachments to pdf files, e.g. [Adobe Reader](#):

CASLV 2025 Dental and Vision Contributions.xlsx

Notice

The following file is attached to this PDF. You will need to open this packet in an application that supports attachments to pdf files, e.g. [Adobe Reader](#):

CASLV 2025 Medical Contribution Analysis.xlsx

Coversheet

Windmill and Sandy Ridge Shade Structures (For Possible Action)

Section: II. Discussion & Possible Action Items
Item: G. Windmill and Sandy Ridge Shade Structures (For Possible Action)
Purpose: Vote
Submitted by:
Related Material:
Summary & Recommendation Windmill.docx
Type of Shade Windmill.jpg
Exerplay - EPI Q006411 Windmill.pdf
Sonntag Recreation - Windmill Campus Quote.pdf
Robertson Installations - Coral Windmill Shade Proposal.pdf
The Overhead Model Windmill.pdf
Type of Shade Sandy Ridge.pdf
The Overhead Model Sandy Ridge.pdf
Summary & Recommendation Sandy Ridge.pdf
Sonntag Recreation - Quote 1 Sandy Ridge.pdf
Robertson Installations - Coral Academy Sandy Ridge Proposal 1.14.25.pdf
Exerplay Estimate Q006930 Sandy Ridge.pdf

Summary & Recommendation

Exerplay: \$90,965.00

Robertson Installations: \$118,863.00

Sonntag Recreation: \$97,200.00

Recommendation: Exerplay

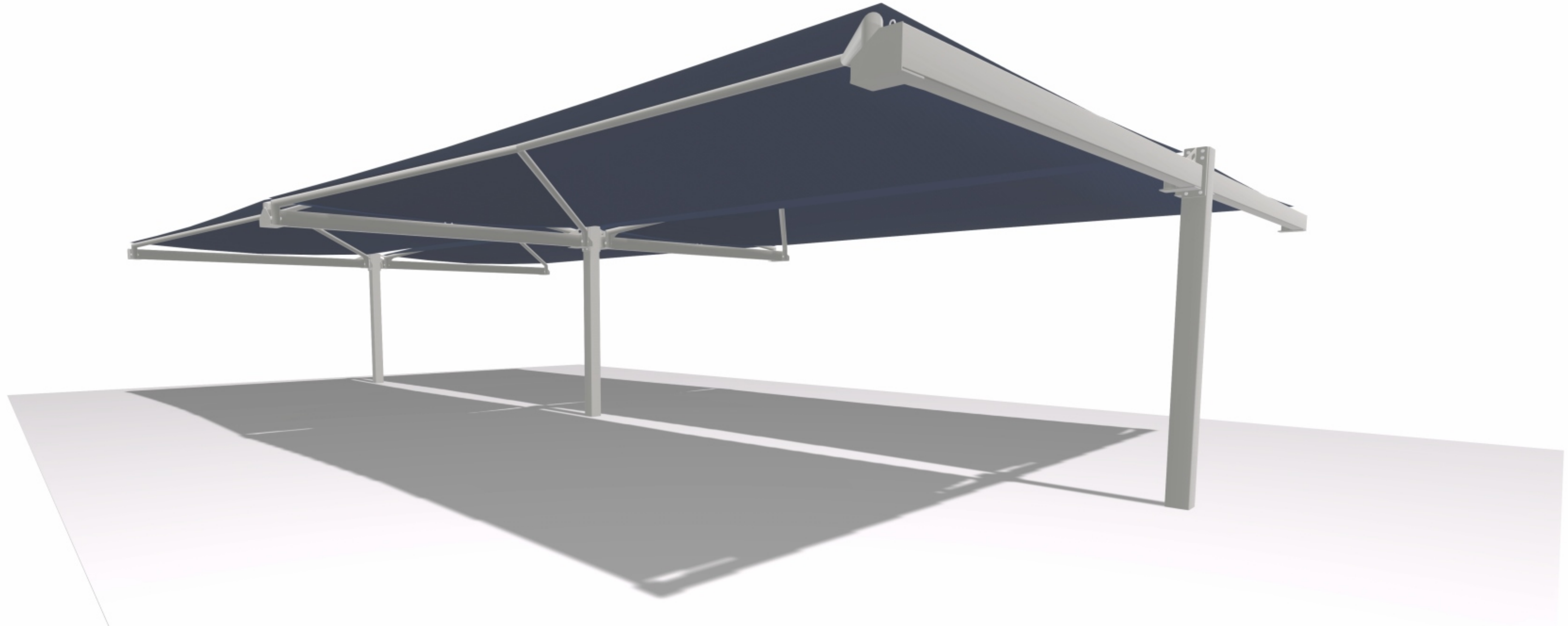

Coral Academy Windmill Campus Shade

003578A • 12.16.2024



© 2024 Landscape Structures. All Rights Reserved



Proposal

Q006411

Please Issue Purchase Order to:
Exerplay, Inc
PO Box 1160, Cedar Crest, NM 87008
fax to 505-281-0155

Proposal Date	Salesperson
12/17/2024	Ether Wong 725-226-6024 Ether@exerplay.com

Coral Academy-Windmill Campus

Quantity	Item Code	Description	Unit Price	DISC.	Total Extended
		LANDSCAPE STUCTURES, INC.			
1.00	216045C	SkyWays® Cantilever Back-to-Back 40'x72' Shade 12' Entrance Height 1	55,825.00		55,825.00
1.00	FREIGHT	Freight/shipping charges (150-24-1541)	5,148.00		5,148.00
1.00	RI-INSTALL	Install 40' x 72' Double Sided Cantilever Shade (121824)	24,592.00		24,592.00
1.00	PERMITSFEES	Permits & Fees (121824)	4,200.00		4,200.00
1.00	RI-INSTALL	Artificial Turf Patching (121824)	1,200.00		1,200.00

THIS PROPOSAL IS SUBJECT TO THE ATTACHED TERMS AND CONDITIONS

Taxes subject to change

Proposal prepared by: Jeri Call

Subtotal	90,965.00
Tax Total:	0.00
Total	90,965.00

Accepted by:

Print Name: _____ Signature: _____ Date: _____



Proposal

Q006411

General Terms and Conditions:

Pricing for all listed items is good for 30 days from date of quote. ExerPlay reserves the right to revise pricing if any quote approvals are received after the 30-day timeframe, or if any portion of the quote is changed or removed. This may result in a delay in ordering materials for this project.

Pricing is for the listed items only and unless specifically shown on the quote, does not include freight, installation, engineering, offloading, storage, security, site preparation, permitting, security/temporary fencing, hard dig conditions, saw cutting, core drilling, field painting, electrical, concrete slabs, masonry work, ABC compaction, curbing, hand digging, excavation, spoil & waste removal, certification classes, background checks/badging, private line locating, or any applicable taxes or bonds. To obtain a performance/payment bond, please add 3.5% of the total to this quote.

Any necessary permits (federal, state, and/or local building) or special inspections are the responsibility of the General Contractor or End Owner.

Any applicable taxes shown on the quote are calculated based on state, city or county rates and project-specific requirements. Any Requests to remove taxes are subject to approval and MUST include an applicable tax-exempt certificate.

Please provide a signed quote, Purchase Order, or Contract to request an order. Further information such as shipping, colors, contact info, etc., may be needed before an order can be placed. Contract terms are subject to review and approval.

Notwithstanding anything to the contrary in any Contract Documents, ExerPlay shall have no duty to defend or indemnify Owner, Customer, or any other party for that portion of any claim arising out of the sole negligence of the indemnified party.

Billing and Payment Terms:

Current Customers: Unless otherwise negotiated and agreed upon, ExerPlay's payment terms are Net 30 from the date of the invoice, with approved credit; and Net 45 for contracted projects. ExerPlay's process is to bill the customer when the equipment ships. Surfacing and installation are billed upon completion. Bonds are billed when ordered. Late payments may be subject to finance fees and/or legal action.

New Customers: New customers may be required to pay a deposit on equipment at time of order. Deposit amount to be determined, based on credit. The remainder of that equipment, including freight, will be billed when it ships. Surfacing and installation are billed upon completion. Bonds are billed when ordered.

If paying by credit card, there will be a 3.5% fee added to the invoice.



Proposal

Q006411

Installation Terms:

If installation is included on the quote, the following guidelines must be followed:

1. It is recommended that any Landscape Structures Equipment be installed by a certified Landscape Structures installer, and that all other equipment be installed by a CPSI Certified installer. ExerPlay reserves the right to request proof of certification.
2. Playground equipment MUST be installed over ADA compliant wood fiber or rubber surfacing. This area is not ADA compliant without surfacing and an accessible route up to and into the playground area. Please contact us for more information.
3. Installation price does NOT include prevailing wages, Davis–Bacon wages, or TERO wages unless otherwise specified. Any changes in wage requirements at time of order are subject to updated pricing.
4. Installation price is based on normal soil conditions. Unusual or hard dig soil conditions that require the use of a jack hammer, or other such equipment, will incur additional charges by reason of such conditions and supervisory fee, and for an extension of the time of completion. Installation price does not include removal of anything which may hinder installation of equipment, unless otherwise specified on our quote.
5. If Hard Dig conditions are known, please advise so we can quote accordingly to avoid any delays or additional fees. Hard Dig conditions will be considered anything that cannot be excavated with a standard Bobcat mounted hydraulic auger. Hard Dig conditions will require a change order at a Time & Material rate. If an auger truck is required to complete digging, it will be at the expense of the General Contractor or Owner, if a spoil report is not provided at the time of quoting.
6. Finish grade is to be provided by others prior to arrival of installer.
7. Installer must have free and clear access to the install location(s). The installer is not responsible for damage done to existing surfacing/landscaping that may occur when equipment & vehicles are being used in the normal course of construction. Reasonable access to the job site for a Bobcat is assumed as a part of this quote.
8. Line–item pricing is for informational purposes only and is based upon being awarded the total project. All items are to be installed concurrently if specific areas are not ready for installation, and an additional mobilization fee will be required via Change order unless otherwise specified on the quote.
9. If any materials need to be unloaded on site by the installer, unloading must be coordinated at the same time as the installation. If special arrangements need to be made, an additional trip charge for unloading may apply.
10. Our installation team will call 811 to conduct a line location service; however, often–times they do not mark lines on the actual property where the installation will be done. The owner is responsible for blue–staking the job site and staking out any underground utilities prior to installation. Owner is responsible should damage occur.
11. Neither ExerPlay nor Installers are responsible for vandalism, theft of equipment or subsequent repairs or replacement. Security fencing can be provided upon request and added to the quote.
12. The job site MUST be ready, and area leveled, when the installer arrives to begin the job, unless specifically noted on the quote. Any downtime or site delays caused by Owner or General Contractor will incur additional fees.
13. If equipment is to be shipped to the installer's yard, it will be held for a maximum of 6 months from delivery, with intent to install in that time frame; otherwise, storage fees may occur.

General Contractor is responsible for:

1. Adequate storage and layout area as well as security of equipment while on site.
2. Water, power, sanitary facilities, and trash container on site.
3. Free and clear vehicle access to site and all areas under the scope of work.
4. Movement of any utilities conflicting with the installation of the equipment (installer is not responsible for landscape irrigation).
5. Once the installers are on site, any delays or additional work incurred by the installation crew and caused by others (owners or other contractors) will be charged on a cost-plus basis.
6. Any additional costs, i.e. demolition, relocation, excavation, surfacing materials, and labor due to abnormal soil conditions, are not included in price.
7. Please notify ExerPlay of any changes immediately. If any changes are made which we are not aware of, and which alter the installation, then all additional costs will be passed on to the GC.

Sonntag Recreation LLC

QUOTE #1240

DATE: JANUARY 8, 2025

4245 Panorama Cir, Salt Lake City, UT 84124
Phone 801-278-9797 Fax 801-278-9794
jwebb@sonntagrec.com

EXPIRATION DATE 12/31/25

TO **Coral Academy –
Windmill Campus
Anthony Vu**

SALESPERSON	JOB	PAYMENT TERMS	LEAD TIME
Jeremiah		NET 30	<u>10-12 weeks</u>

PART #	DESCRIPTION	UNIT PRICE	LINE TOTAL
216045C	LANDSCAPE STRUCTURES, INC. SkyWays® Cantilever Back-to-Back 40'x72' Shade 12' Entrance Height 1		\$56,600.00
Install	Install 40' x 72' Double Sided Cantilever Shade (121824)		\$28,400.00
MISC	Permits & Fees (121724)		\$4,500.00
MISC	Artificial Turf Patching (121824)		\$2,500.00
SUBTOTAL			\$92,000.00
FREIGHT			\$5,200.00
TOTAL			\$97,200.00

Quotation prepared by: Jeremiah Webb _____

This is a quotation on the goods named, subject to the conditions noted below: (Describe any conditions pertaining to these prices and any additional terms of the agreement. You may want to include contingencies that will affect the quotation.)

To accept this quotation, sign here and return: _____

THANK YOU FOR YOUR BUSINESS!

TERMS AND CONDITIONS

- This Sonntag Recreation quotation becomes a Sales Agreement and contract only upon receipt by Seller of the signed copy by fax, mail or email prior to the expiration date of the quotation and upon receipt of the required deposit. Cancellation of the Sales Agreement or any returns is only upon approval and may not be possible depending upon the manufacturer and on the time frame of the order and manufacturing.
- Once the job has arrived, balance of the invoice is due per the terms of the agreement. All payments for the equipment are due at the Seller's address in Salt Lake City, Utah as shown above. A finance charge of 1.5% per month will be charged on any unpaid balance which becomes past due. Buyer agrees to pay reasonable attorney fees and collection expenses for the collection of any balance due under the agreement.
- Sales tax will be charged on all invoices unless the Seller is provided a Tax Exemption Certificate when placing the order or before the invoice date.
- This agreement constitutes the final, complete and exclusive statement of the contract between the Seller and the Buyer and supersedes all prior written and oral communications. No person is authorized by the Seller to make any additional or different representation, promises or warranties. Any changes to this Sales Agreement will be by Change Order upon agreement by both parties.
- Manufacturer's warranties apply on products Delivered and the Seller's sole warranty is that the products delivered shall be in conformity with the description above. The Seller expressly disclaims all implied warranties, including warranties of merchantability or fitness for a particular purpose.
- Seller shall not be in breach of this agreement in the event of nonperformance occasioned by strikes, lockouts, accidents, fires, delays in production or acquisition of supplies, delays by carriers, acts of God, government actions, state of war, civil unrest or other causes beyond control of the seller. Buyer may not assign its rights or duties under this Agreement without Seller's prior written consent.

January 14, 2025

Via email: avu@coralacademy.org

Anthony Vu
Coral Academy



RE: Coral Academy Windmill Proposal

Dear Anthony:

We, **Robertson Installations LLC**, wish to provide you with this proposal for the shade/playground installation work outlined below for the above referenced project. All work is to be performed in accordance with Plans and Specifications, unless noted otherwise.

Furnish 40' x 72' Cantilever Shade..... \$118,863

SCOPE OF WORK:

A. Install & Furnish

1. Concrete, Rebar, & Erection

EXCLUSIONS:

A. Areas of Work

1. Additional Backfill, Installing Earth Subgrade, Compaction. Subbase.
2. Demolition, Landscaping, Sitework, Curbing, Sidewalks, Grading, **No Security, No Construction Fence.**
3. Waterproofing, Steel Welding, Bid Bonds. Permitting. Prevailing Wages.

QUALIFICATIONS:

1. Area is assumed to be easily accessible by vehicle and/or equipment.
2. Proposal is valid for 60 days.
3. Not responsible for damage to existing landscaping/finish work in course of installing equipment.
4. Job will be performed in **one mobilization**. Additional charges may occur if multiple mobilizations are required.

Respectfully,

ROBERTSON INSTALLATIONS LLC

A handwritten signature in black ink, appearing to read 'Brian Robertson', is written over a light blue background.

Brian Robertson
702-908-0990



NOTE:
DESIGN ASSUMES THAT THE
SITE IS LEVEL, OR DOES NOT
EXCEED A 2% GRADE CHANGE
OVER THE ENTIRE AREA.

GOOGLE EARTH TRACE
ACTUAL SITE
DIMENSIONS MUST BE
VERIFIED.

Freestanding Play
(5-12 years)
Max Fall Height: 0 inches

216045
SKYWAYS
40'x12' CANILEVER
W/12' ENTRANCE
NOTE: PLEASE SEE QUOTATION FOR SPECIAL SKYWAYS NOTES
NOTE: THE SKYWAYS CANILEVER IS NOT IPEMA CERTIFIED

TOTAL ELEVATED PLAY COMPONENTS	0		
TOTAL ELEVATED COMPONENTS ACCESSIBLE BY RAMP	0	REQUIRED	0
TOTAL ELEVATED COMPONENTS ACCESSIBLE BY TRANSFER	0	REQUIRED	0
TOTAL ACCESSIBLE GROUND LEVEL COMPONENTS SHOWN	0	REQUIRED	0
TOTAL DIFFERENT TYPES OF GROUND LEVEL COMPONENTS	0	REQUIRED	0

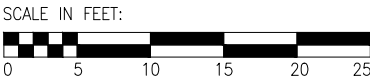

Coral Academy
Windmill Campus Shade
Headerson, NV

ExerPlay, Inc.
Ether Wong

SYSTEM TYPE:
Freestanding

DRAWING #:
003578A



The play components identified on this plan are IPEMA certified. (Unless model number is preceded with *) The use and layout of these components conform to the requirements of ASTM F1487.

THIS PLAY AREA & EQUIPMENT IS
DESIGNED FOR AGES YEARS
UNLESS OTHERWISE NOTED ON PLAN.

IT IS THE MANUFACTURERS OPINION THAT
THIS PLAY AREA DOES CONFORM TO
THE A.D.A. ACCESSIBILITY STANDARDS,
ASSUMING AN ACCESSIBLE PROTECTIVE
SURFACING IS PROVIDED, AS INDICATED, OR
WITHIN THE ENTIRE USE ZONE.

THIS CONCEPTUAL PLAN WAS BASED ON
INFORMATION AVAILABLE TO US. PRIOR TO
CONSTRUCTION, DETAILED SITE INFORMATION
INCLUDING SITE DIMENSIONS, TOPOGRAPHY
EXISTING UTILITIES, SOIL CONDITIONS, AND
DRAINAGE SOLUTIONS SHOULD BE OBTAINED,
EVALUATED, & UTILIZED IN THE FINAL DESIGN.
PLEASE VERIFY ALL DIMENSIONS OF PLAY
AREA, SIZE, ORIENTATION, AND LOCATION OF
ALL EXISTING UTILITIES, EQUIPMENT, AND
SITE FURNISHINGS PRIOR TO ORDERING.
SLIDES SHOULD NOT
FACE THE HOT AFTERNOON SUN.

CHOOSE A PROTECTIVE SURFACING MATERIAL
THAT HAS A CRITICAL HEIGHT VALUE TO MEET
THE MAXIMUM FALL HEIGHT FOR THE
EQUIPMENT (REF. ASTM F1487 STANDARD
CONSUMER SAFETY PERFORMANCE SPECIFICATION
FOR PLAYGROUND EQUIPMENT FOR PUBLIC
USE, SECTION 8 CURRENT REVISION).

DESIGNED BY:
KB

COPYRIGHT: 12/16/24
EXERPLAY, INC.

12220 N HWY 14 Suite 1
CEDAR CREST, NM 87008
PH: 1-800-457-5444 FAX: 1-505-281-0155

Date	Previous Drawing #	Initials

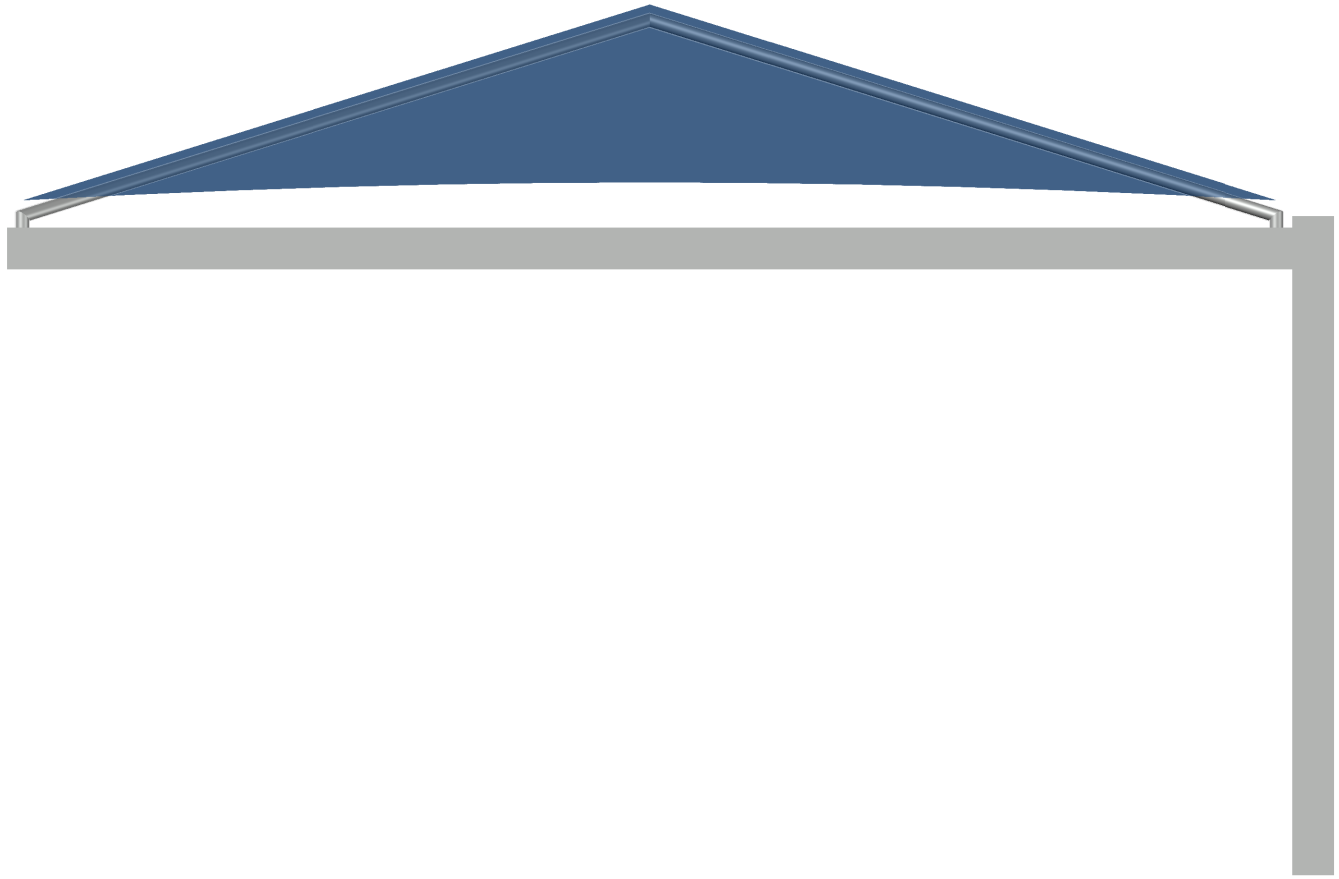
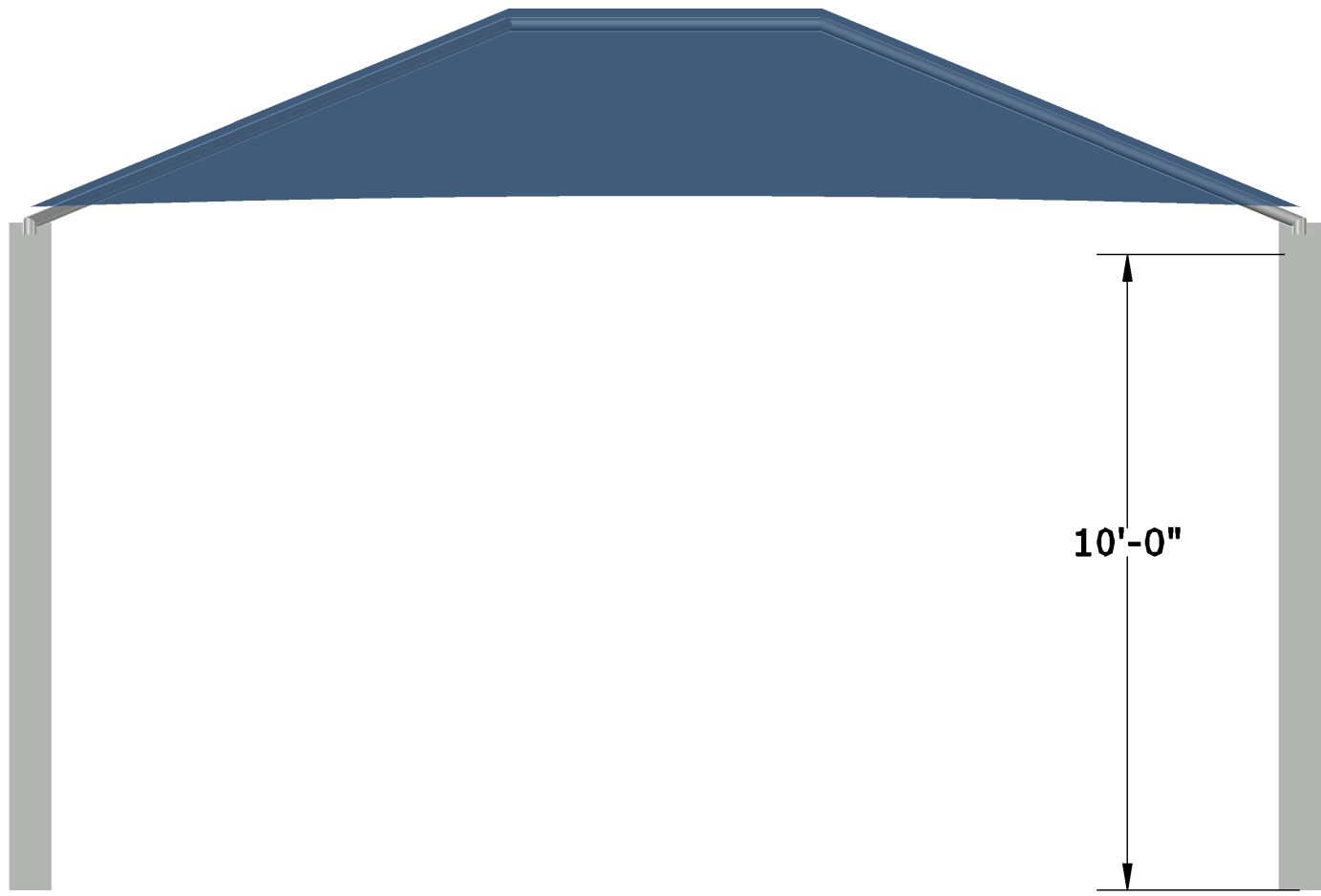
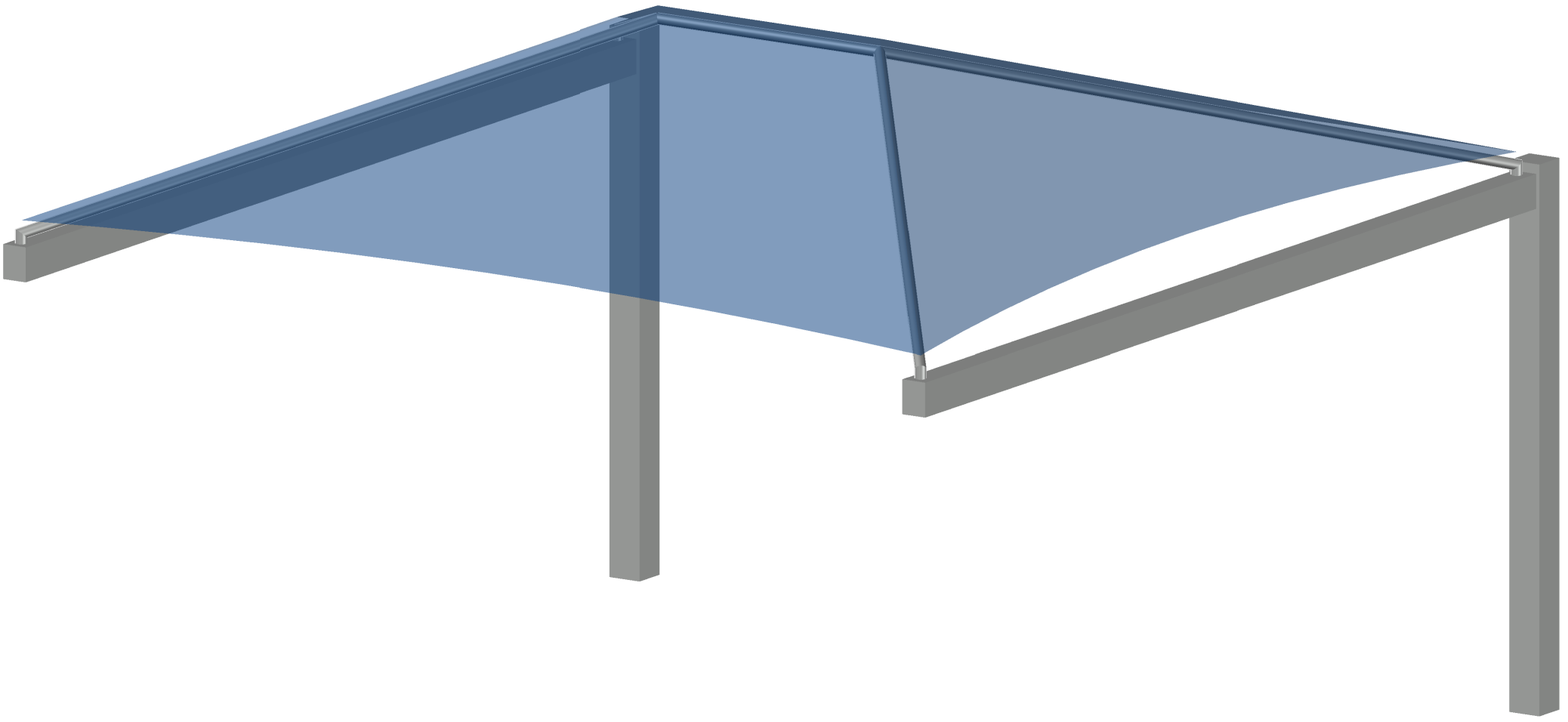
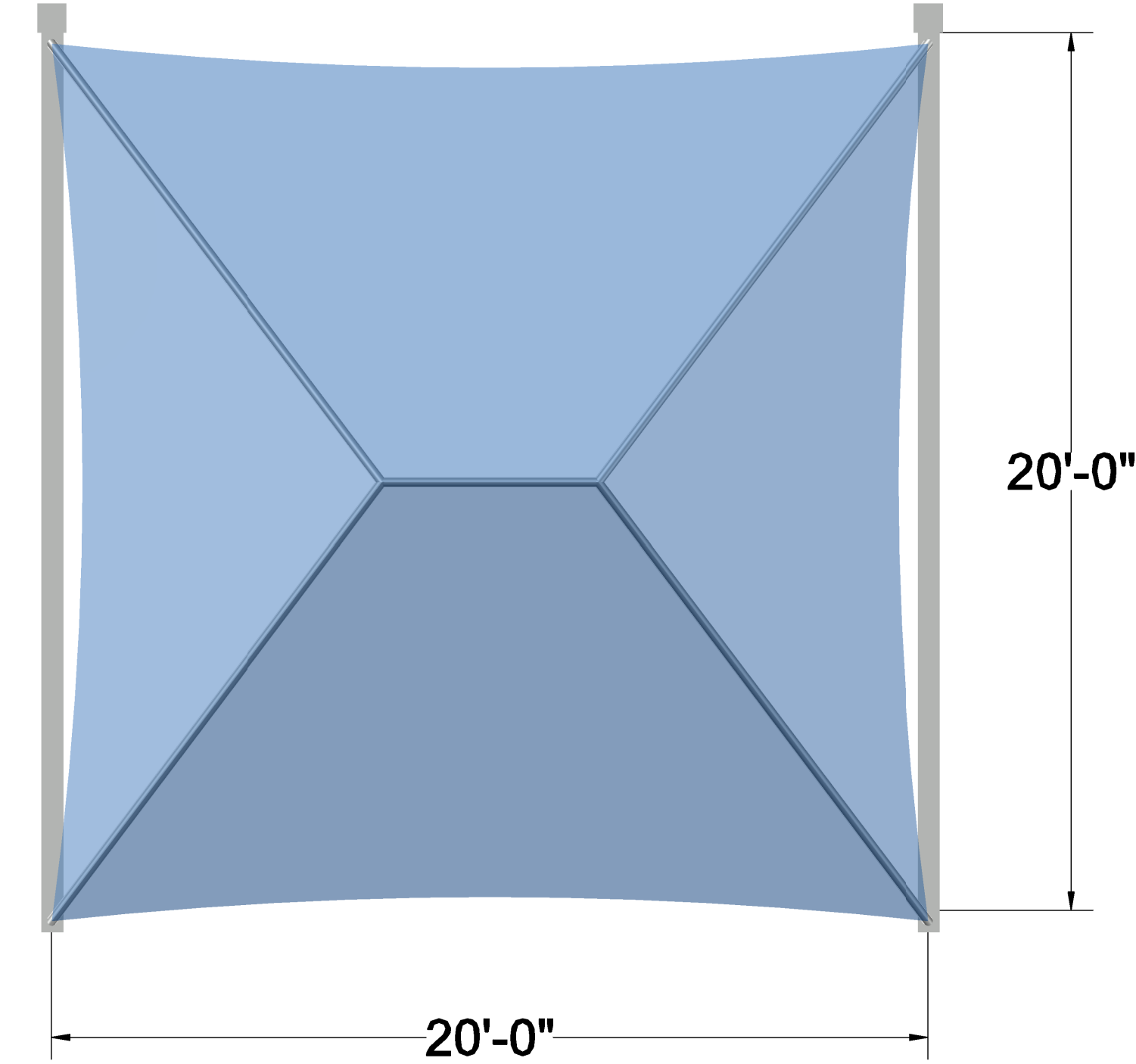

SKYWAYS
by LANDSCAPE STRUCTURES

8131 FORNEY RD.
DALLAS, TEXAS 75227
PH: 1-888-438-6574

Project Info:

Coral Academy of Science -
Sandy Ridge Campus Shade

Location:

Henderson, NV

Unit Type:

SkyWays Cantilever Hip

Designed By:

JDS

Sheet Size:

"D" 34" x 22"

SKYWAYS
by LANDSCAPE STRUCTURES

8131 FORNEY RD.
DALLAS, TEXAS 75227
PH: 1-888-438-6574

Date 01/16/2025

IF ANY DESIGN INFORMATION IS MISSING OR TBD, A FINAL DESIGN
DRAWING CANNOT BE CREATED. ALL DESIGN INFORMATION IS
REQUIRED FOR A FINAL DESIGN DRAWING AND ORDER SUBMISSION

Image for illustrative purposes only. Does not represent the finished product. Not to scale. Not for construction.
©2024 Landscape Structures. All Rights Reserved.

NOTES:		SELECTED OPTIONS:			REQUIRED DESIGN INFORMATION FOR FINAL DESIGN			QUOTE #	CUSTOM PRODUCT NUMBER:							
		<table><tr><td>Templates</td><td>QTY</td><td>2</td></tr><tr><td>Electronic Stamps</td><td>QTY</td><td>1</td></tr></table>			Templates	QTY	2	Electronic Stamps	QTY	1	WIND LOAD: 105 MPH	STEEL COLOR: TBD	FOUNDATION TYPE:Drilled Pier	TEMPLATES:Yes	1192502-01-02	CP042737
					Templates	QTY	2									
					Electronic Stamps	QTY	1									
					SNOW LOAD: 5 PSF	FABRIC COLOR: TBD	BURY TYPE: Recessed Base Plate	WET SEALS:No								
BUILDING CODE: IBC 2021	RAPID RELEASE: No	SURFACING: 4"	ELECTRONIC SEALS: QTY (1)													

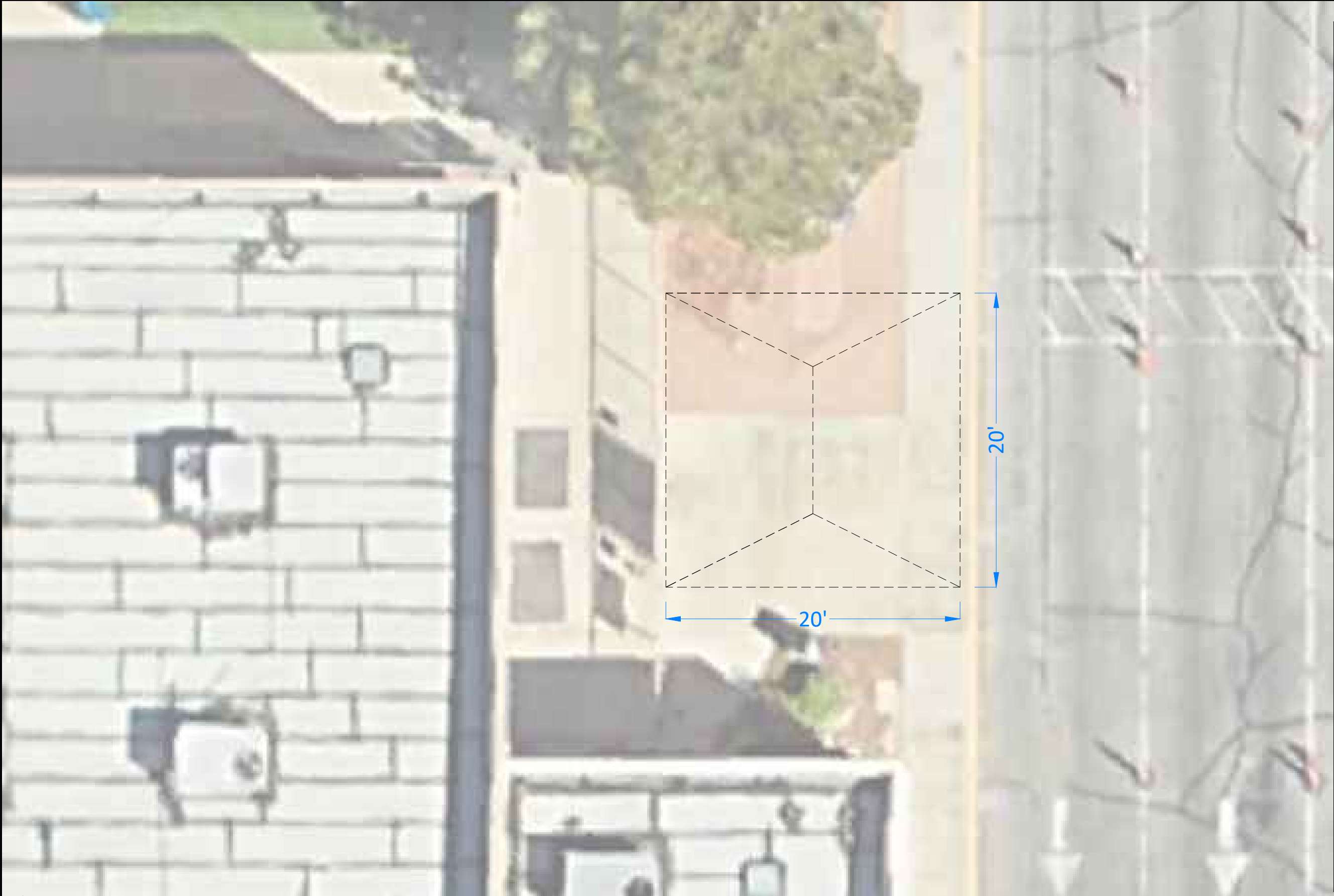

IT IS THE MANUFACTURERS OPINION AND INTENT THAT THE USE AND LAYOUT OF THESE COMPONENTS CONFORM WITH THE AMERICAN SOCIETY FOR TESTING AND MATERIALS (ASTM) STANDARD ASTM F1487

THIS PLAY AREA & EQUIPMENT IS DESIGNED FOR AGES YEARS UNLESS OTHERWISE NOTED ON PLAN.

THIS CONCEPTUAL PLAN WAS BASED ON INFORMATION AVAILABLE TO US. PRIOR TO CONSTRUCTION, DETAILED SITE INFORMATION INCLUDING SITE DIMENSIONS, TOPOGRAPHY EXISTING UTILITIES, SOIL CONDITIONS, AND DRAINAGE SOLUTIONS SHOULD BE OBTAINED, EVALUATED, & UTILIZED IN THE FINAL DESIGN. PLEASE VERIFY ALL DIMENSIONS OF PLAY AREA, SIZE, ORIENTATION, AND LOCATION OF ALL EXISTING UTILITIES, EQUIPMENT, AND SITE FURNISHINGS PRIOR TO ORDERING. SLIDES SHOULD NOT FACE THE HOT AFTERNOON SUN.

CHOOSE A PROTECTIVE SURFACING MATERIAL THAT HAS A CRITICAL HEIGHT VALUE TO MEET THE MAXIMUM FALL HEIGHT FOR THE EQUIPMENT (REF. ASTM F1487 STANDARD CONSUMER SAFETY PERFORMANCE SPECIFICATION FOR PLAYGROUND EQUIPMENT FOR PUBLIC USE, SECTION 8 CURRENT REVISION).

DESIGNED BY:

KB

COPYRIGHT: 1/23/25
EXERPLAY, INC.

12220 N HWY 14 Suite 1
CEDAR CREST, NM 87008
PH: 1-800-457-5444 FAX: 1-505-281-0155

12/23/24	192502-01-01	KB
Date	Previous Drawing #	Initials

SCALE IN FEET:

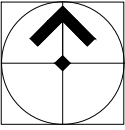

NORTH

Coral Academy of Science
Sandy Ridge Campus Shade
Henderson, NV

ExerPlay, Inc.
Ether Wong

SYSTEM TYPE:
Freestanding

DRAWING #:
1192502-01-02



Summary & Recommendation

Exerplay: \$47,086.00

Robertson Installations: \$51,770.00

Sonntag Recreation: \$50,050.00

Recommendation: Exerplay

Sonntag Recreation LLC

QUOTE #1239-D

DATE: JANUARY 20, 2025

4245 Panorama Cir, Salt Lake City, UT 84124
Phone 801-278-9797 Fax 801-278-9794
jwebb@sonntagrec.com

EXPIRATION DATE 12/31/25

TO Coral Academy of Science -
Sandy Ridge Campus
Anthony Vu

SALESPERSON	JOB	PAYMENT TERMS	LEAD TIME
Jeremiah		NET 30	10-12 weeks

PART #	DESCRIPTION	UNIT PRICE	LINE TOTAL
CP042482	LANDSCAPE STRUCTURES, INC. ,SkyWays Cantilever Hip 15x20x10 2 Columns + 1		\$19,000.00
CP025496	Engineering Services		\$1,200.00
Install	Install 20' x 15' Cantilever Shade		\$20,500.00
MISC	Permits & Fees (121724)		\$4,500.00
MISC	Concrete Patching		\$650.00
SUBTOTAL			\$45,850.00
FREIGHT			\$4,200.00
TOTAL			\$50,050.00

Quotation prepared by: Jeremiah Webb

This is a quotation on the goods named, subject to the conditions noted below: (Describe any conditions pertaining to these prices and any additional terms of the agreement. You may want to include contingencies that will affect the quotation.)

To accept this quotation, sign here and return:

THANK YOU FOR YOUR BUSINESS!

TERMS AND CONDITIONS

- This Sonntag Recreation quotation becomes a Sales Agreement and contract only upon receipt by Seller of the signed copy by fax, mail or email prior to the expiration date of the quotation and upon receipt of the required deposit. Cancellation of the Sales Agreement or any returns is only upon approval and may not be possible depending upon the manufacturer and on the time frame of the order and manufacturing.
- Once the job has arrived, balance of the invoice is due per the terms of the agreement. All payments for the equipment are due at the Seller's address in Salt Lake City, Utah as shown above. A finance charge of 1.5% per month will be charged on any unpaid balance which becomes past due. Buyer agrees to pay reasonable attorney fees and collection expenses for the collection of any balance due under the agreement.
- Sales tax will be charged on all invoices unless the Seller is provided a Tax Exemption Certificate when placing the order or before the invoice date.
- This agreement constitutes the final, complete and exclusive statement of the contract between the Seller and the Buyer and supersedes all prior written and oral communications. No person is authorized by the Seller to make any additional or different representation, promises or warranties. Any changes to this Sales Agreement will be by Change Order upon agreement by both parties.
- Manufacturer's warranties apply on products Delivered and the Seller's sole warranty is that the products delivered shall be in conformity with the description above. The Seller expressly disclaims all implied warranties, including warranties of merchantability or fitness for a particular purpose.
- Seller shall not be in breach of this agreement in the event of nonperformance occasioned by strikes, lockouts, accidents, fires, delays in production or acquisition of supplies, delays by carriers, acts of God, government actions, state of war, civil unrest or other causes beyond control of the seller. Buyer may not assign its rights or duties under this Agreement without Seller's prior written consent.

January 14, 2025

Via email: avu@coralacademylv.org

Anthony Vu
Coral Academy Sandy Ridge



RE: Coral Academy Sandy Ridge Proposal

Dear Anthony:

We, **Robertson Installations LLC**, wish to provide you with this proposal for the shade/playground installation work outlined below for the above referenced project. All work is to be performed in accordance with Plans and Specifications, unless noted otherwise.

Furnish 20' x 20' Cantilever Shade..... \$51,770

SCOPE OF WORK:

A. Install & Furnish

1. Concrete, Rebar, & Erection

EXCLUSIONS:

A. Areas of Work

1. Additional Backfill, Installing Earth Subgrade, Compaction. Subbase.
2. Demolition, Landscaping, Sitework, Curbing, Sidewalks, Grading, **No Security, No Construction Fence.**
3. Waterproofing, Steel Welding, Bid Bonds. Permitting. Prevailing Wages.

QUALIFICATIONS:

1. Area is assumed to be easily accessible by vehicle and/or equipment.
2. Proposal is valid for 60 days.
3. Not responsible for damage to existing landscaping/finish work in course of installing equipment.
4. Job will be performed in **one mobilization**. Additional charges may occur if multiple mobilizations are required.

Respectfully,

ROBERTSON INSTALLATIONS LLC

A handwritten signature in black ink, appearing to read 'Brian Robertson', is written over a light blue background.

Brian Robertson
702-908-0990





Proposal

Q006930

Please Issue Purchase Order to:
Exerplay, Inc
PO Box 1160, Cedar Crest, NM 87008
fax to 505-281-0155

Proposal Date	Salesperson
1/21/2025	Ether Wong 725-226-6024 Ether@exerplay.com

Coral Academy of Science - Sandy Ridge Campus

Quantity	Item Code	Description	Unit Price	DISC.	Total Extended
		LANDSCAPE STRUCTURES, INC.			
1.00	LSI	CP042737, SkyWays Cantilever Hip 20x20x10 2 Columns + 1 HDPE Top / 20' x 20' x 10' Entry	18,185.00		18,185.00
1.00	FREIGHT	Freight/shipping charges (150-25-62)	3,874.00		3,874.00
1.00	ENGINEERING	CP025496, Engineering Services	1,063.00		1,063.00
1.00	RI-INSTALL	Install 20' x 20' Cantilever Shade (011725)	19,164.00		19,164.00
1.00	PERMITSFEES	Permits & Fees (011725)	4,200.00		4,200.00
1.00	RI-INSTALL	Concrete Patching (011725)	600.00		600.00

THIS PROPOSAL IS SUBJECT TO THE ATTACHED TERMS AND CONDITIONS

Taxes subject to change

Proposal prepared by: Jeri Call

Subtotal	47,086.00
Tax Total:	0.00
Total	47,086.00

Accepted by:

Print Name: _____ Signature: _____ Date: _____

P.O. BOX 1160 Cedar Crest, NM 87008

1-800-457-5444

Exerplay.com

Fax 505-281-0155



Proposal

Q006930

General Terms and Conditions:

Pricing for all listed items is good for 30 days from date of quote. ExerPlay reserves the right to revise pricing if any quote approvals are received after the 30-day timeframe, or if any portion of the quote is changed or removed. This may result in a delay in ordering materials for this project.

Pricing is for the listed items only and unless specifically shown on the quote, does not include freight, installation, engineering, offloading, storage, security, site preparation, permitting, security/temporary fencing, hard dig conditions, saw cutting, core drilling, field painting, electrical, concrete slabs, masonry work, ABC compaction, curbing, hand digging, excavation, spoil & waste removal, certification classes, background checks/badging, private line locating, or any applicable taxes or bonds. To obtain a performance/payment bond, please add 3.5% of the total to this quote.

Any necessary permits (federal, state, and/or local building) or special inspections are the responsibility of the General Contractor or End Owner.

Any applicable taxes shown on the quote are calculated based on state, city or county rates and project-specific requirements. Any Requests to remove taxes are subject to approval and MUST include an applicable tax-exempt certificate.

Please provide a signed quote, Purchase Order, or Contract to request an order. Further information such as shipping, colors, contact info, etc., may be needed before an order can be placed. Contract terms are subject to review and approval.

Notwithstanding anything to the contrary in any Contract Documents, ExerPlay shall have no duty to defend or indemnify Owner, Customer, or any other party for that portion of any claim arising out of the sole negligence of the indemnified party.

Billing and Payment Terms:

Current Customers: Unless otherwise negotiated and agreed upon, ExerPlay's payment terms are Net 30 from the date of the invoice, with approved credit; and Net 45 for contracted projects. ExerPlay's process is to bill the customer when the equipment ships. Surfacing and installation are billed upon completion. Bonds are billed when ordered. Late payments may be subject to finance fees and/or legal action.

New Customers: New customers may be required to pay a deposit on equipment at time of order. Deposit amount to be determined, based on credit. The remainder of that equipment, including freight, will be billed when it ships. Surfacing and installation are billed upon completion. Bonds are billed when ordered.

If paying by credit card, there will be a 3.5% fee added to the invoice.



Proposal

Q006930

Installation Terms:

If installation is included on the quote, the following guidelines must be followed:

1. It is recommended that any Landscape Structures Equipment be installed by a certified Landscape Structures installer, and that all other equipment be installed by a CPSI Certified installer. ExerPlay reserves the right to request proof of certification.
2. Playground equipment MUST be installed over ADA compliant wood fiber or rubber surfacing. This area is not ADA compliant without surfacing and an accessible route up to and into the playground area. Please contact us for more information.
3. Installation price does NOT include prevailing wages, Davis–Bacon wages, or TERO wages unless otherwise specified. Any changes in wage requirements at time of order are subject to updated pricing.
4. Installation price is based on normal soil conditions. Unusual or hard dig soil conditions that require the use of a jack hammer, or other such equipment, will incur additional charges by reason of such conditions and supervisory fee, and for an extension of the time of completion. Installation price does not include removal of anything which may hinder installation of equipment, unless otherwise specified on our quote.
5. If Hard Dig conditions are known, please advise so we can quote accordingly to avoid any delays or additional fees. Hard Dig conditions will be considered anything that cannot be excavated with a standard Bobcat mounted hydraulic auger. Hard Dig conditions will require a change order at a Time & Material rate. If an auger truck is required to complete digging, it will be at the expense of the General Contractor or Owner, if a spoil report is not provided at the time of quoting.
6. Finish grade is to be provided by others prior to arrival of installer.
7. Installer must have free and clear access to the install location(s). The installer is not responsible for damage done to existing surfacing/landscaping that may occur when equipment & vehicles are being used in the normal course of construction. Reasonable access to the job site for a Bobcat is assumed as a part of this quote.
8. Line–item pricing is for informational purposes only and is based upon being awarded the total project. All items are to be installed concurrently if specific areas are not ready for installation, and an additional mobilization fee will be required via Change order unless otherwise specified on the quote.
9. If any materials need to be unloaded on site by the installer, unloading must be coordinated at the same time as the installation. If special arrangements need to be made, an additional trip charge for unloading may apply.
10. Our installation team will call 811 to conduct a line location service; however, often–times they do not mark lines on the actual property where the installation will be done. The owner is responsible for blue–staking the job site and staking out any underground utilities prior to installation. Owner is responsible should damage occur.
11. Neither ExerPlay nor Installers are responsible for vandalism, theft of equipment or subsequent repairs or replacement. Security fencing can be provided upon request and added to the quote.
12. The job site MUST be ready, and area leveled, when the installer arrives to begin the job, unless specifically noted on the quote. Any downtime or site delays caused by Owner or General Contractor will incur additional fees.
13. If equipment is to be shipped to the installer's yard, it will be held for a maximum of 6 months from delivery, with intent to install in that time frame; otherwise, storage fees may occur.

General Contractor is responsible for:

1. Adequate storage and layout area as well as security of equipment while on site.
2. Water, power, sanitary facilities, and trash container on site.
3. Free and clear vehicle access to site and all areas under the scope of work.
4. Movement of any utilities conflicting with the installation of the equipment (installer is not responsible for landscape irrigation).
5. Once the installers are on site, any delays or additional work incurred by the installation crew and caused by others (owners or other contractors) will be charged on a cost-plus basis.
6. Any additional costs, i.e. demolition, relocation, excavation, surfacing materials, and labor due to abnormal soil conditions, are not included in price.
7. Please notify ExerPlay of any changes immediately. If any changes are made which we are not aware of, and which alter the installation, then all additional costs will be passed on to the GC.

Coversheet

Amendment to the Cadence Additional Classroom Construction (For Possible Action)

Section:	II. Discussion & Possible Action Items
Item:	H. Amendment to the Cadence Additional Classroom Construction (For Possible Action)
Purpose:	Vote
Submitted by:	
Related Material:	20250128- Coral Academy Cadence Campus Robotics R2.pdf



SHF INTERNATIONAL
6000 S. Eastern Ave, Suite 14H
Las Vegas, NV 89119
(702) 388-0961

Date: 01/28/25

Project: **Coral Academy Cadence Campus Robotics Lab**
 Project #: **TBD**
 Address: **10 Cadence Crest Ave. Henderson, NV**

Description	Budget
DIVISION 01 - GENERAL REQUIREMENTS	\$ 133,384
DIVISION 02 - EXISTING CONDITIONS	\$ -
DIVISION 03 - CONCRETE	\$ 57,281
DIVISION 04 - MASONRY	\$ 69,973
DIVISION 05 - METALS	\$ 2,000
DIVISION 06 - WOOD & PLASTICS	\$ 51,556
DIVISION 07 - THERMAL & MOISTURE PROTECTION	\$ 25,533
DIVISION 08 - DOORS & WINDOWS	\$ 29,905
DIVISION 09 - FINISHES	\$ 96,110
DIVISION 10 - SPECIALTIES	\$ 550
DIVISION 11 - EQUIPMENT	\$ -
DIVISION 12 - FURNISHINGS, FIXTURES & EQUIPMENT	\$ 4,973
DIVISION 13 - SPECIAL CONSTRUCION	\$ -
DIVISION 14 - CONVEYING SYSTEMS	\$ -
DIVISION 21 - FIRE SUPPRESSION	\$ 15,169
DIVISION 22 - PLUMBING	\$ 70,239
DIVISION 23 - HVAC	\$ 52,001
DIVISION 26 - ELECTRICAL	\$ 132,380
DIVISION 27 - COMMUNICATION	\$ 20,000
DIVISION 28 - ELECTRONIC SAFETY and SECURITY	\$ 39,000
DIVISION 31 - EARTHWORK	\$ 43,900
DIVISION 32 - EXTERIOR IMPROVEMENTS	\$ 7,375
DIVISION 33 - UTILITIES	\$ -
Subtotal	\$ 851,330
Contingency	\$ 4,235
Fee	\$ 77,001
Bond and Liability Ins.	\$ 29,115
Total	\$ 961,681
Clarifications - Civil drawings show all utilities as new. Per sitewalk, all underground utilities are assumed existing for the property. - Some manufacturers have provided specific approval to hold pricing which is only valid for two weeks or until 02/03/2025. - Updated line items are valid for 30 days. - Owner requested project schedule from May 23, 2025 - August 11, 2025 under review and subject to change. - Per owner clarification there will be no students or staff on-site during construction, temporary fencing and safety barriers have been removed.	

Coversheet

Financial Update (Information)

Section:	II. Discussion & Possible Action Items
Item:	I. Financial Update (Information)
Purpose:	FYI
Submitted by:	
Related Material:	CASLV Financials - JAN 25 _Board Report FINAL.pdf



Coral Academy Las Vegas

DMS Monthly Update
Actuals through: January 31, 2025





Revenues - Budget vs YTD Actuals

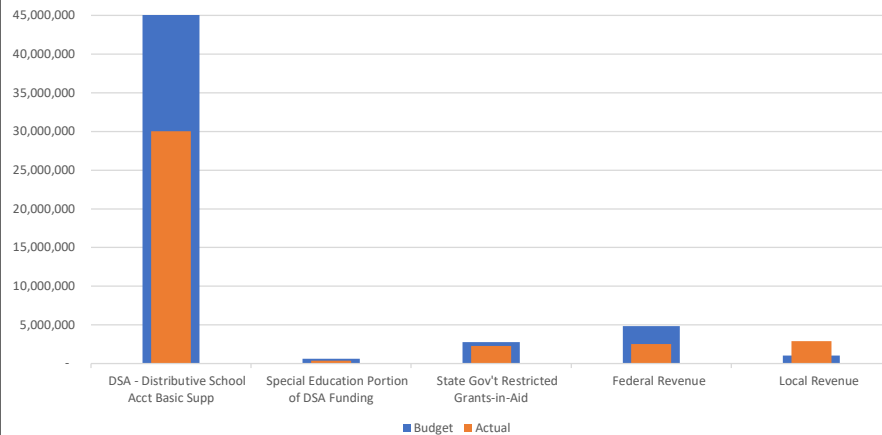

Expenditures - Budget vs YTD Actuals

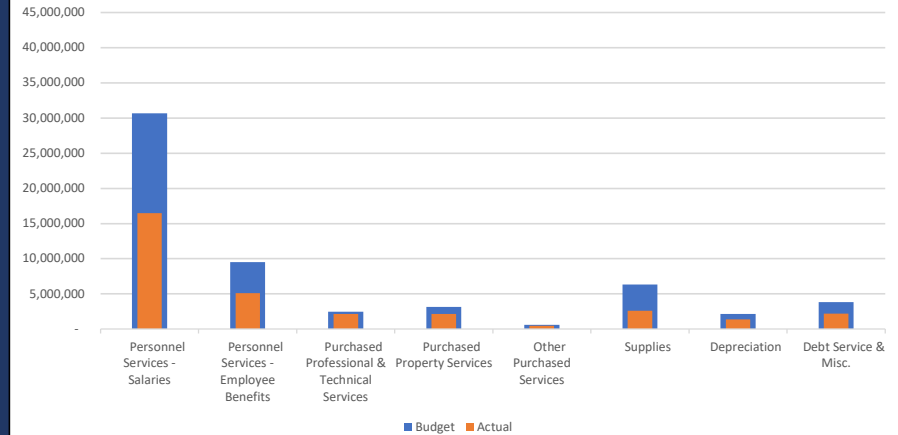

Budget vs Actuals by Category

Revenues	Budget	YTD Actual	% of Budget
DSA - Distributive School Acct Basic Supp	49,517,640	30,017,804	61%
Special Education Portion of DSA Funding	620,880	362,249	58%
State Gov't Restricted Grants-in-Aid	2,766,365	2,270,392	82%
Total DSA Revenue	52,904,885	32,650,445	62%
Federal Revenue	4,832,991	2,531,019	52%
Local Revenue	1,045,000	2,881,649	276%
Total Revenues	58,782,876	38,063,113	65%
Expenditures			
Personnel Services - Salaries	30,673,596	16,499,611	54%
Personnel Services - Employee Benefits	9,515,071	5,108,480	54%
Purchased Professional & Technical Services	2,470,889	2,139,419	87%
Purchased Property Services	3,180,060	2,127,623	67%
Other Purchased Services	599,367	484,579	81%
Supplies	6,359,090	2,592,366	41%
Depreciation	2,152,450	1,380,226	64%
Debt Service & Misc.	3,832,352	2,215,848	58%
Total Expenditures	58,782,876	32,548,152	55%
Net Surplus (Loss)	0	5,514,960	

Days Cash on Hand

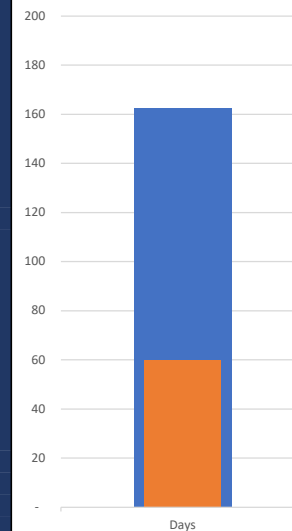

Cash Ratio

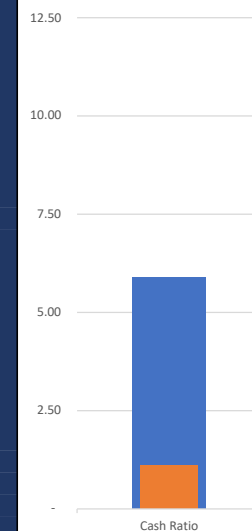

Current Ratio

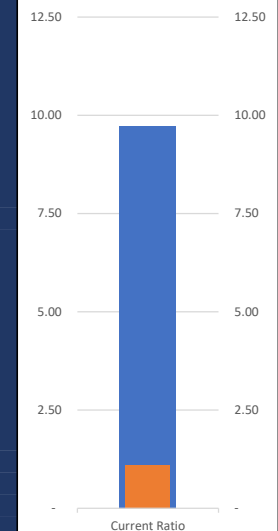



Liquidity

	2019-20	2020-21	2021-22	2022-23	2023-24	Actual
Cash on Hand - Unrestricted	\$12,958,220	\$18,765,662	\$24,854,813	\$24,127,142	\$25,775,814	\$23,486,543
Cash on Hand - Restricted	14,220,191	3,961,486	12,227,068	8,082,635	8,263,455	2,007,215
Days Unrestricted Cash on Hand	172.75	244.60	265.33	169.00	149.00	162.37
Cash Ratio (Unrestricted Cash/current Liab)	9.33	2.85	4.85	3.43	3.46	5.89
Current Ratio (not inclusive of restricted cash)	9.58	3.21	5.63	3.36	3.44	9.73
Debt Service Coverage Ratio		1.63	1.62	1.40	2.07	

<p>Coral Academy of Science Address: 8965 South Eastern Ave, Las Vegas, NV 89123 Website: http://www.caslv.org/ Enrollment: 5407 Grades Served: K-12</p>		2022-23 Fiscal Year: Financial Performance Framework <small>The Financial Performance Framework for charter schools provides a framework within which a charter school authorizer may carry out its oversight roles. See the Technical Guide for details.</small>	
		2022-23	2021-22
		Meets the Standard	Meets the Standard
1. CURRENT RATIO Meets Standard Is the school's Current Ratio at least 1.1?	2. UNRESTRICTED DAYS CASH ON HAND Meets Standard Is the school's UDCOH at least 60 days or 30 days with a positive trend?	3. ENROLLMENT FORECAST ACCURACY Meets Standard Is the school's Enrollment Variance 95% or greater?	4. DEBT DEFAULT Meets Standard Is the school in default of loan covenants or delinquent with debt service payments?
5. TOTAL MARGIN AND AGGREGATE THREE YEAR TOTAL MARGIN Meets Standard Is the school's current year and three year aggregate Total Margin positive?	6. DEBT TO ASSET RATIO Meets Standard Is the school's Debt to Asset Ratio less than 0.90?	7. CASH FLOW Meets Standard Is the school's most recent year and three year aggregate cash flow positive?	8. DEBT OR LEASE SERVICE COVERAGE RATIO Meets Standard Is the school's Debt/Lease Service Coverage Ratio at least 1.10?



Statement of Revenues & Expenditures as of January 31st, 2025

Revenues:	7/1/2024 6/30/2025	Actuals 7/31/2024	Actual 8/31/2024	Actuals 9/30/2024	Actuals 10/31/2024	Actuals 11/30/2024	Actuals 12/31/2024	Actuals 01/31/2025	YTD Total	% of Budget Expended	\$ Amt of Budget Remaining	2/28/2025	3/31/2025	4/30/2025	5/31/2025	6/30/2025	YTD Total
DSA - Distributive School Acct Basic Support/Student	49,517,640	4,158,193	4,158,193	4,158,193	4,674,464	4,287,261	4,287,261	4,294,237	30,017,804	61%	19,499,836	3,899,967	3,899,967	3,899,967	3,899,967	3,899,967	49,517,640.01
Special Education Portion of DSA funding	620,880	51,750	51,750	51,750	51,750	51,750	51,750	51,750	362,249	58%	258,631	51,750	51,750	51,750	51,750	51,631	620,880.00
State Gov't Restricted Grants-in-Aid	2,766,365	95,583	521,549	141,640	95,583	625,566	223,781	566,689	2,270,392	82%	495,973	95,583	95,583	95,583	521,549	95,583	3,174,272.70
Total DSA Revenue	52,904,885	4,305,526	4,731,492	4,351,583	4,821,797	4,964,577	4,562,792	4,912,676	32,650,444.94		20,254,439.93	4,047,300	4,047,300	4,047,300	4,473,266	4,047,181	53,312,792.71
Federal Revenue	4,832,991	-	22,722	113,460	62,901	249,418	1,946,390	136,128	2,531,019	52%	2,301,972	460,394	460,394	460,394	460,394	460,394	4,832,990.87
Local Revenue	1,045,000	160,963	1,105,334	265,874	294,981	679,118	139,382	235,997	2,881,649	276%	(1,836,649)	144,696	144,696	144,696	144,696	144,696	3,605,129.19
Total Revenues	58,782,876	4,466,489	5,839,548	4,730,918	5,179,680	5,893,113	6,648,565	5,284,800	38,063,113	65%	20,719,763	4,652,390.73	4,652,390.73	4,652,390.73	5,078,356.04	4,652,271.29	61,750,912.77
Expenditures:																	
Personnel Services - Salaries	30,673,596	617,963	2,553,524	2,743,166	2,615,548	2,658,380	2,636,130	2,674,900	16,499,611	54%	14,173,985	2,834,797	2,834,797	2,834,797	2,834,797	2,834,797	30,673,596.31
Personnel Services - Employee Benefits	9,515,071	192,572	772,797	807,339	816,421	824,339	811,997	883,016	5,108,480	54%	4,406,591	881,318	881,318	881,318	881,318	881,318	9,515,071.00
Purchased Professional & Technical Services	2,470,889	55,805	139,196	238,906	575,710	353,942	409,918	365,941	2,139,419	87%	331,470	381,000	381,000	381,000	381,000	381,000	4,044,418.88
Purchased Property Services	3,180,060	318,951	268,967	318,673	385,942	207,820	218,045	409,225	2,127,623	67%	1,052,437	210,487	210,487	210,487	210,487	210,487	3,180,060.05
Other Purchased Services	599,367	89,593	70,699	83,038	(10,981)	90,887	104,925	56,417	484,579	81%	114,788	97,906	97,906	97,906	97,906	97,906	974,109.36
Supplies	6,359,090	574,579	398,027	415,902	406,303	296,296	296,444	204,816	2,592,366	41%	3,766,724	753,345	753,345	753,345	753,345	753,345	6,359,090.07
Depreciation	2,152,450	195,672	196,808	191,182	198,773	193,883	201,365	202,544	1,380,226	64%	772,224	154,445	154,445	154,445	154,445	154,445	2,152,449.98
Debt Service & Misc.	3,832,352	305,076	290,370	307,182	353,373	333,284	331,490	297,073	2,215,848	58%	1,616,504	323,301	323,301	323,301	323,301	323,301	3,832,352.25
Total Expenditures	58,782,876	2,350,211	4,690,387	5,105,388	5,339,089	4,958,832	5,010,313	5,093,932	32,548,152	55%	26,234,723	5,636,599	5,636,599	5,636,599	5,636,599	5,636,599	60,731,147.90
									0								-
Net Surplus (Loss)	0	2,116,278	1,149,161	(374,471)	(159,409)	934,281	1,638,252	190,868	5,514,960								1,019,764.87



Balance Sheet
As of January 31st, 2025

ASSETS		As of January 31st, 2025	
<u>Current Assets</u>			
	Cash in Bank - General Checking	23,486,543	9101
	Cash - Restricted	2,007,215	9106-9137, 9111
	Restricted S/T CD's	4,542,303	9160-9163
	Unrestricted S/T CD's	15,326,543	9164
	Total Cash	45,362,605	
	Accounts Receivable	-	
	Prepaid Items	-	
	Total Other Current Assets	-	
	Total Current Assets	45,362,605	
<u>Non-Current Assets</u>			
	Security Deposits	121,120	9191
	Other Noncurrent Assets	33,720	9200-9204
	Total Noncurrent Assets	154,840	
<u>Fixed Assets</u>			
	Fixed Assets	66,201,853	
	Intangible Lease Rights	6,028,166	9280, 9285
	Total Fixed Assets & Intangible Lease Rights	72,230,019	
<u>Other Non-Current Assets</u>			
	Deferred Outflows Pension Contributions	28,866,903	9300
Total Assets		146,614,367	
LIABILITIES			
<u>Current Liabilities</u>			
	Accounts Payable	269,295	
	Book Deposits Payable	495,158	9491
	Lease Liability - Current	1,227,196	9452
	Other Current Liabilities	1,998,090	9481/9442
	Total Current Liabilities	3,989,739	
<u>Long-Term Liabilities</u>			
	General Deferred Lease Obligation	5,192,526	9531
	Bond Liabilities	76,331,862	9511-9520
	Total Long-Term Liabilities	81,524,388	
	Deferred Inflow Pension	54,436,871	9493
	Net Pension Liability	923,356	9467
Total Liabilities		140,874,354	
NET ASSETS			
<u>Beginning Net Assets</u>			
	Beginning Net Assets	225,053	
	Current Net Result	5,514,960	
Net Assets December 2024		5,740,013	
Total Liabilities & Fund Balance		146,614,367	