



# El Camino Real Charter High School

## Finance and Investment Board Committee Meeting

9-17-2025 Finance and Investment Board Committee Meeting

---

### Date and Time

Wednesday September 17, 2025 at 5:30 PM PDT

### Location

El Camino Real Charter High School - (Principal's Conference Room)

5440 Valley Circle Woodland Hills CA 91367

Meeting can also be seen and heard at:

North Campus - 7401 Shoup Ave. West Hills CA 91307

---

The Finance and Investment Committee is a standing committee of the Board of Directors of El Camino Real Alliance.

For committee meeting materials, please go to the school's main office, or call (818) 595-7500. Some board meeting materials are also posted in the school's website (<https://ecrchs.net> - click the ECR Board tab).

### **ATTENTION:**

**WE HAVE RETURNED TO "IN-PERSON" FINANCE AND INVESTMENT COMMITTEE MEETINGS.**

**INSTRUCTIONS FOR PRESENTATIONS TO THE BOARD BY PARENTS AND OTHER MEETING ATTENDEES:**

---

El Camino Real Alliance (“ECRA”) welcomes your participation at ECRA’s Board meetings. The purpose of a public meeting of the Board of Directors (“Board”) is to conduct the affairs of ECRA in public.

**Your participation assures us of continuing community interest in our charter school. To assist you in the ease of speaking/ participating in our meetings, the following guidelines are provided:**

1. Agendas are available to all audience members at the door to the meeting.
2. “Request to Speak” forms are available to all audience members who wish to speak on any agenda items or under the general category of “Public Comments.”

“Public Comments” is set aside for members of the audience to raise issues that are not specifically on the agenda.

However, due to public meeting laws, the Board can only listen to your issue, not respond or take action.

These presentations are limited to **two (2) minutes** and total time allotted to non-agenda items will not exceed thirty (30) minutes. A member of the public who requires the use of a translator, in order to receive the same opportunity as others to directly address the Board, shall be permitted twice the allotted time to speak.

The Board may give direction to staff to respond to your concern or you may be offered the option of returning with a citizen-requested item.

3. You may also complete a “Request to Speak” form to address the Board on Agenda items. With regard to such agenda items, you may specify the item(s) on your “Request to Speak” form and you will be given an opportunity to speak for up to three (3) minutes before the item is addressed, and total time allocated to agenda items will not exceed six (6) minutes for a Discussion item and nine (9) minutes per Vote item.

A member of the public who requires the use of a translator, in order to receive the same opportunity as others to directly address the Board, shall be permitted twice the allotted time to speak, and the total allocated time shall be appropriately increased as well.

4. When addressing the Board, speakers are requested to state their name and adhere to the time limits set forth. In order to maintain allotted time limits, the Board Chair may modify speaker time allocations or the total amount of allotted time for an item.

5. Any public records relating to an agenda item for an Open Session of the Board which are distributed to all, or a majority of all, of the Board members shall be available for public inspection at 5440 Valley Circle Blvd., Woodland Hills, California, 91367.

#### **IMPORTANT NOTE REGARDING PUBLIC COMMENTS:**

---



**Effective September 2022, public comments presentations at all ECRA Regular and Special Board Meetings and Committee Meetings must be made in person.**

**There is no obligation on the part of the school to have a school official read public comments during in-person Board Meetings.**

**A member of the public is welcome to appear at the Board meeting to make a public comment or make arrangements with another person in attendance to speak on the person's behalf.**

**Consent Agenda:** All matters listed under the consent agenda are considered by the Board to be routine and will be approved/enacted by the Board in one motion or more motions in the form listed below. Unless specifically requested by a Board member for further discussion or removed from the agenda, there will be no discussion of these items prior to the Board vote(s) on the Consent Agenda item(s). The Executive Director recommends approval of all consent agenda items.

*In compliance with the Americans with Disabilities Act (ADA) and upon request, El Camino Real Alliance may furnish reasonable auxiliary aids and services to qualified individuals with disabilities. Requests for disability related modifications or accommodations shall be made 24 hours prior to the meeting to David Hussey, in person, by email at [comment@ecrchs.net](mailto:comment@ecrchs.net), or by calling (818) 595-7500.*

### Agenda

	Purpose	Presenter	Time
<b>I. Opening Items</b>			<b>5:30 PM</b>
Opening Items			
<b>A.</b> Call the Meeting to Order		Alexandra Ramirez	1 m
<b>B.</b> Record Attendance and Guests		Ryan Guinto	1 m
<b>C.</b> Pledge of Allegiance to the United States of America (USA)		Alexandra Ramirez	1 m
Mr. Hussey will lead meeting participants in the Pledge of Allegiance to the United States of America (USA).			
<b>D.</b> Public Comments	Discuss	Alexandra Ramirez	30 m
<b>II. Consent</b>			<b>6:03 PM</b>

	Purpose	Presenter	Time
<b>A.</b> Approve Minutes of the June 25, 2025, Finance and Investment Committee Meeting	Approve Minutes	Alexandra Ramirez	1 m
<b>III. Investment</b>			<b>6:04 PM</b>
<b>A.</b> September 2025 Investment Update	Discuss	Fernando Delgado	10 m
Fernando Delgado, CBO, will present the September 2025, Investment Update.			
<b>IV. Finance</b>			<b>6:14 PM</b>
<b>A.</b> 2024-2025 Unaudited Actuals	Vote	Fernando Delgado / Janneyra Verduzco	10 m
Fernando Delgado, CBO, and Janneyra Verduzco, Director, Accounting and Finance, will present the 2024-2025 Unaudited Actuals			
<b>B.</b> Review of August 2025 Check Registers	Vote	Fernando Delgado / Janneyra Verduzco	10 m
Review of August 2025 check registers for the City National Bank Accounts.			
ACTION ITEM: motion to recommend to the Board; approval of the August 2025 Check Registers.			
<b>C.</b> Review of August 2025 Credit Card Charges	Vote	Fernando Delgado / Janneyra Verduzco	10 m
Review the credit card charges for August 2025			
ACTION ITEM: motion to recommend to the Board approval of the August 2025 credit card charges.			
<b>D.</b> Approval of the Arts, Music, & Instructional Materials Block Grant	Vote	Fernando Delgado / Ryan Guinto	15 m
Prior to the vote, Fernando Delgado, CBO and Ryan Guinto, Director of Technology, will present the Approval of the Arts, Music, & Instructional Materials Block Grant and answer any questions			
<b>V. School Business</b>			<b>6:59 PM</b>

	Purpose	Presenter	Time
<b>A.</b> Discussion and Update on Arbiter Pay	Discuss	Fernando Delgado / Janneyra Verduzo	10 m
Prior to the vote, Fernando Delgado, CBO, and Janneyra Verduzco, Director of Accounting and Finance, will present the updates on Arbiter Pay and answer any questions.			
<b>B.</b> Approval for Request to Increase Budget for the Digital Marquee and Front / Corner Monument Project	Vote	Fernando Delgado / Ryan Guinto	15 m
Prior to the vote, Fernando Delgado, CBO, and Ryan Guinto, Director of Technology, will present the Request to Increase Budget for the Digital Marquee and Front / Corner Monument Project and answer any questions.			
<b>VI. Closing Items</b>			<b>7:24 PM</b>
<b>A.</b> Adjourn Meeting	Vote	Alexandra Ramirez	1 m

## Coversheet

### Approve Minutes of the June 25, 2025, Finance and Investment Committee Meeting

**Section:** II. Consent  
**Item:** A. Approve Minutes of the June 25, 2025, Finance and Investment  
Committee Meeting  
**Purpose:** Approve Minutes  
**Submitted by:**  
**Related Material:**  
Minutes for Finance and Investment Board Committee Meeting on June 25, 2025

DRAFT



# El Camino Real Charter High School

## Minutes

### Finance and Investment Board Committee Meeting

June 25, 2025 Finance and Investment Board Committee Meeting

---

#### Date and Time

Wednesday June 25, 2025 at 5:45 PM

#### Location

El Camino Real Charter High School - (Principal's Conference Room)

5440 Valley Circle Woodland Hills CA 91367

Meeting can also be seen and heard at:

North Campus - 7401 Shoup Ave. West Hills CA 91307

---

The Finance and Investment Committee is a standing committee of the Board of Directors of El Camino Real Alliance.

For committee meeting materials, please go to the school's main office, or call (818) 595-7500. Some board meeting materials are also posted in the school's website (<https://ecrchs.net> - click the ECR Board tab).

#### ATTENTION:

**WE HAVE RETURNED TO "IN-PERSON" FINANCE AND INVESTMENT COMMITTEE MEETINGS.**

---

## INSTRUCTIONS FOR PRESENTATIONS TO THE BOARD BY PARENTS AND OTHER MEETING ATTENDEES:

El Camino Real Alliance ("ECRA") welcomes your participation at ECRA's Board meetings. The purpose of a public meeting of the Board of Directors ("Board") is to conduct the affairs of ECRA in public.

**Your participation assures us of continuing community interest in our charter school. To assist you in the ease of speaking/ participating in our meetings, the following guidelines are provided:**

1. Agendas are available to all audience members at the door to the meeting.
2. "Request to Speak" forms are available to all audience members who wish to speak on any agenda items or under the general category of "Public Comments."

"Public Comments" is set aside for members of the audience to raise issues that are not specifically on the agenda.

However, due to public meeting laws, the Board can only listen to your issue, not respond or take action.

These presentations are limited to **two (2) minutes** and total time allotted to non-agenda items will not exceed thirty (30) minutes. A member of the public who requires the use of a translator, in order to receive the same opportunity as others to directly address the Board, shall be permitted twice the allotted time to speak.

The Board may give direction to staff to respond to your concern or you may be offered the option of returning with a citizen-requested item.

3. You may also complete a "Request to Speak" form to address the Board on Agenda items. With regard to such agenda items, you may specify the item(s) on your "Request to Speak" form and you will be given an opportunity to speak for up to three (3) minutes before the item is addressed, and total time allocated to agenda items will not exceed six (6) minutes for a Discussion item and nine (9) minutes per Vote item.

A member of the public who requires the use of a translator, in order to receive the same opportunity as others to directly address the Board, shall be permitted twice the allotted time to speak, and the total allocated time shall be appropriately increased as well.

4. When addressing the Board, speakers are requested to state their name and adhere to the time limits set forth. In order to maintain allotted time limits, the Board Chair may modify speaker time allocations or the total amount of allotted time for an item.

5. Any public records relating to an agenda item for an Open Session of the Board which are distributed to all, or a majority of all, of the Board members shall be available for public inspection at 5440 Valley Circle Blvd., Woodland Hills, California, 91367.

**IMPORTANT NOTE REGARDING PUBLIC COMMENTS:**

**Effective September 2022, public comments presentations at all ECRA Regular and Special Board Meetings and Committee Meetings must be made in person.**

**There is no obligation on the part of the school to have a school official read public comments during in-person Board Meetings.**

**A member of the public is welcome to appear at the Board meeting to make a public comment or make arrangements with another person in attendance to speak on the person's behalf.**

**Consent Agenda:** All matters listed under the consent agenda are considered by the Board to be routine and will be approved/enacted by the Board in one motion or more motions in the form listed below. Unless specifically requested by a Board member for further discussion or removed from the agenda, there will be no discussion of these items prior to the Board vote(s) on the Consent Agenda item(s). The Executive Director recommends approval of all consent agenda items.

*In compliance with the Americans with Disabilities Act (ADA) and upon request, El Camino Real Alliance may furnish reasonable auxiliary aids and services to qualified individuals with disabilities. Requests for disability related modifications or accommodations shall be made 24 hours prior to the meeting to David Hussey, in person, by email at [comment@ecrchs.net](mailto:comment@ecrchs.net), or by calling (818) 595-7500.*

---

**Committee Members Present**

Alexandra Ramirez, Gregg Solkovits, Steven Kofahl

**Committee Members Absent**

None

**Committee Members who arrived after the meeting opened**

Gregg Solkovits

**Guests Present**

David Hussey, Ryan Guinto, Vania Rodriguez

---

**I. Opening Items**

#### A. Call the Meeting to Order

Alexandra Ramirez called a meeting of the Finance and Investment Committee of El Camino Real Charter High School to order on Wednesday Jun 25, 2025 at 5:45 PM.

#### B. Record Attendance and Guests

Gregg Solkovits arrived at 5:57 PM.

#### C. Pledge of Allegiance to the United States of America (USA)

Mr. David Hussey led the Board members and guests in the Pledge of Allegiance to the United States of America (USA).

#### D. Public Comments

No public comments were received for this meeting.

#### E. CBO Report

Mr. Gregory Wood provided a comprehensive update as part of his CBO Report, noting that as the 2024–2025 school year winds down, there has been significant activity across the federal, state, and local levels that impact the district's financial planning.

Mr. Wood reported that the **State of California's budget has been passed by the legislature**, with minimal changes from the Governor's May Revise. Notably, the budget includes **cash deferrals**, but not at the level initially expected. Rather than deferring the entire month of June's funding, only approximately 50% will be deferred into the following month. As a result, the district will not be as significantly impacted as originally anticipated.

He also shared that the **Los Angeles Unified School District (LAUSD) Board approved its \$18.8 billion budget**, which includes a \$3 billion drawdown from reserves to address its deficit for the upcoming year. However, LAUSD's adopted budget does not yet reflect:

- Any adjustments or allocations for expiring labor contracts (e.g., UTLA)
- Anticipated reductions in federal funding
- Potential costs tied to ongoing major sexual abuse claims, which may involve issuance of bonds

In response to questions regarding whether the state budget is final, Mr. Wood clarified that while the **legislature's passage of the budget gives it final authority**, budgets remain flexible and are essentially spending plans. Should revenue projections fall short



or expenses rise unexpectedly, **budgets can be revised at any time**. Likewise, if funding improves, adjustments can also be made to increase budget capacity. He emphasized that:

- The district must adopt a budget based on the best available information at the time.
- If actual funding differs significantly, a **revised budget** may need to be brought to the Board for consideration.
- This includes responding to variables such as **average daily attendance (ADA)**, which directly influences funding levels.
- The administration remains committed to keeping the organization informed of any budget updates throughout the summer and into the new school year.

Finally, Mr. Wood noted that **several additional financial items would be discussed under subsequent agenda items**, including other updates relevant to fiscal planning.

## II. Consent

### A. Approve Minutes of the February 20, 2025 Finance and Investment Board Meeting

Steven Kofahl made a motion to Approve Minutes of the February 20, 2025 Finance and Investment Board Meeting Finance and Investment Board meeting on 02-20-25.

Alexandra Ramirez seconded the motion.

The committee **VOTED** to approve the motion.

#### Roll Call

Steven Kofahl	Aye
Alexandra Ramirez	Aye
Gregg Solkovits	Absent

### B. Approve Minutes of the April 16, 2025, Finance and Investment Committee Meeting

Steven Kofahl made a motion to Approve Minutes of the April 16, 2025, Finance and Investment Committee Meeting Finance and Investment Board meeting on 04-16-25.

Alexandra Ramirez seconded the motion.

The committee **VOTED** to approve the motion.

#### Roll Call

Gregg Solkovits	Absent
Alexandra Ramirez	Aye
Steven Kofahl	Aye

### C. Approve Minutes of the May 14, 2025, Finance and Investment Committee Meeting

Steven Kofahl made a motion to Approve Minutes of the May 14, 2025, Finance and Investment Committee Meeting Finance and Investment Board meeting on 05-14-25.

Alexandra Ramirez seconded the motion.

The committee **VOTED** to approve the motion.

#### Roll Call

Alexandra Ramirez Aye

Steven Kofahl Aye

Gregg Solkovits Absent

### III. Investment

#### A. May 2025 Investment Update

Mr. Gregory Wood presented the Investment Update as of May 2025.

Mr. Wood reported that as of the end of May 2025, the District held approximately **\$40.5 million in total investments**, with:

- **\$32.49 million in the OPEB Trust**
- **\$8.03 million in the General Investment Accounts**

The OPEB Trust began the fiscal year on July 1, 2024, with a balance of **\$30.84 million**. As of May 31, 2025, the District has made **OPEB retiree payments totaling \$581,067**, while investment gains have totaled **\$2.23 million**, representing an investment return of **6.9%**. After accounting for payments and gains, the OPEB Trust experienced a **net increase of 5.3%** year-to-date.

The General Investment Account, which includes holdings managed by Polen Capital, Fiduciary Management, Beacon Pointe, and U.S. Bank, also saw steady performance. The combined general investments reached **\$8.03 million** at the end of May, with a **2.8% return for the month** and a **5.4% year-to-date increase**.

Mr. Wood highlighted that the **District's actuary is currently working with HR** and has received updated health rates to begin their **actuarial review**. A formal OPEB actuarial report will be issued once the fiscal year concludes. Given the performance of the investments and the current funding position, Mr. Wood expressed confidence that the District remains **fully funded**, potentially with a continued surplus, as was the case in the prior year.

Gregg Solkovits made a motion to May 2025 Investment Update.

Alexandra Ramirez seconded the motion.

The committee **VOTED** to approve the motion.

#### Roll Call

Steven Kofahl Aye

Gregg Solkovits Aye

Alexandra Ramirez Aye

## IV. Finance

### A. May 2025 Financial Update

Gregg Solkovits made a motion to Approve the May 2025 Financial Update.

Alexandra Ramirez seconded the motion.

The committee **VOTED** to approve the motion.

#### Roll Call

Steven Kofahl Aye

Alexandra Ramirez Aye

Gregg Solkovits Aye

Mr. Gregory Wood presented the Financial Update as of May 2025.

- The **2024–2025 school year has officially concluded** with all 180 instructional days completed.
- Final **enrollment at year-end** was **2,826 students**, down from **2,945 at the beginning of the year**, and down **236 students year-over-year** compared to the prior year's 3,062.
- The district's **Average Daily Attendance (ADA)** used for funding was **2,687.25**, locked in after Month 8.
- Based on projections, **LCFF funding for 2024–2025 is expected to be approximately \$35.7 million**.
- Despite a **2.3% COLA for 2025–2026**, declining enrollment and ADA are expected to cause a **net funding loss of 1.5%**.
- Preliminary planning for **2025–2026 enrollment** assumes a drop of around **100 students**, based on projected 9th grade enrollment of ~650.
- Caution is urged in budgeting, given public school volatility and the **non-binding nature of student pre-enrollment**.
- Mr. Wood referenced **School Services of California and FCMAT calculators** as reliable tools for financial forecasting.
- **LCFF supplemental funding** based on a 33% free/reduced lunch rate remains a key contributor.
- **Trust fund balances** were reviewed, including a **planned transfer of \$2,048.29** from ASB General to related trust accounts.
- Updates were shared regarding **use of inactive sports program funds (e.g., Aquatics)** to support **student scholarships** via a transparent application process.

#### Additional Note:

- The **LAUSD \$18.8 billion budget** was approved with a **\$3 billion deficit**, relying on reserves without factoring in pending labor negotiations for FY 2025–2026.

### B.

## Discussion and Vote to Recommend to the Full Board Approval of the May 2025, Check Registers

Mr. Wood reviewed the **May 2025 check registers** from the District's **City National Bank accounts**, following the standard format showing check number, payee, amount, and description.

### General Account (Acct. 1761)

- Total disbursements: **\$386,726.59**
- All payments made via **electronic ACH**, primarily for:
  - Retirement plan contributions (403B)
  - SISC health premiums
  - Life insurance premiums
  - LegalShield payroll deductions

### Fundraising Account

- Total disbursements: **\$1,964.94**
- Four checks issued for:
  - Food for events and staff (e.g., Teacher Bagel Day)
  - Reimbursements
  - Refund for SBAC award/Grad Night

### ASB Account

- Total disbursements: **\$140,921.41**

### City National Checking Total for May 2025:

- **\$1,098,260.70**

Mr. Wood noted a continued **transition toward electronic payments (ACH)** for operational efficiency and vendor management. No paper checks were issued for general account expenses.

Gregg Solkovits made a motion to Vote to Recommend to the Full Board Approval of the May 2025, Check Registers.

Alexandra Ramirez seconded the motion.

The committee **VOTED** to approve the motion.

### Roll Call

Gregg Solkovits     Aye  
Steven Kofahl       Aye  
Alexandra Ramirez   Aye

C.

## Discussion and Vote to Recommend to the Full Board Approval of the May 2025, Credit Card Charges.

Gregg Solkovits made a motion to Vote to Recommend to the Full Board Approval of the May 2025, Credit Card Charges.

Steven Kofahl seconded the motion.

The committee **VOTED** to approve the motion.

### Roll Call

Steven Kofahl Aye

Alexandra Ramirez Aye

Gregg Solkovits Aye

Mr. Wood presented the **May 2025 credit card charges**, beginning with a summary view of the **total balance of \$72,049.75** charged for the month.

- The charges were broken down by cardholder as follows:
  - **Mr. David Hussey:** \$48,076.27
  - **Dr. Gregory Wood:** \$23,973.48
- While the summary spreadsheet displayed total amounts, **detailed transaction records** were provided in the attached materials, including:
  - Vendor names
  - Specific expense purposes
  - Charge amounts
- Mr. Wood noted that this level of itemization supports **fiscal transparency and internal accountability**.

## V. School Business

### A. Discussion and Vote to Recommend to the Full Board Approval of the renewal of ECRA Medical Insurance Policy Rates with Self-Insured Schools of California (SISC)

Mr. Wood presented the **renewal of El Camino Real CHS's medical insurance policy with Self-Insured Schools of California (SISC)**, one of the largest school district insurance providers in California and the country.

SISC operates on a **federal fiscal calendar (October 1 start)**, while the school operates on a **June 30 fiscal year**. Therefore, the current rates will continue through the first **three months** of the school year, with **new rates effective October 1**.

### Rate Increases:

- Across most medical plans (HMO, PPO, and Kaiser), a **7–8% increase** is projected over the nine months following October 1.
- **No increase** in premiums for **dental** and **vision** plans.

- A **minor increase of \$2/month (34%)** was noted for life insurance, the first such increase in recent years.

#### Plan Options:

- Employees are offered a **composite rate** plan (same cost regardless of family size), with coverage options including:
  - **Anthem Blue Cross** (PPO – high and low coverage options)
  - **Kaiser Permanente**
  - **CaliforniaCare HMO**
- The **District covers the full cost of the "low" option** for employees and their eligible dependents.
- Employees opting for the “high” coverage option are responsible for the difference via **payroll deduction** (e.g., **~\$3,000 annually** for upgraded Blue Cross coverage).

#### Medicare Considerations:

- For **active employees eligible for Medicare** (age 65+), there is **no impact on composite rate costs**.
- Medicare coordination applies more meaningfully in retirement.

#### Overall Impact:

- Due to a slight projected decrease in total covered employees (~0.20 FTE fewer), the **overall school cost increase** is expected to remain near **5%** despite the 8% rate increase over nine months.
- Mr. Wood recommended approving the renewal **despite rate increases**, citing that the trends are in line with the broader **medical insurance market**.

Gregg Solkovits made a motion to Vote to Recommend to the Full Board Approval of the renewal of ECRA Medical Insurance Policy Rates with Self-Insured Schools of California (SISC).

Steven Kofahl seconded the motion.

The committee **VOTED** to approve the motion.

#### Roll Call

Alexandra Ramirez	Aye
Gregg Solkovits	Aye
Steven Kofahl	Aye

### B. Discussion and Vote to recommend to the full board the 2025-2026 Piece of Mind Special Education Services Contract

Ms. Emilie Larew presented the **2025–2026 contract renewal** for *Peace of Mind*, a **non-public agency (NPA)** that provides specialized services in support of students with disabilities.

- A **rate comparison chart** was provided to the Board, consistent with prior years, offering a comparative analysis of rates charged by multiple NPAs for special education services. Ms. Larew noted:
  - Larger agencies often maintain **non-negotiable rates**.
  - Smaller agencies may allow for **negotiation on both rates and minimum hour requirements**, allowing the school to secure cost-effective and compliant services.
- Services provided by Peace of Mind include:
  - **Behavior Support Planning**
  - **One-on-One Behavioral Aides**
  - **Vision Intervention (VII and VIB)**
  - **Supplemental Academic Instruction (SAI)**
- Ms. Larew explained that while **some rates have increased** for the upcoming year (notably behavior services), **VII and SAI rates remain unchanged** from the previous contract. The rate increase had been communicated by Peace of Mind in advance.
- Peace of Mind staff are **not ECRA employees**, but rather **external contractors**, used primarily:
  - When no internal staff are available.
  - To ensure program continuity during **staffing shortages** or for **specialized inclusion support**.
- A brief discussion was held regarding **supplement vs. supplant** distinctions under special education funding regulations, particularly in relation to using special education funds for long-term substitutes. Ms. Larew confirmed that:
  - Funding usage depends on the nature of the staffing gap.
  - Compliance with **credentialing limits** (30–60 day maximums for non-special education credentialed substitutes) is strictly monitored.
- The proposed **contract terms** are consistent with last year’s agreement and were **reviewed by legal counsel (Young, Minney & Corr, LLP)**.
  - Updates were made to reflect recent **state regulatory changes** applicable to NPAs.
  - New contract provisions include clarified language on **termination for cause** and **Individual Service Agreement (ISA) compliance**.

Gregg Solkovits made a motion to Vote to recommend to the full board the 2025-2026 Piece of Mind Special Education Services Contract.

Steven Kofahl seconded the motion.

The committee **VOTED** to approve the motion.

#### Roll Call

Steven Kofahl Aye  
Gregg Solkovits Aye  
Alexandra Ramirez Aye

#### C. Discussion and Vote to Recommend to the Full Board Approval of the 24-25 Instructional Materials (IMA) Budget

This item is tabled for the regular board meeting

#### D. Discussion and Vote to Recommend to the Full Board the 2025-2026 Substitute Contract

Ms. Rodriguez presented the **2025–2026 substitute contract review and rate comparison** for external substitute staffing vendors.

- A comparison of four vendors was provided:
  - **Scoot Education** (primary provider)
  - **The Education Team**
  - **Teachers on Reserve**
  - **Kelly Services** (not actively used in recent years)
- Scoot Education remains the **preferred vendor** for both **instructional aides** and **substitute teachers** due to:
  - Strong working relationship
  - Reliable service history
  - Consistent performance, including during critical needs such as **the recent teacher strike**
- **Rate Structure:**
  - Scoot provides rates for:
    - **Short-term and long-term assignments**
    - **Half-day and full-day rates**
  - Other vendors generally bill at **hourly rates**.
  - Notable exception: **Teachers on Reserve** includes billing for **lunch breaks**, resulting in slightly higher overall costs.
- **Pricing Update:**
  - Scoot has **maintained the same rates since 2023**, and will implement a **3% rate increase effective July 1, 2025**.
  - The Education Team, Teachers on Reserve, and Cross Country were also utilized during the recent strike, and remain available as **supplemental options** if additional staffing needs arise.
- Ms. Rodriguez emphasized the importance of maintaining contracts with **multiple vendors** for flexibility and emergency coverage, while continuing to prioritize Scoot as the **primary substitute service provider**.



**Recommendation:**

Ms. Rodriguez recommended continuing the contract with **Scoot Education** as the primary substitute staffing vendor for the 2025–2026 school year, with auxiliary use of other approved vendors as needed.

Gregg Solkovits made a motion to Vote to Recommend to the Full Board the 2025-2026 Substitute Contract.

Steven Kofahl seconded the motion.

The committee **VOTED** to approve the motion.

**Roll Call**

Gregg Solkovits     Aye  
 Alexandra Ramirez   Aye  
 Steven Kofahl        Aye

**E. Discussion and Vote for the 2025-2028 LACOE Contract for California School-Based Medi-Cal Administrative Activities Program**

Gregg Solkovits made a motion to Vote for the 2025-2028 LACOE Contract for California School-Based Medi-Cal Administrative Activities Program.

Alexandra Ramirez seconded the motion.

The committee **VOTED** to approve the motion.

**Roll Call**

Alexandra Ramirez   Aye  
 Gregg Solkovits     Aye  
 Steven Kofahl        Abstain

Mr. Hussey presented the proposed **2025–2028 contract** with the **Los Angeles County Office of Education (LACOE)** for participation in the **California School-Based Medi-Cal Administrative Activities (SMAA) Program**.

- The SMAA program allows school districts to **recoup federal funds** for performing certain **health-related administrative activities**, such as:
  - Medical-related counseling
  - Nurse time and documentation
  - Outreach and coordination of health services for students
- Staff members participating in these activities track their time using a **Random Moment Time Survey (RMTS)** method.
  - The data collected is submitted for reimbursement through LACOE, which acts as the **liaison and compliance monitor** between participating districts and federal Medi-Cal agencies.
- **There is no cost to El Camino Real CHS** for participating in this program.

- The contract simply enables the school to be **eligible for reimbursement** for services already being provided by staff in the normal course of their duties.
- LACOE provides compliance support and audits claims before submission to ensure all federal requirements are met.
- The contract was brought forward for approval due to its **three-year term (2025–2028)**.

**Recommendation:**

Mr. Hussey recommended approval of the contract, highlighting it as a **cost-free opportunity** to recapture funds in support of school-based medical-related activities.

**F. Discuss 2025-2026 Local Control Funding Formula (LCFF) Budget Overview for Parents**

This item is tabled for the regular board meeting

**VI. Closing Items**

**A. Adjourn Meeting**

Steven Kofahl made a motion to Adjourn meeting.

Alexandra Ramirez seconded the motion.

The committee **VOTED** to approve the motion.

There being no further business to be transacted, and upon motion duly made, seconded and approved, the meeting was adjourned at 6:57 PM.

Respectfully Submitted,  
Vania Rodriguez

# Coversheet

## September 2025 Investment Update

<b>Section:</b>	III. Investment
<b>Item:</b>	A. September 2025 Investment Update
<b>Purpose:</b>	Discuss
<b>Submitted by:</b>	
<b>Related Material:</b>	Investment Summary-08.25.pdf Investment Summary-08.25.pdf

**0.4%**

**EL CAMINO REAL CHS**  
**INVESTMENTS REVIEW**  
**FISCAL YEAR 2025-2026**

2025-2026		Year End		Contributions	
		Jul-25	Aug-25	Executive Summary-OPEB	
				\$ 33,407,833 Beginning Balance at 07/01/25	
OPEB Retiree Pmts.		\$ (52,048.18)	\$ (53,348.18)	\$ (105,396) OPEB Payments	
				Month	\$ 233,009
				Gains/Losses	0.7%
				Invest. Change	
ECRA	OPEB Trust	\$ 33,407,833	\$ 33,535,446	\$ 34,163,737	0.4%
				\$ 33,535,446	Current Ending
				0.4%	Total Change
Investment Managers:				Month	YTD
				N/A	
Fiduciary Mgt		\$ 2,675,796	\$ 2,662,714	\$ 2,744,203	-0.5%
Beacon Pointe		\$ 30,732,037	\$ 30,872,732	\$ 31,419,534	0.5%
El Camino Real CHS					
Investment Managers:				Month	YTD
Fiduciary Mgt		\$ 336,856	\$ 334,972	\$ 345,182	3.0%
Beacon Pointe		\$ 6,989,939	\$ 7,013,406	\$ 7,126,190	0.3%
US Bank Holdings		\$ 7,326,795	\$ 7,348,378	\$ 7,471,371	0.3%
Annuity 3 Yr. (8/26)Fixed @ 4.80%		\$ 439,179	\$ 440,931	\$ 443,487	0.4%
2Yr. (10/25)@ 4.89%		\$ 432,289	\$ 433,808	\$ 435,397	0.4%
Combined		\$ 8,198,263	\$ 8,223,117	\$ 8,350,255	0.3%
Month End -Combined		\$ 41,606,096	\$ 41,758,563	\$ 42,513,992	0.4%

# Coversheet

## 2024-2025 Unaudited Actuals

<b>Section:</b>	IV. Finance
<b>Item:</b>	A. 2024-2025 Unaudited Actuals
<b>Purpose:</b>	Vote
<b>Submitted by:</b>	
<b>Related Material:</b>	IV.A-2024-25 Unaudited Actuals UAR - FORM 62 pdf.pdf IV.A -2024-25 Unaudited Actuals Special ED COP Option 2.pdf

El Camino Real Charter High  
Los Angeles Unified  
Los Angeles County

Unaudited Actuals  
Charter Schools Enterprise Fund  
Expenses by Object

19 64733 1932623  
Form 62  
F8A2YX7JP3(2024-25)

Description	Resource Codes	Object Codes	2024-25 Unaudited Actuals	2025-26 Budget	Percent Difference
<b>A. REVENUES</b>					
1) LCFF Sources		8010-8099	35,783,374.00	35,203,494.00	-1.6%
2) Federal Revenue		8100-8299	2,633,753.83	1,742,127.00	-33.9%
3) Other State Revenue		8300-8599	3,528,661.11	3,210,476.11	-9.0%
4) Other Local Revenue		8600-8799	9,856,264.89	6,244,872.00	-36.6%
5) TOTAL, REVENUES			51,802,053.83	46,400,969.11	-10.4%
<b>B. EXPENSES</b>					
1) Certificated Salaries		1000-1999	18,013,598.68	18,592,792.97	3.2%
2) Classified Salaries		2000-2999	5,555,341.33	5,240,299.91	-5.7%
3) Employee Benefits		3000-3999	11,304,107.08	9,560,700.13	-15.4%
4) Books and Supplies		4000-4999	3,312,004.12	2,594,078.47	-21.7%
5) Services and Other Operating Expenses		5000-5999	10,128,124.98	9,343,478.43	-7.7%
6) Depreciation and Amortization		6000-6999	799,825.75	900,000.00	12.5%
7) Other Outgo (excluding Transfers of Indirect Costs)		7100-7299, 7400-7499	358,670.39	352,035.00	-1.8%
8) Other Outgo - Transfers of Indirect Costs		7300-7399	0.00	0.00	0.0%
9) TOTAL, EXPENSES			49,471,672.33	46,583,384.91	-5.8%
<b>C. EXCESS (DEFICIENCY) OF REVENUES OVER EXPENSES BEFORE OTHER FINANCING SOURCES AND USES (A5 - B9)</b>			2,330,381.50	(182,415.80)	-107.8%
<b>D. OTHER FINANCING SOURCES/USES</b>					
1) Interfund Transfers					
a) Transfers In		8900-8929	0.00	0.00	0.0%
b) Transfers Out		7600-7629	0.00	0.00	0.0%
2) Other Sources/Uses					
a) Sources		8930-8979	0.00	0.00	0.0%
b) Uses		7630-7699	0.00	0.00	0.0%
3) Contributions		8980-8999	0.00	0.00	0.0%
4) TOTAL, OTHER FINANCING SOURCES/USES			0.00	0.00	0.0%
<b>E. NET INCREASE (DECREASE) IN NET POSITION (C + D4)</b>			2,330,381.50	(182,415.80)	-107.8%
<b>F. NET POSITION</b>					
1) Beginning Net Position					
a) As of July 1 - Unaudited		9791	47,441,652.74	49,609,785.11	4.6%
b) Audit Adjustments		9793	(162,249.13)	(162,348.70)	0.1%
c) As of July 1 - Audited (F1a + F1b)			47,279,403.61	49,447,436.41	4.6%
d) Other Restatements		9795	0.00	0.00	0.0%
e) Adjusted Beginning Net Position (F1c + F1d)			47,279,403.61	49,447,436.41	4.6%
2) Ending Net Position, June 30 (E + F1e)			49,609,785.11	49,265,020.61	-0.7%
Components of Ending Net Position					
a) Net Investment in Capital Assets		9796	8,492,395.19	0.00	-100.0%
b) Restricted Net Position		9797	7,790,946.78	7,790,947.36	0.0%
c) Unrestricted Net Position		9790	33,326,443.14	41,474,073.25	24.4%
<b>G. ASSETS</b>					
1) Cash					
a) in County Treasury		9110	30,209,637.87		
1) Fair Value Adjustment to Cash in County Treasury		9111	0.00		
b) in Banks		9120	7,238,161.70		
c) in Revolving Cash Account		9130	68,411.15		
d) with Fiscal Agent/Trustee		9135	0.00		
e) Collections Awaiting Deposit		9140	0.00		
2) Investments		9150	8,049,392.08		
3) Accounts Receivable		9200	2,377,741.97		
4) Due from Grantor Government		9290	0.00		
5) Due from Other Funds		9310	0.00		
6) Stores		9320	584,225.64		
7) Prepaid Expenditures		9330	0.00		
8) Other Current Assets		9340	0.00		
9) Lease Receivable		9380	0.00		
10) Fixed Assets					

El Camino Real Charter High  
Los Angeles Unified  
Los Angeles County

Unaudited Actuals  
Charter Schools Enterprise Fund  
Expenses by Object

19 64733 1932623  
Form 62  
F8A2YX7JP3(2024-25)

Description	Resource Codes	Object Codes	2024-25 Unaudited Actuals	2025-26 Budget	Percent Difference
a) Land		9410	2,019,963.89		
b) Land Improvements		9420	286,352.39		
c) Accumulated Depreciation - Land Improvements		9425	(223,527.78)		
d) Buildings		9430	7,026,737.03		
e) Accumulated Depreciation - Buildings		9435	(1,582,992.65)		
f) Equipment		9440	2,842,864.92		
g) Accumulated Depreciation - Equipment		9445	(1,924,811.97)		
h) Work in Progress		9450	75,340.98		
i) Lease Assets		9460	1,478,554.00		
j) Accumulated Amortization-Lease Assets		9465	(1,056,085.62)		
k) Subscription Assets		9470	0.00		
l) Accumulated Amortization-Subscription Assets		9475	0.00		
11) TOTAL, ASSETS			57,469,965.60		
<b>H. DEFERRED OUTFLOWS OF RESOURCES</b>					
1) Deferred Outflows of Resources		9490	0.00		
2) TOTAL, DEFERRED OUTFLOWS			0.00		
<b>I. LIABILITIES</b>					
1) Accounts Payable		9500	5,141,466.60		
2) Due to Grantor Governments		9590	4,929,719.29		
3) Due to Other Funds		9610	0.00		
4) Current Loans		9640	0.00		
5) Unearned Revenue		9650	760,293.05		
6) Long-Term Liabilities					
a) Subscription Liability		9660	0.00		
b) Net Pension Liability		9663	0.00		
c) Total/Net OPEB Liability		9664	(3,262,927.00)		
d) Compensated Absences		9665	291,628.55		
e) COPs Payable		9666	0.00		
f) Leases Payable		9667	0.00		
g) Lease Revenue Bonds Payable		9668	0.00		
h) Other General Long-Term Liabilities		9669	0.00		
7) TOTAL, LIABILITIES			7,860,180.49		
<b>J. DEFERRED INFLOWS OF RESOURCES</b>					
1) Deferred Inflows of Resources		9690	0.00		
2) TOTAL, DEFERRED INFLOWS			0.00		
<b>K. NET POSITION</b>					
(must agree with line F2) (G11 + H2) - (I7 + J2)			49,609,785.11		
<b>LCFF SOURCES</b>					
Principal Apportionment					
State Aid - Current Year		8011	13,379,274.00	24,939,555.00	86.4%
Education Protection Account State Aid - Current Year		8012	11,126,495.00	512,457.00	-95.4%
State Aid - Prior Years		8019	(60,199.00)	0.00	-100.0%
LCFF Transfers					
Unrestricted LCFF Transfers - Current Year	0000	8091	0.00	0.00	0.0%
All Other LCFF Transfers - Current Year	All Other	8091	0.00	0.00	0.0%
Transfers to Charter Schools in Lieu of Property Taxes		8096	11,337,804.00	9,751,482.00	-14.0%
Property Taxes Transfers		8097	0.00	0.00	0.0%
LCFF Transfers - Prior Years		8099	0.00	0.00	0.0%
TOTAL, LCFF SOURCES			35,783,374.00	35,203,494.00	-1.6%
<b>FEDERAL REVENUE</b>					
Maintenance and Operations		8110	0.00	0.00	0.0%
Special Education Entitlement		8181	0.00	0.00	0.0%
Special Education Discretionary Grants		8182	0.00	0.00	0.0%
Child Nutrition Programs		8220	602,868.86	419,417.00	-30.4%
Donated Food Commodities		8221	0.00	0.00	0.0%
Interagency Contracts Between LEAs		8285	694,162.00	682,267.00	-1.7%
Title I, Part A, Basic	3010	8290	359,001.00	353,990.00	-1.4%



El Camino Real Charter High  
Los Angeles Unified  
Los Angeles County

Unaudited Actuals  
Charter Schools Enterprise Fund  
Expenses by Object

19 64733 1932623  
Form 62  
F8A2YX7JP3(2024-25)

Description	Resource Codes	Object Codes	2024-25 Unaudited Actuals	2025-26 Budget	Percent Difference
Title I, Part D, Local Delinquent Programs	3025	8290	0.00	0.00	0.0%
Title II, Part A, Supporting Effective Instruction	4035	8290	79,715.00	66,382.00	-16.7%
Title III, Immigrant Student Program	4201	8290	0.00	0.00	0.0%
Title III, English Learner Program	4203	8290	0.00	0.00	0.0%
Public Charter Schools Grant Program (PCSGP)	4610	8290	0.00	0.00	0.0%
Other Every Student Succeeds Act	3040, 3060, 3061, 3150, 3155, 3180, 3182, 4037, 4124, 4126, 4127, 4128, 5630	8290	26,525.00	28,170.00	6.2%
Career and Technical Education	3500-3599	8290	68,851.00	57,086.00	-17.1%
All Other Federal Revenue	All Other	8290	802,630.97	134,815.00	-83.2%
TOTAL, FEDERAL REVENUE			2,633,753.83	1,742,127.00	-33.9%
<b>OTHER STATE REVENUE</b>					
Other State Apportionments					
Special Education Master Plan					
Current Year	6500	8311	0.00	0.00	0.0%
Prior Years	6500	8319	0.00	0.00	0.0%
All Other State Apportionments - Current Year	All Other	8311	0.00	0.00	0.0%
All Other State Apportionments - Prior Years	All Other	8319	0.00	0.00	0.0%
Child Nutrition Programs		8520	1,044,580.00	1,106,138.00	5.9%
Mandated Costs Reimbursements		8550	163,983.00	193,742.00	18.1%
Lottery - Unrestricted and Instructional Materials		8560	795,841.67	679,865.11	-14.6%
Expanded Learning Opportunities Program (ELO-P)	2600	8590	0.00	0.00	0.0%
After School Education and Safety (ASES)	6010	8590	0.00	0.00	0.0%
Charter School Facility Grant	6030	8590	0.00	0.00	0.0%
Drug/Alcohol/Tobacco Funds	6690, 6695	8590	0.00	0.00	0.0%
Arts and Music in Schools (Prop 28)	6770	8590	424,673.00	424,673.00	0.0%
California Clean Energy Jobs Act	6230	8590	0.00	0.00	0.0%
Career Technical Education Incentive Grant Program	6387	8590	468,948.00	234,474.00	-50.0%
Specialized Secondary	7370	8590	0.00	0.00	0.0%
All Other State Revenue	All Other	8590	630,635.44	571,584.00	-9.4%
TOTAL, OTHER STATE REVENUE			3,528,661.11	3,210,476.11	-9.0%
<b>OTHER LOCAL REVENUE</b>					
Sales					
Sale of Equipment/Supplies		8631	0.00	0.00	0.0%
Sale of Publications		8632	0.00	0.00	0.0%
Food Service Sales		8634	16,620.15	18,000.00	8.3%
All Other Sales		8639	0.00	0.00	0.0%
Leases and Rentals		8650	39,176.29	65,000.00	65.9%
Interest		8660	5,022,061.57	1,771,118.00	-64.7%
Net Increase (Decrease) in the Fair Value of Investments		8662	0.00	0.00	0.0%
Fees and Contracts					
Child Development Parent Fees		8673	0.00	0.00	0.0%
Transportation Fees From Individuals		8675	0.00	0.00	0.0%
Interagency Services		8677	2,713,514.42	2,404,754.00	-11.4%
All Other Fees and Contracts		8689	0.00	0.00	0.0%
All Other Local Revenue		8699	554,884.46	861,000.00	55.2%
Tuition		8710	1,510,008.00	1,125,000.00	-25.5%
All Other Transfers In		8781-8783	0.00	0.00	0.0%
Transfers of Apportionments					
Special Education SELPA Transfers					
From Districts or Charter Schools	6500	8791	0.00	0.00	0.0%
From County Offices	6500	8792	0.00	0.00	0.0%
From JPAs	6500	8793	0.00	0.00	0.0%
Other Transfers of Apportionments					
From Districts or Charter Schools	All Other	8791	0.00	0.00	0.0%
From County Offices	All Other	8792	0.00	0.00	0.0%

El Camino Real Charter High  
Los Angeles Unified  
Los Angeles County

Unaudited Actuals  
Charter Schools Enterprise Fund  
Expenses by Object

19 64733 1932623  
Form 62  
F8A2YX7JP3(2024-25)

Description	Resource Codes	Object Codes	2024-25 Unaudited Actuals	2025-26 Budget	Percent Difference
From JPAs	All Other	8793	0.00	0.00	0.0%
All Other Transfers In from All Others		8799	0.00	0.00	0.0%
TOTAL, OTHER LOCAL REVENUE			9,856,264.89	6,244,872.00	-36.6%
TOTAL, REVENUES			51,802,053.83	46,400,969.11	-10.4%
<b>CERTIFICATED SALARIES</b>					
Certificated Teachers' Salaries		1100	14,464,625.67	15,302,620.97	5.8%
Certificated Pupil Support Salaries		1200	2,309,089.98	2,258,383.00	-2.2%
Certificated Supervisors' and Administrators' Salaries		1300	1,239,883.03	1,031,789.00	-16.8%
Other Certificated Salaries		1900	0.00	0.00	0.0%
TOTAL, CERTIFICATED SALARIES			18,013,598.68	18,592,792.97	3.2%
<b>CLASSIFIED SALARIES</b>					
Classified Instructional Salaries		2100	1,144,836.06	865,248.58	-24.4%
Classified Support Salaries		2200	2,169,368.84	2,010,756.60	-7.3%
Classified Supervisors' and Administrators' Salaries		2300	952,355.41	828,052.00	-13.1%
Clerical, Technical and Office Salaries		2400	1,079,842.94	1,174,243.20	8.7%
Other Classified Salaries		2900	208,938.08	361,999.53	73.3%
TOTAL, CLASSIFIED SALARIES			5,555,341.33	5,240,299.91	-5.7%
<b>EMPLOYEE BENEFITS</b>					
STRS		3101-3102	3,078,633.17	3,451,223.00	12.1%
PERS		3201-3202	1,314,619.98	1,124,192.98	-14.5%
OASDI/Medicare/Alternative		3301-3302	653,790.11	670,478.15	2.6%
Health and Welfare Benefits		3401-3402	3,993,324.25	4,089,555.00	2.4%
Unemployment Insurance		3501-3502	10,852.57	11,916.00	9.8%
Workers' Compensation		3601-3602	196,084.90	205,335.00	4.7%
OPEB, Allocated		3701-3702	2,046,483.84	0.00	-100.0%
OPEB, Active Employees		3751-3752	0.00	0.00	0.0%
Other Employee Benefits		3901-3902	10,318.26	8,000.00	-22.5%
TOTAL, EMPLOYEE BENEFITS			11,304,107.08	9,560,700.13	-15.4%
<b>BOOKS AND SUPPLIES</b>					
Approved Textbooks and Core Curricula Materials		4100	167,805.15	167,333.00	-0.3%
Books and Other Reference Materials		4200	9,933.45	15,429.00	55.3%
Materials and Supplies		4300	2,134,553.50	1,378,197.47	-35.4%
Noncapitalized Equipment		4400	278,512.20	366,300.00	31.5%
Food		4700	721,199.82	666,819.00	-7.5%
TOTAL, BOOKS AND SUPPLIES			3,312,004.12	2,594,078.47	-21.7%
<b>SERVICES AND OTHER OPERATING EXPENSES</b>					
Subagreements for Services		5100	17,665.92	10,286.00	-41.8%
Travel and Conferences		5200	110,876.58	108,003.00	-2.6%
Dues and Memberships		5300	594,088.44	585,753.00	-1.4%
Insurance		5400-5450	452,363.00	459,736.00	1.6%
Operations and Housekeeping Services		5500	1,514,025.02	960,968.00	-36.5%
Rentals, Leases, Repairs, and Noncapitalized Improvements		5600	1,060,087.66	1,476,118.43	39.2%
Transfers of Direct Costs		5710	0.00	0.00	0.0%
Transfers of Direct Costs - Interfund		5750	0.00	0.00	0.0%
Professional/Consulting Services and Operating Expenditures		5800	6,293,688.83	5,629,002.00	-10.6%
Communications		5900	85,329.53	113,612.00	33.1%
TOTAL, SERVICES AND OTHER OPERATING EXPENSES			10,128,124.98	9,343,478.43	-7.7%
<b>DEPRECIATION AND AMORTIZATION</b>					
Depreciation Expense		6900	799,825.75	900,000.00	12.5%
Amortization Expense-Lease Assets		6910	0.00	0.00	0.0%
Amortization Expense-Subscription Assets		6920	0.00	0.00	0.0%
TOTAL, DEPRECIATION AND AMORTIZATION			799,825.75	900,000.00	12.5%
<b>OTHER OUTGO (excluding Transfers of Indirect Costs)</b>					
Tuition					
Tuition for Instruction Under Interdistrict Attendance Agreements		7110	0.00	0.00	0.0%
Tuition, Excess Costs, and/or Deficit Payments					
Payments to Districts or Charter Schools		7141	0.00	0.00	0.0%

El Camino Real Charter High  
Los Angeles Unified  
Los Angeles County

Unaudited Actuals  
Charter Schools Enterprise Fund  
Expenses by Object

19 64733 1932623  
Form 62  
F8A2YX7JP3(2024-25)

Description	Resource Codes	Object Codes	2024-25 Unaudited Actuals	2025-26 Budget	Percent Difference
Payments to County Offices		7142	0.00	0.00	0.0%
Payments to JPAs		7143	0.00	0.00	0.0%
Other Transfers Out					
All Other Transfers		7281-7283	0.00	0.00	0.0%
All Other Transfers Out to All Others		7299	358,670.39	352,035.00	-1.8%
Debt Service					
Debt Service - Interest		7438	0.00	0.00	0.0%
TOTAL, OTHER OUTGO (excluding Transfers of Indirect Costs)			358,670.39	352,035.00	-1.8%
<b>OTHER OUTGO - TRANSFERS OF INDIRECT COSTS</b>					
Transfers of Indirect Costs		7310	0.00	0.00	0.0%
Transfers of Indirect Costs - Interfund		7350	0.00	0.00	0.0%
TOTAL, OTHER OUTGO - TRANSFERS OF INDIRECT COSTS			0.00	0.00	0.0%
TOTAL, EXPENSES			49,471,672.33	46,583,384.91	-5.8%
<b>INTERFUND TRANSFERS</b>					
<b>INTERFUND TRANSFERS IN</b>					
Other Authorized Interfund Transfers In		8919	0.00	0.00	0.0%
(a) TOTAL, INTERFUND TRANSFERS IN			0.00	0.00	0.0%
<b>INTERFUND TRANSFERS OUT</b>					
Other Authorized Interfund Transfers Out		7619	0.00	0.00	0.0%
(b) TOTAL, INTERFUND TRANSFERS OUT			0.00	0.00	0.0%
<b>OTHER SOURCES/USES</b>					
<b>SOURCES</b>					
Other Sources					
Transfers from Funds of Lapsed/Reorganized LEAs		8965	0.00	0.00	0.0%
All Other Financing Sources		8979	0.00	0.00	0.0%
(c) TOTAL, SOURCES			0.00	0.00	0.0%
<b>USES</b>					
Transfers of Funds from Lapsed/Reorganized LEAs		7651	0.00	0.00	0.0%
All Other Financing Uses		7699	0.00	0.00	0.0%
(d) TOTAL, USES			0.00	0.00	0.0%
<b>CONTRIBUTIONS</b>					
Contributions from Unrestricted Revenues		8980	0.00	0.00	0.0%
Contributions from Restricted Revenues		8990	0.00	0.00	0.0%
(e) TOTAL, CONTRIBUTIONS			0.00	0.00	0.0%
TOTAL, OTHER FINANCING SOURCES/USES (a - b + c - d + e)			0.00	0.00	0.0%

El Camino Real Charter High  
Los Angeles Unified  
Los Angeles County

Unaudited Actuals  
Charter Schools Enterprise Fund  
Expenses by Function

19 64733 1932623  
Form 62  
F8A2YX7JP3(2024-25)

Description	Function Codes	Object Codes	2024-25 Unaudited Actuals	2025-26 Budget	Percent Difference
<b>A. REVENUES</b>					
1) LCFF Sources		8010-8099	35,783,374.00	35,203,494.00	-1.6%
2) Federal Revenue		8100-8299	2,633,753.83	1,742,127.00	-33.9%
3) Other State Revenue		8300-8599	3,528,661.11	3,210,476.11	-9.0%
4) Other Local Revenue		8600-8799	9,856,264.89	6,244,872.00	-36.6%
5) TOTAL, REVENUES			51,802,053.83	46,400,969.11	-10.4%
<b>B. EXPENSES (Objects 1000-7999)</b>					
1) Instruction	1000-1999		29,597,871.49	25,028,809.72	-15.4%
2) Instruction - Related Services	2000-2999		10,812,986.93	12,202,838.81	12.9%
3) Pupil Services	3000-3999		3,560,836.75	3,785,985.42	6.3%
4) Ancillary Services	4000-4999		0.00	0.00	0.0%
5) Community Services	5000-5999		0.00	0.00	0.0%
6) Enterprise	6000-6999		0.00	0.00	0.0%
7) General Administration	7000-7999		1,769,129.34	1,878,390.53	6.2%
8) Plant Services	8000-8999		3,372,177.43	3,335,325.43	-1.1%
9) Other Outgo	9000-9999	Except 7600-7699	358,670.39	352,035.00	-1.8%
10) TOTAL, EXPENSES			49,471,672.33	46,583,384.91	-5.8%
<b>C. EXCESS (DEFICIENCY) OF REVENUES OVER EXPENSES BEFORE OTHER FINANCING SOURCES AND USES (A5 - B10)</b>			2,330,381.50	(182,415.80)	-107.8%
<b>D. OTHER FINANCING SOURCES/USES</b>					
1) Interfund Transfers					
a) Transfers In		8900-8929	0.00	0.00	0.0%
b) Transfers Out		7600-7629	0.00	0.00	0.0%
2) Other Sources/Uses					
a) Sources		8930-8979	0.00	0.00	0.0%
b) Uses		7630-7699	0.00	0.00	0.0%
3) Contributions		8980-8999	0.00	0.00	0.0%
4) TOTAL, OTHER FINANCING SOURCES/USES			0.00	0.00	0.0%
<b>E. NET INCREASE (DECREASE) IN NET POSITION (C + D4)</b>			2,330,381.50	(182,415.80)	-107.8%
<b>F. NET POSITION</b>					
1) Beginning Net Position					
a) As of July 1 - Unaudited		9791	47,441,652.74	49,609,785.11	4.6%
b) Audit Adjustments		9793	(162,249.13)	(162,348.70)	0.1%
c) As of July 1 - Audited (F1a + F1b)			47,279,403.61	49,447,436.41	4.6%
d) Other Restatements		9795	0.00	0.00	0.0%
e) Adjusted Beginning Net Position (F1c + F1d)			47,279,403.61	49,447,436.41	4.6%
2) Ending Net Position, June 30 (E + F1e)			49,609,785.11	49,265,020.61	-0.7%
Components of Ending Net Position					
a) Net Investment in Capital Assets		9796	8,492,395.19	0.00	-100.0%
b) Restricted Net Position		9797	7,790,946.78	7,790,947.36	0.0%
c) Unrestricted Net Position		9790	33,326,443.14	41,474,073.25	24.4%

El Camino Real Charter High  
Los Angeles Unified  
Los Angeles County

Unaudited Actuals  
Charter Schools Enterprise Fund  
Exhibit: Restricted Net Position Detail

19 64733 1932623  
Form 62  
F8A2YX7JP3(2024-25)

Resource	Description	2024-25 Unaudited Actuals	2025-26 Budget
5310	Child Nutrition: School Programs (e.g., School Lunch, School Breakfast, Milk, Pregnant & Lactating Students)	916,735.49	916,736.07
5330	Child Nutrition: Summer Food Service Program Operations	217,171.10	217,171.10
5466	Child Nutrition: Supply Chain Assistance (SCA) Funds	297,454.62	297,454.62
6266	Educator Effectiveness, FY 2021-22	234,583.17	234,583.17
6318	Antibias Education Grant	83,327.33	83,327.33
6762	Arts, Music, and Instructional Materials Discretionary Block Grant	1,972,491.95	1,972,491.95
6770	Arts and Music in Schools (AMS)-Funding Guarantee and Accountability Act (Prop 28)	611,359.59	611,359.59
7032	Child Nutrition: Kitchen Infrastructure and Training Funds - 2022 KIT Funds	191,912.20	191,912.20
7033	Child Nutrition: School Food Best Practices Apportionment	88,516.00	88,516.00
7412	A-G Access/Success Grant	253,082.33	253,082.33
7413	A-G Learning Loss Mitigation Grant	129,358.00	129,358.00
7435	Learning Recovery Emergency Block Grant	2,702,302.00	2,702,302.00
7810	Other Restricted State	92,653.00	92,653.00
Total, Restricted Net Position		7,790,946.78	7,790,947.36

## 2024-2025 UNAUDITED ACTUALS REPORT SPECIAL ED - COP OPTION 2 AND 3 SCHOOLS

**CHARTER NAME: EL CAMINO REAL CHS**

9010
SPED-Federal IDEA (Must be spent or returned)

9010
SPED-State AB602 & Grants

**A. REVENUES**

1) Special Ed: IDEA Basic Local Assistance - Current/Prior Year	8100-8299	\$ -	
2) Special Education AB602 - Current/Prior Year	8300-8599		\$ -
3) All Special Ed Apportionments-Current Year	8300-8599		\$ 204,597
4) OTHER LOCAL REVENUE	8600-8699	\$ 694,162	\$ 2,713,514
<b>TOTAL REVENUES</b>		<b>\$ 694,162</b>	<b>\$ 2,918,111</b>

**B. EXPENSES**

1) Certificated Salaries	1000-1999	\$ 362,159	\$ 2,428,186
2) Classified Salaries	2000-2999		\$ 826,431
3) Employee Benefits	3000-3999		\$ 1,809,705
4) Books & Supplies	4000-4999		\$ 19,932
5) Services and Other Operating Expenses	5000-5999	\$ 332,003	\$ 1,713,314
6) Depreciation	6000-6999		
7) Other Outgo (excluding Transfers of indirect Costs)	7400-7499		
8) Other Outgo - Transfers of Indirect Costs	7300-7399		
<b>TOTAL EXPENSES</b>		<b>\$ 694,162</b>	<b>\$ 6,797,568</b>

**C. EXCESS/(encroachment) OF REVENUES OVER EXPENSES**

<b>0</b>	<b>(3,879,456)</b>
----------	--------------------

- NOTE:**
1. Special Ed - IDEA should match the SACS Form 62 Object Code 8285 Interagency Contracts between LEAS
  2. Special Ed - AB602 should match the SACS Form 62 Object Code 8677 Interagency Services

**Prepared by:** Gregory Wood

# Coversheet

## Review of August 2025 Check Registers

<b>Section:</b>	IV. Finance
<b>Item:</b>	B. Review of August 2025 Check Registers
<b>Purpose:</b>	Vote
<b>Submitted by:</b>	
<b>Related Material:</b>	IV.B. -August 2025 Check Register-General Fund.pdf IV.B. -August 2025 Check Register-ASB Trust.pdf IV.B. -August 2025 Check Register-Checking.pdf IV.B. -July 2025 General Acc. Check Register.pdf IV.B. - ASB Trust Balance August 2025.pdf

**EL CAMINO REAL CHARTER HIGH SCHOOL****CHECK REGISTER****General Account 1761 A/P Account****August 2025****Total Amount: \$ 409,728.91**

<b>Name</b>	<b>Check Number</b>	<b>Date</b>	<b>Memo</b>	<b>Amount</b>
5255 PPLSI	ACH250804-01	8/4/2025	LEGALSHIELD - AUG 2025 PAYROLL	\$ 25.90
2006 CharterSafe	ACH250804-02	8/4/2025	CHARTERSAFE - AUG 2025	\$ 55,422.00
4001 Texas Life Insurance Company	ACH250805-01	8/5/2025	SM0F6Z20220714001 Supplemental Life Insurance 08/05/25	\$ 607.98
3480 PenServ Plan Services	ACH250808-01	8/8/2025	403(B) Funding 06/01/25 - 0/30/25	\$ 39,606.88
3922 Self Insured Schools of California	ACH250812-01	8/12/2025	SISC HEALTH-AUGUST 2025	\$ 311,932.59
2447 Purchase Power (Pitney Bowes)	ACH250813-01	8/13/2025	POSTAGE REFILL - AUG 2025	\$ 998.36
3480 PenServ Plan Services	ACH250820-01	8/20/2025	403(B) Funding 08/01/25 - 08/31/25	\$ 501.32
5255 PPLSI	ACH250826-01	8/26/2025	LEGALSHIELD - AUGUST 2025 PAYROLL	\$ 25.90
4001 Texas Life Insurance Company	ACH250826-02	8/26/2025	SM0F6Z20220714001 Supplemental Life insurance 08/26/25	\$ 607.98



**EL CAMINO REAL CHARTER HIGH SCHOOL  
CHECK REGISTER  
ASB Trust Account #1826  
August 2025**

**Total Amount: \$244,684.45**

Name	Check Number	Date	Memo	Amount
5395 Courtney Coffey	3475	8/1/2025	June 2025 Coaching (TRUST - Dance)	\$ 600.00
5797 Kamelia Tashakor	3476	8/5/2025	Reimbursement for Banquet (TRUST - Sand Volleyball)	\$ 515.95
5219 CCIDM Inc.	3477	8/6/2025	ECR Colorguard Van Rental 4-10 to 4-13 REISSUE (TRUST - Drill Team)	\$ 769.92
4655 California Lutheran University	3478	8/6/2025	2025 So Cal Challenge Summer League (TRUST - Girls Volleyball)	\$ 550.00
4265 Grand G&G Inc.	3479	8/12/2025	Student Store Snack Inventory	\$ 294.25
4265 Grand G&G Inc.	3480	8/12/2025	Student Store Snack Inventory	\$ 1,953.13
2853 First Class Events	3481	8/12/2025	Balance for Prom Additional Guests (ASB General)	\$ 1,254.00
5797 Kamelia Tashakor	3482	8/12/2025	2024-2025 Tournament Parking & Tip (TRUST - Sand Volleyball)	\$ 147.50
2853 First Class Events	3483	8/13/2025	VOID	\$ -
2853 First Class Events	3484	8/13/2025	Homecoming (TRUST - Student Council)	\$ 5,000.00
5262 Veronica Ocana	3485	8/19/2025	PE clothes, Gray Hoodie, Print only service, Royal Endurance shirt	\$ 19,058.06
4265 Grand G&G Inc.	3486	8/19/2025	Student Store Snack Inventory	\$ 1,134.46
2015 Cimarron Sign Services, Inc.	3487	8/19/2025	Sign for 2025 Championship ( TRUST - Baseball)	\$ 1,950.00
2204 Herff Jones LLC	3488	8/19/2025	2024 Graduation products (TRUST - Grad Class 2025)	\$ 6,109.63
4834 BOATHOUSE ROW SPORTS LTD (BOATHOUSE SPORTS)	3489	8/19/2025	CO-14808-25 Pullover (TRUST - Girls Soccer)	\$ 5,537.29
3827 College Board	3490	8/19/2025	INV A261015791 AP Exams	\$ 143,018.00
4892 Impact Cheer & Tumbling	3491	8/21/2025	07/25 Impact Cheer & Tumbling participation form fee	\$ 1,450.00
1947 BSN Sports LLC	3492	8/21/2025	Hats for sale (Student Store)	\$ 1,295.26
3336 AV Masters, Inc	3493	8/26/2025	graduation sound system, video, live streaming ( Grad Class 2025)	\$ 39,282.80
5309 Pinstripes, Inc.	3494	8/27/2025	Deposit for Pinstripes Food & Service Charge (TRUST - Sand Volleyball)	\$ 2,538.21
2444 Picture Perfect Graphics	3495	8/28/2025	Jerseys, Hats - Girls Golf 2026	\$ 2,589.01
2035 Countdown Printables	3496	8/28/2025	Crew Tees for Tennis	\$ 917.24
5811 MB2 Xtreme, Inc	3498	8/28/2025	09/16/25 Senior picnic deposit	\$ 8,719.74

## EL CAMINO REAL CHARTER HIGH SCHOOL

## CHECK REGISTER

Checking Account 1796 A/P Account

August 2025

Total Amount: **\$1,118,879.29**

Name	Check Number	Date	Memo	Amount
5764 Leanne Warren	21101	8/1/2025	Tests & Answers P00626 (ACADECA)	\$ 500.00
5531 Jacob Faye	21102	8/1/2025	Tests & answers P00623 (ACADECA)	\$ 500.00
5078 Adam Markenson	21103	8/1/2025	Tests & answer P00625 (ACADECA)	\$ 500.00
5392 Best Cafe Enterprises, LLC	21104	8/5/2025	Breakfast Meetings/Events 08/05/2025 (General Academic)	\$ 253.45
2643 Turnitin, LLC	21105	8/5/2025	VOID	\$ -
2447 Purchase Power (Pitney Bowes)	21106	8/5/2025	07/25 Meter Refill Acct # 8000 9090 0876 5336	\$ 998.36
2809 WM Corporate services, INC	21107	8/5/2025	08/0 to 08/31/2025 Waste Management Services on Shoup	\$ 932.52
3139 SoCalGas	21108	8/5/2025	07/25 Gas Charges for Shoup Acct 163 513 3769 2	\$ 22.77
4259 AT&T (CALNET)	21109	8/5/2025	06/20/2025 to 07/19/2025 BAN#9391080024 Phone Line	\$ 94.81
4259 AT&T (CALNET)	21110	8/5/2025	06/20/2025 to 07/19/2025 BAN#9391080076 Phone Line	\$ 63.28
4259 AT&T (CALNET)	21111	8/5/2025	06/20/2025 to 07/19/2025 BAN#9391080027 Phone Line	\$ 94.83
4259 AT&T (CALNET)	21112	8/6/2025	06/20/2025 to 07/19/2025 BAN#9391080026 Phone Line	\$ 71.28
3806 T-Mobile US, Inc.	21113	8/5/2025	08/25 969604280 - Wi-Fi Student Hot Spots	\$ 400.00
4417 Old New York & Deli Bakery Co., Inc	21114	8/6/2025	PD Breakfast Catering (Administrative)	\$ 3,002.23
4417 Old New York & Deli Bakery Co., Inc	21115	8/6/2025	Teachers and Staff Professional development Lunch Catering (Administrative)	\$ 3,469.66
5392 Best Cafe Enterprises, LLC	21116	8/7/2025	Breakfast (Administrative)	\$ 2,349.74
5392 Best Cafe Enterprises, LLC	21117	8/8/2025	INV 3137879 Breakfast (Administrative)	\$ 1,440.00
5707 SISC III-COBRA	21118	8/8/2025	09/25 Cobra Insurance	\$ 1,563.45
4216 Sunbelt Controls, Inc	21119	8/12/2025	01/25 Labor inv 5064166 (Buildings and Grounds)	\$ 1,931.00
4767 M & S Technology Group, LLC (The Circle)	21120	8/12/2025	Toshiba MJ series Staple 2400 Cartridge	\$ 107.20
5722 TEACHERS ON RESERVE	21121	8/12/2025	Substitute Teacher for weeks ending 07/14 till 07/18/2025	\$ 2,988.20
4618 The Home Depot Commercial Account	21122	8/12/2025	07/25 Woodshop Supplies 6035 3225 4019 9670	\$ 351.44
2808 Macmillan Holdings, LLC (Holtzbrinck Publishers, LLC) MPS	21123	8/12/2025	Social Studies Books (Social Studies)	\$ 7,013.16
4877 Total Education Solutions (TES Therapy)	21124	8/12/2025	TES Therapy 04/2025 (Special Education)	\$ 1,113.75
5344 Henry Rosales	21125	8/12/2025	07/25 Gardening Invoice for Shoup	\$ 1,000.00
5123 E3 Diagnostics Inc.	21126	8/12/2025	INV SEV-62407 & SRV-136871 Calibration Audio Machine (Special Education)	\$ 325.00
2426 Phase II Systems (Public Agency Retirement Services - PARS)	21127	8/12/2025	Annual Asset Fees Plan A5 - ARS11A 05/25 (General Operations)	\$ 371.99
2526 School Datebooks	21128	8/12/2025	INV S25-0314041 Datebooks (Special Education)	\$ 1,319.17
2025 CliftonLarsonAllen LLP	21129	8/13/2025	INV L251371586 for service rendered for May 2025	\$ 1,219.05
2014 CIF LA City Section	21130	8/14/2025	INV 2086 CIF DUES 2025-2026	\$ 13,883.50
5236 Accelerate Education Incorporated	21131	8/14/2025	IS Effective Instruction fee for 25-26 (Independent Study)	\$ 31,045.00
3071 Gardena Valley News	21132	8/14/2025	Newspaper supplies & Subscriptions 2024-2025 (Journalism / King's Courier)	\$ 5,260.14
2015 Cimarron Sign Services, Inc.	21133	8/14/2025	VOID	\$ -
2133 Flinn Scientific Inc.	21134	8/14/2025	Chemicals for independent study labs (Independent Study)	\$ 168.45
2832 Apple Inc.	21135	8/14/2025	Apple products (MBA15 MDN, CPU, Adapter, etc..) (Drama)	\$ 1,546.99
2379 Mutual of Omaha	21136	8/14/2025	Voluntary Disability Insurance 08/25	\$ 1,280.34
3007 The Howard Group	21137	8/15/2025	9,10,11&12th Grade hate speech assemblies (Administrative)	\$ 36,000.00
16 930661 Cameron Maury	21138	8/15/2025	Reimbursement 2025 CTA Summer Inst. (English)	\$ 283.64
18 719731 Ian Mcfarlin	21139	8/19/2025	Reimbursement supplies for the dept. 2025 (English)	\$ 193.96
3836 AT&T 6340	21140	8/21/2025	25-Aug 818 888-6340 249 Phone Bill (General Operations)	\$ 448.91
1893 AT&T	21141	8/19/2025	25-Aug 818 887-7018 449 Phone Bill (General Operations)	\$ 399.31
3835 AT&T 9221	21142	8/19/2025	25-Aug 818 887-9221 130 Phone Bill (General Operations)	\$ 400.65
5722 TEACHERS ON RESERVE	21143	8/19/2025	7/25/25 9-12 gr Art - (Compliance Office)	\$ 1,494.10
73 419751 Donald S Tseng	21144	8/19/2025	2/2725-3/2/25 San Francisco PD -The gate conference (English)	\$ 130.33
1947 BSN Sports LLC	21145	8/19/2025	Athletic Department Polos	\$ 1,208.16
5236 Accelerate Education Incorporated	21146	8/19/2025	Eff Teachers participation fee for 2025-2026 (Alternative Education)	\$ 16,900.00
5771 Yash Singhal	21147	8/19/2025	ACADECA Testing Materials	\$ 500.00
5531 Jacob Faye	21148	8/19/2025	ACADECA Testing materials P00662	\$ 250.00

**EL CAMINO REAL CHARTER HIGH SCHOOL**
**CHECK REGISTER**
**Checking Account 1796 A/P Account**
**August 2025**
**Total Amount: \$1,118,879.29**

Name	Check Number	Date	Memo	Amount
3924 All American Sports Corp. (Riddell/All American)	21149	8/19/2025	Football Gear (Football)	\$ 18,750.76
4914 Effectual Educational Consulting Services	21150	8/21/2025	Consulting Services 5/22/25 (Special Education)	\$ 55.00
3919 U.S Bank PARS Account #6746022400	21151	8/26/2025	07/25 PARS Contributions (General Operations)	\$ 1,120.58
4877 Total Education Solutions (TES Therapy)	21152	8/21/2025	Therapy 06/25 (Special Education)	\$ 202.50
1945 Brooks Transportation Inc.	21153	8/21/2025	Trip to Oak Park High Football 08/11/2025	\$ 2,370.00
1945 Brooks Transportation Inc.	21154	8/21/2025	Remaining balance for Trip to Birmingham 7/22/25 (Athletics)	\$ 100.00
3987 Figdesign Inc	21155	8/26/2025	Additional street signs for graduation	\$ 143.18
2288 LADWP	21156	8/26/2025	25-Jul 6968788886 Shoup Utilities	\$ 3,951.82
3358 RPS El Camino Real Charter HS Charles Schwab & Co, Inc. 2563-4428	21157	8/26/2025	07/25 403(B) Plan 2563-4428 Charles Schwab (General Operations)	\$ 4,925.00
2426 Phase II Systems (Public Agency Retirement Services - PARS)	21158	8/26/2025	57283 PARS ARS Fees	\$ 377.58
5280 Roth Staffing Companies, LP	21159	8/28/2025	6/8/25 Week Temp Staff	\$ 1,144.46
3987 Figdesign Inc	21160	8/28/2025	Reprint of 50 graduation programs	\$ 237.57
5707 SISC III-COBRA	21161	8/25/2025	09/25 Cobra Insurance	\$ 1,959.21
3359 UTLA	21162	8/28/2025	07/25 UTLA Union Dues	\$ 15,184.78
4510 Tennant Sales and Service Company	21163	8/28/2025	Labor (Technology) (Building and Ground)	\$ 664.37
5803 Brady Plus	21164	8/26/2025	Liners, Towel Single fold, Tissue Bath Hygienic (Building and Ground)	\$ 11,449.11
3907 Christy White Accountancy Corporation (Christy White, Inc.)	21165	8/28/2025	2024-25 Charter School Audit	\$ 5,370.75
5262 Veronica Ocana	21166	8/28/2025	ECR Boys Basketball - IQ P00168 (Athletic)	\$ 1,425.14
5480 Magic School, Inc	21167	8/28/2025	one year Partnership Renewal - IQ P00676 (Technology)	\$ 4,806.00
5815 Western Band Association (BD Performing Arts)	21168	8/28/2025	Event Entry Fee WBA (Visual and Performing Arts)	\$ 800.00
2535 SCSBOA	21169	8/28/2025	SCSBOA Registration 10/25-11/15/25 (Audio,Visual,Performing)	\$ 1,400.00
3008 Sweetwater Sound Inc.	21170	8/28/2025	Equipment/materials - IQ P00498 (Audio,Visual,Performing)	\$ 5,851.13
3601 AFSCME District Council 36	21171	8/28/2025	07/25 Union Dues	\$ 1,347.50
3008 Sweetwater Sound Inc.	21172	8/28/2025	Instruments - IQ P00521 (Visual and Performing Arts)	\$ 4,568.00
3008 Sweetwater Sound Inc.	21173	8/28/2025	Instruments PO12165 (Visual and Performing Arts)	\$ 2,610.17
3008 Sweetwater Sound Inc.	21174	8/28/2025	Instruments - IQ P00500 (Visual and Performing Arts)	\$ 7,012.64
5799 M3 Office Inc	SPACH3329	8/1/2025	furniture's for individualized desk for Math and SPED department	\$ 526,973.89
4102 Allied Private Investigations & Security Services, LLC	SPACH3330	8/1/2025	Security Services 06/06/25	\$ 4,995.75
1833 Amazon	SPACH3331	8/4/2025	DRAMA CONSTRUCTION SUPPLIES	\$ 3,603.07
1833 Amazon	SPACH3332	8/4/2025	Cords for Graduation Honors	\$ 1,955.76
1833 Amazon	SPACH3333	8/4/2025	sandals for graduation ceremony	\$ 207.80
1833 Amazon	SPACH3334	8/4/2025	ALED NOVELS	\$ 525.30
1833 Amazon	SPACH3335	8/4/2025	Counseling Office / Business Group	\$ 311.98
1833 Amazon	SPACH3336	8/4/2025	Women's day -Appreciation	\$ 314.26
1833 Amazon	SPACH3337	8/4/2025	sandals for graduation ceremony	\$ 103.46
4102 Allied Private Investigations & Security Services, LLC	SPACH3338	8/6/2025	ELC 2506 B Security Services 06/30/25	\$ 4,942.50
4102 Allied Private Investigations & Security Services, LLC	SPACH3339	8/6/2025	INV ELC 2506 Security Services 06/01-06/06/25	\$ 17,738.75
2445 Piece of Mind Care Services	SPACH3340	8/12/2025	Students Support Services 06/25-07/25	\$ 9,526.88
1833 Amazon	SPACH3341	8/12/2025	Health OFFICE SUPPLIES	\$ 404.32
4000 American Fidelity Assurance Company	SPACH3342	8/12/2025	Supplemental Employee Benefits 07/25	\$ 2,788.29
5800 University of Massachusetts	SPACH3343	8/12/2025	ELD Training (Administrative)	\$ 2,400.00
3922 Self Insured Schools of California	SPACH3344	8/12/2025	07/30 SISC Flex FSA Fees	\$ 2,757.41
1833 Amazon	SPACH3345	8/12/2025	student council supplies (Bubble Machine, Bodega cooler, etc..)	\$ 4,772.16
4343 Scoot Education Inc	SPACH3346	8/12/2025	126909 Substitutes	\$ 4,785.00
1833 Amazon	SPACH3347	8/12/2025	supplies for drama repair	\$ 5,235.90
1861 Hudl	SPACH3348	8/13/2025	Hudl Streaming Premium (Athletics)	\$ 13,000.00
2164 Golden Star Technology, Inc	SPACH3349	8/13/2025	Tech consultant services (Technology)	\$ 7,000.00
2445 Piece of Mind Care Services	SPACH3350	8/13/2025	Students Support Services 06-07/25 (English Language Development)	\$ 4,292.50

# EL CAMINO REAL CHARTER HIGH SCHOOL

## CHECK REGISTER

Checking Account 1796 A/P Account

August 2025

Total Amount: **\$1,118,879.29**

Name	Check Number	Date	Memo	Amount
1833 Amazon	SPACH3351	8/15/2025	Watt stopper DT- 205 Dual Technology Sensor (Technology)	\$ 510.30
1833 Amazon	SPACH3352	8/15/2025	TECHNOLOGY SUPPLIES	\$ 105.33
2643 Turnitin, LLC	SPACH3353	8/15/2025	25-26 Instructional Application Renewal: Turnitin (Feedback&Revision Assistant)	\$ 31,950.00
1833 Amazon	SPACH3354	8/15/2025	TECHNOLOGY SUPPLIES	\$ 223.67
1833 Amazon	SPACH3355	8/15/2025	55GSM shrink wrap (Technology)	\$ 197.52
3793 Softchoice Corporation	SPACH3356	8/17/2025	M365 EDU A5 subscription (Technology)	\$ 22,634.25
5802 FINALSITE	SPACH3357	8/19/2025	Google SSO (Technology)	\$ 15,850.00
1998 CDW LLC	SPACH3358	8/19/2025	HPE MSA Storage (Technology)	\$ 15,695.73
4343 Scoot Education Inc	SPACH3359	8/19/2025	Substitutes (Compliance Office)	\$ 4,486.00
5723 ABC Education Group	SPACH3360	8/20/2025	2025-2026 Tuition Refunds	\$ 38,000.00
2222 Inspire Communication, Inc	SPACH3361	8/25/2025	Speech-Language Services 07/25	\$ 1,020.00
3275 GoTo Communications, Inc.	SPACH3362	8/27/2025	GOTO connect standard- Monthly Service Charge 08/01 till 08/31/2025	\$ 2,705.39
2893 AWS (Amazon Web Services)	SPACH3363	8/27/2025	Administrative Subscription Renewal	\$ 2,161.88
4102 Allied Private Investigations & Security Services, LLC	SPACH3364	8/27/2025	Security Services 07/01-07/31/25	\$ 9,177.48
3926 Kami	SPACH3365	8/28/2025	Kami Plan Renewal - (PDF annotation, AI-powered assessment)	\$ 10,050.00
5809 Landmark Educational Tours, LLC	SPACH3366	8/29/2025	Youth Trip package (09/23 to 09/26/2025)- HBCU Tour Trip (Administrative)	\$ 74,912.00
1857 Aeries Software	SPACH3367	8/28/2025	Aeries Database Maintenance - IQ P00477 (Technology)	\$ 27,347.69

**EL CAMINO REAL CHARTER HIGH SCHOOL**  
**CHECK REGISTER**  
**General Account 1761 A/P Account**  
**July 2025**

Total Amount: **\$ 522,159.90**

Name	Check Number	Date	Memo	Amount
2006 CharterSafe	ACH250701-01	7/1/2025	CHARTERSAFE - July 2025	\$ 166,268.00
3480 PenServ Plan Services	ACH250708-01	7/8/2025	403(B) Funding 07-01-25-07-30-2025	\$ 40,574.41
2447 Purchase Power (Pitney Bowes)	ACH250714-01	7/14/2025	POSTAGE REFILL - July 2025	\$ 541.99
3923 Self Insured Schools of California	ACH250715-02	7/15/2025	SISC HEALTH-July 2026	\$ 311,957.59
2089 EDD (Employment Development Dept.)	ACH250721-01	7/21/2025	SUI Fund Pmt for July 2025	\$ 14.15
4001 Texas Life Insurance Company	ACH250721-02	7/21/2025	SM0F6Z20220714001 Supplemental Life insurance 07/21/25	\$ 432.50
3480 PenServ Plan Services	ACH250721-03	7/21/2025	403(B) Funding 07/01/25 - 07/31/25	\$ 444.26
1964 California Department of Tax & Fee Administration	ACH250728-01	7/28/2025	SALES & USE TAX - Q2 2025	\$ 1,927.00

**EL CAMINO REAL CHARTER HIGH SCHOOL**  
**KKL/ Trust Balance**  
**August 2025**

<b>ASB Account</b>	<b>9621 - Due to (From) School 1</b>
TRUST - A Capella (Vocal Royale)	\$ 872.28
TRUST - AVID	\$ 6,734.22
TRUST - AcaDeca	\$ 205.83
TRUST - Active Minds	\$ 34.88
TRUST - American Cancer (Relay)	\$ 679.82
TRUST - Athletic Director	\$ 93.80
TRUST - Band	\$ 19,898.38
TRUST - Baseball	\$ 31,951.56
TRUST - Beyond the Books	\$ 164.00
TRUST - Black Student U	\$ 2,282.37
TRUST - Boys Basketball	\$ 20,461.76
TRUST - Boys Golf	\$ 1,426.21
TRUST - Boys Lacrosse	\$ 9,915.61
TRUST - Boys Soccer	\$ 9,780.38
TRUST - Boys Tennis	\$ 147.76
TRUST - Boys Volleyball	\$ 1,900.18
TRUST - Boys Waterpolo	\$ 2,048.27
TRUST - Brett Schmit Memorial Fund	\$ 1,352.53
TRUST - CSF	\$ 33,905.67
TRUST - Cheerleaders	\$ 3,954.29
TRUST - Choir	\$ 14,440.98
TRUST - Claws for a Cause	\$ 17.88
TRUST - College Counseling	\$ 689.68
TRUST - Creative Writing	\$ 2,133.38
TRUST - Cross Country	\$ 5,469.80
TRUST - DECA	\$ 978.40
TRUST - Dance	\$ 8,460.09
TRUST - Drama	\$ 66,755.37
TRUST - Drill Team	\$ 345.25
TRUST - Football	\$ 20,756.28
TRUST - French Club	\$ 1,288.23
TRUST - Ganssle Memorial Schol	\$ 1,000.00
TRUST - Girls Basketball	\$ 3,806.26
TRUST - Girls Flag Football	\$ 8,885.14
TRUST - Girls Golf	\$ 1,618.10
TRUST - Girls Lacrosse	\$ 9,096.40
TRUST - Girls Soccer	\$ 1,167.28
TRUST - Girls Tennis	\$ 474.81
TRUST - Girls Volleyball	\$ 12,593.08
TRUST - Girls Water Polo	\$ 1,210.71
TRUST - Grad Class 2025	\$ 131,856.76
TRUST - Grad Class 2026	\$ 2,459.17
TRUST - Grad Class 2027	\$ 944.95
TRUST - Great Films Club	\$ 69.00
TRUST - Jewish Club	\$ 65.50
TRUST - KPOP Club	\$ 292.33
TRUST - Key Club	\$ 332.90
TRUST - La Familia	\$ 143.81
TRUST - Local Charity Outreach	\$ 92.00
TRUST - Medical Club	\$ 7,872.52
TRUST - Milton Goffman Scholarship	\$ 6,305.00
TRUST - Mock Trial	\$ 385.00
TRUST - Model United Natn	\$ 873.00
TRUST - NJROTC	\$ 50,623.00
TRUST - National Honors Soc	\$ 4,687.54
TRUST - Operation Smile	\$ 38.17
TRUST - Philosophy Club	\$ 41.00
TRUST - Physics Club	\$ 1,165.08
TRUST - Recycle for Research	\$ 378.82
TRUST - Robotics	\$ 7,032.03
TRUST - SURF CLUB	\$ 409.53
TRUST - Sand Volleyball	\$ (1,391.16) PER Alyssa Lee Check from Fundraising \$1,500
TRUST - Save the Waves	\$ 126.00
TRUST - Schship JHarrison	\$ 9,253.61
TRUST - Science Bowl	\$ 1,441.23
TRUST - Science National Honors Society	\$ 119.90

EL CAMINO REAL CHARTER HIGH SCHOOL  
KKL/ Trust Balance  
August 2025

TRUST - Softball	\$	16,719.12	
TRUST - Spanish Honor Soc	\$	440.70	
TRUST - Speech & Debate	\$	167.68	
TRUST - Step	\$	8,607.43	
TRUST - Student Council	\$	27,932.07	
TRUST - Swimming & Diving	\$	4,859.01	
TRUST - Thespians Club	\$	1,468.84	
TRUST - Track & Field	\$	(1,619.55)	emailed Colson Phillip regarding the trust deficiency
TRUST - UNICEF	\$	612.22	
TRUST - VAPA Scholarship	\$	2,608.52	
TRUST - Wrestling	\$	3,143.64	
TRUST - You Can Do This SCHLR	\$	500.00	
Trust - ECR School on Wheels	\$	38.00	
Trust - FLEX	\$	40.00	
Trust - Grad Class 2028	\$	587.75	
Trust - Journalism	\$	196.38	
Trust - Kiva Club	\$	109.76	
Trust - Project Paper Bag	\$	14.07	
Trust - Relay for life	\$	2,090.96	
<b>Total</b>	<b>\$</b>	<b>603,130.21</b>	







# Coversheet

## Review of August 2025 Credit Card Charges

<b>Section:</b>	IV. Finance
<b>Item:</b>	C. Review of August 2025 Credit Card Charges
<b>Purpose:</b>	Vote
<b>Submitted by:</b>	
<b>Related Material:</b>	IV.C. -August 2025 Hussey Credit Card Statement.pdf IV.C. -August 2025 Wood Credit Card Statement.pdf IV.C. -August 2025 Credit Card Details.pdf



U.S. BANCORP SERVICE CENTER  
P. O. Box 6343  
Fargo, ND 58125-6343



000209338 01 SP 106481489672705 S

DAVID HUSSEY  
EL CAMINO REAL CHS  
5440 VALLEY CIRCLE BLVD  
WOODLAND HILLS CA 91367-5949

## EL CAMINO REAL CHS

ACCOUNT NUMBER 4866-9110-0013-3507

STATEMENT DATE 08-25-25

TOTAL ACTIVITY \$ 19,556.43

**"MEMO STATEMENT ONLY"**  
**DO NOT REMIT PAYMENT**

## NEW ACCOUNT ACTIVITY

POST DATE	TRAN DATE	TRANSACTION DESCRIPTION	REFERENCE NUMBER	MCC	AMOUNT
08-01	07-31	METRICS GROUP LLC 180-07550452 FL PUR ID: ch3r3hbkv1kim2x0 TAX: 0.00	24000775213100007242900	7379	2,000.00
08-01	07-31	FACEBK *ZA852XLSQ2 650-5434800 CA PUR ID: 420429000200589 TAX: 0.00	24204295212000604195044	7311	49.10
08-01	07-31	FACEBK *LNHM7WURQ2 650-5434800 CA PUR ID: 420429000200589 TAX: 0.00	24204295212000903170086	7311	599.17
08-04	08-01	GOOGLE*CLOUD KLQHLH CC GOOGLE.COM CA PUR ID: V1163510325357157 TAX: 0.00	24803945214920021090283	4816	45.19
08-11	08-08	TST*CALIFORNIA CHICKEN C 818-716-6170 CA PUR ID: YaJrGp6rJB+mIIYoq TAX: 195.00	24692165220103266040666	5812	2,195.00
08-13	08-13	ALGOLIA 2U2508716010 ALGOLIA.COM CA PUR ID: ch3vkct07crhhx TAX: 0.00	24011345225100048514080	5734	305.00
08-13	08-12	MAILCHIMP 678-9990141 GA PUR ID: 5831486-24793275-us2 TAX: 0.00	24793385224000703615076	5818	534.00
08-18	08-15	CONCORD THEATRICALS CORP. NEW YORK NY PUR ID: 00000002747002047 TAX: 0.00	24393495227018283206072	5999	3,845.67
08-18	08-17	POWTOON.COM STANMORE PUR ID: 971563 TAX: 0.00	74208475230100001051639	5734	240.00
08-19	08-19	METRICS GROUP LLC FORM-METRICS. FL PUR ID: in1RxgjYGMVVJkvPISssN3Bs TAX: 0.00	24000775231100012145716	7379	300.00
08-19	08-18	FACEBK *ETGYPXQSQ2 650-5434800 CA PUR ID: 420429000200589 TAX: 0.00	24204295230000503340061	7311	900.00
08-22	08-22	THE SHERWIN-WILLIAMS COMP CLEVELAND OH PUR ID: 479338001681970 TAX: 0.00	24793385234000838571051	5231	3,262.22

## Default Accounting Code:

Default Accounting Code:				
CUSTOMER SERVICE CALL  800-344-5696	ACCOUNT NUMBER  4866-9110-0013-3507		ACCOUNT SUMMARY	
	STATEMENT DATE  08-25-25	DISPUTED AMOUNT  \$ .00	PREVIOUS BALANCE \$0.00	
SEND BILLING INQUIRIES TO:  C/O U.S. BANCORP SERVICE CENTER, INC U.S. BANK NATIONAL ASSOCIATION P.O. BOX 6335 FARGO, ND 58125-6335	AMOUNT DUE  \$ 0.00  DO NOT REMIT		PURCHASES & OTHER CHARGES \$19,556.43	
			CASH ADVANCES \$0.00	
			CASH ADVANCE FEE \$0.00	
			CREDITS \$0.00	
			TOTAL ACTIVITY \$19,556.43	



Account Name:	DAVID HUSSEY
Company Name:	EL CAMINO REAL CHS
Account Number:	4866-9110-0013-3507
Statement Date:	08-25-25

NEW ACCOUNT ACTIVITY						
POST DATE	TRAN DATE	TRANSACTION DESCRIPTION	REFERENCE NUMBER	MCC	AMOUNT	
08-25	08-21	SOUTHWES 5262379713661 800-435-9792 TX ANTHONY/PILE DEPARTURE: 10-02-25 LAX WN V LAS WN V TUS WN V LAS WN V LAX	24692165234106276647531	3066	5,281.08	



U.S. BANCORP SERVICE CENTER  
P. O. Box 6343  
Fargo, ND 58125-6343



000209339 01 SP 106481489672706 S

GREGORY WOOD  
EL CAMINO REAL CHS  
5440 VALLEY CIRCLE BLVD  
WOODLAND HILLS CA 91367-5949

## EL CAMINO REAL CHS

ACCOUNT NUMBER 4866-9133-3444-7280

STATEMENT DATE 08-25-25

TOTAL ACTIVITY \$ 7,497.50

"MEMO STATEMENT ONLY"  
DO NOT REMIT PAYMENT

## NEW ACCOUNT ACTIVITY

POST DATE	TRAN DATE	TRANSACTION DESCRIPTION	REFERENCE NUMBER	MCC	AMOUNT
07-28	07-25	SMARTANDFINAL 409 510-851-8548 CA PUR ID: 20692139 TAX: 7.10	24231685206419450009058	5411	79.96
07-28	07-25	SMARTANDFINAL 409 510-851-8548 CA PUR ID: 20692141 TAX: 0.99	24231685206419450009074	5411	11.09
07-28	07-25	SMARTANDFINAL 409 510-851-8548 CA PUR ID: 20692142 TAX: 11.19	24231685206419450009082	5411	125.98
07-29	07-28	YOU CAN BOOK.ME BEDFORD PUR ID: TAX: 0.00	74208475210100003812883	7399	134.40
07-31	07-30	SMARTANDFINAL 408 510-851-8548 CA PUR ID: 21197133 TAX: 14.62	24231685211425180002464	5411	164.51
08-04	08-01	MOSYLE COR* MOSYLE_MAN MOSYLE.COM FL PUR ID: ch3r8069gqk02kd6 TAX: 0.00	24492165213100049403584	5734	12.00
08-04	08-04	AGUAVIDA PREMIUM WATER 747-444-9637 CA PUR ID: 00000000000000000000 TAX: 30.90	24692165216102155256041	5999	347.90
08-05	08-04	EB *46TH ANNUAL CCAC C 801-413-7200 CA PUR ID: 12981747203 TAX: 0.00	24036295216716033505798	7399	494.05
08-06	08-05	NYLAS NYLAS.COM CA PUR ID: 63125 TAX: 0.00	24064665218100003005260	5734	495.78
08-06	08-04	SOUTHWES 5262373939191 800-435-9792 TX DOMINGUEZ/MARISSA DEPARTURE: 11-04-25 BUR WN Z SMF WN Z BUR	24692165217100728931032	3066	213.27
08-07	08-05	365 DISPOSAL AND RECYCLIN SUN VALLEY CA	74013395217001020000213	4900	500.00 CR
08-07	08-06	365 DISPOSAL AND RECYCLIN 888-4830836 CA PUR ID: 5440 Valley Circle Blvd TAX: 0.00	24013395218001236008392	4900	575.00

## Default Accounting Code:

CUSTOMER SERVICE CALL  800-344-5696	ACCOUNT NUMBER  4866-9133-3444-7280		ACCOUNT SUMMARY	
	STATEMENT DATE  08-25-25	DISPUTED AMOUNT  \$ .00	PREVIOUS BALANCE	\$ .00
SEND BILLING INQUIRIES TO:  C/O U.S. BANCORP SERVICE CENTER, INC U.S. BANK NATIONAL ASSOCIATION P.O. BOX 6335 FARGO, ND 58125-6335	AMOUNT DUE  \$ 0.00  DO NOT REMIT		PURCHASES & OTHER CHARGES	\$8,673.60
			CASH ADVANCES	\$ .00
			CASH ADVANCE FEE	\$ .00
			CREDITS	\$1,176.10
			TOTAL ACTIVITY	



Account Name:	GREGORY WOOD
Company Name:	EL CAMINO REAL CHS
Account Number:	4866-9133-3444-7280
Statement Date:	08-25-25

## NEW ACCOUNT ACTIVITY

POST DATE	TRAN DATE	TRANSACTION DESCRIPTION	REFERENCE NUMBER	MCC	AMOUNT
08-07	08-06	365 DISPOSAL AND RECYCLIN 888-4830836 CA PUR ID: 5440 Valley Circle Blvd TAX: 0.00	24013395218001236008442	4900	500.00
08-07	08-06	SMARTANDFINAL 409 510-851-8548 CA PUR ID: 21804203 TAX: 23.64	24231685218433339007031	5411	266.10
08-11	08-08	SMARTANDFINAL 408 510-851-8548 CA PUR ID: 22006152 TAX: 6.23	24231685220435709009402	5411	70.07
08-11	08-08	SMARTANDFINAL 408 510-851-8548 CA PUR ID: 22006154 TAX: 14.65	24231685220435709009410	5411	164.85
08-11	08-07	PORTO'S BAKERY NORTHR GLENDALE CA PUR ID: 8188463586 TAX: 210.62	24941685220187949629702	5812	2,216.35
08-13	08-11	365 DISPOSAL AND RECYCLIN SUN VALLEY CA	74013395223002277001609	4900	376.52 CR
08-14	08-13	SMARTANDFINAL 409 510-851-8548 CA PUR ID: 22511176 TAX: 27.45	24231685225441449004104	5411	309.02
08-15	08-14	SMARTANDFINAL 409 510-851-8548 CA PUR ID: 22612139 TAX: 18.02	24231685226442612002692	5411	202.83
08-15	08-14	SMARTANDFINAL 409 510-851-8548 CA PUR ID: 22612141 TAX: 26.61	24231685226442612002718	5411	299.58
08-15	08-14	AMERICAN RED CROSS 800-733-2767 DC PUR ID: TP0012209634 TAX: 0.00	24692165226109064083802	8398	360.00
08-15	08-14	AMERICAN RED CROSS 800-733-2767 DC PUR ID: TP0012209848 TAX: 0.00	24692165226109064084149	8398	160.00
08-18	08-18	AGUAVIDA PREMIUM WATER 747-444-9637 CA PUR ID: 00000000000000000000 TAX: 30.90	24692165230102014391494	5999	347.90
08-20	08-19	SMARTANDFINAL 409 510-851-8548 CA PUR ID: 23117148 TAX: 25.57	24231685231448404003544	5411	287.87
08-21	08-20	SMARTANDFINAL 409 SMARTANDFINAL CA PUR ID: 4564971 TAX: 26.61	74231685232449543009610	5411	299.58 CR
08-22	08-21	SMARTANDFINAL 409 510-851-8548 CA PUR ID: 23319189 TAX: 33.17	24231685233450710003844	5411	373.32
08-25	08-22	SMARTANDFINAL 409 510-851-8548 CA PUR ID: 23420155 TAX: 29.92	24231685234451892011976	5411	336.76
08-25	08-22	SMARTANDFINAL 409 510-851-8548 CA PUR ID: 23420156 TAX: 11.11	24231685234451892011984	5411	125.01

**ECRCHS  
CREDIT CARD DETAILS  
August 2025**

<b>Total Amount</b>	<b>\$ 27,053.93</b>
---------------------	---------------------

Vendor	Date	PO#	Description of Expense	Cardholder	Requested By	Amount	Resource	Budget Category
METRICS GROUP LLC	7/31/2025	P00642	Technology Subscription	DAVID HUSSEY	R.Guinto	\$ 2,000.00	General Technology	General Technology
FACEBK *ZA852XLSQ2	7/31/2025	P00181	Marketing	DAVID HUSSEY	R.Covarrubias	\$ 49.10	General Technology	General Technology
FACEBK *LNHM7WURQ2	7/31/2025	P00181	Marketing	DAVID HUSSEY	R.Covarrubias	\$ 599.17	General Technology	General Technology
GOOGLE*CLOUD KLQLH	8/1/2025	P00190	Technology Subscription	DAVID HUSSEY	R.Covarrubias	\$ 45.19	General Technology	General Technology
TST*CALIFORNIA CHICKEN C	8/8/2025	P00661	PD-Fist day of Work Lunch	DAVID HUSSEY	C.Philip	\$ 2,195.00	General	General
MAILCHIMP	8/12/2025	PO12707	Technology Subscription	DAVID HUSSEY	S.Jaquez	\$ 534.00	General Technology	General Technology
ALGOLIA 2U2508716010	8/13/2025	P00188	Technology Subscription	DAVID HUSSEY	R.Guinto	\$ 305.00	General Technology	General Technology
CONCORD THEATRICALS CORP.	8/15/2025	P00653	Drama-Play Production	DAVID HUSSEY	H.Hutson	\$ 3,845.67	9150-Trust -Drama	9150-Trust -Drama
POWTOON.COM	8/17/2025	po9348	Technology Subscription	DAVID HUSSEY	R.Guinto	\$ 240.00	General Technology	General Technology
FACEBK *ETGYPXQSQ2	8/18/2025	P00181	Marketing	DAVID HUSSEY	R.Covarrubias	\$ 900.00	General Technology	General Technology
METRICS GROUP LLC	8/19/2025	P00496	Technology Subscription	DAVID HUSSEY	R.Guinto	\$ 300.00	General Technology	General Technology
SOUTHWES 5262379713661	8/21/2025	P00252	NJROTC Competition	DAVID HUSSEY	R.Flahearity	\$ 5,281.08	9150Trust-NJROTC	9150Trust-NJROTC
THE SHERWIN WILLIAMS	8/22/2025	PO11467	Facilities Paint	DAVID HUSSEY	Christopher Canales	\$ 3,262.22	General Operations	General Operations
<b>HUSSEY TOTAL</b>						<b>\$ 19,556.43</b>		

**ECRCHS**  
**CREDIT CARD DETAILS**  
**August 2025**

Vendor	Date	PO#	Description of Expense	Cardholder	Requested By	Amount	Resource	Budget Category
SMARTANDFINAL 409	7/25/2025	PO12073	CTE-Cooking Class	GREGORY WOOD	N.GAMEZ	\$ 79.96	CTE	CTE
SMARTANDFINAL 409	7/25/2025	PO12073	CTE-Cooking Class	GREGORY WOOD	N.GAMEZ	\$ 11.09	CTE	CTE
SMARTANDFINAL 409	7/25/2025	PO12073	CTE-Cooking Class	GREGORY WOOD	N.GAMEZ	\$ 125.98	CTE	CTE
YOUCANBOOK.ME	7/28/2025	PO11636	Clerical Calendar	GREGORY WOOD	A.RIOS	\$ 134.40	General	General
SMARTANDFINAL 408	7/30/2025	PO12073	CTE-Cooking Class	GREGORY WOOD	N.GAMEZ	\$ 164.51	CTE	CTE
MOSYLE COR* MOSYLE_MAN	8/1/2025	PO0190	Technology Subscription	GREGORY WOOD	R.Guinto	\$ 12.00	General Technology	General Technology
AGUAVIDA PREMIUM WATER	8/4/2025	PO12758	All Staff Water	GREGORY WOOD	G.PAEZ	\$ 347.90	General	General
EB *46TH ANNUAL CCAC C	8/4/2025	PO0640	Human Resource-Conference	GREGORY WOOD	M.Dominguez	\$ 494.05	General	General
SOUTHWES 5262373939191	8/4/2025	PO0640	Human Resource-Conference	GREGORY WOOD	M.Dominguez	\$ 213.27	General	General
NYLAS	8/5/2025	PO0590	Technology Subscription	GREGORY WOOD	R.Guinto	\$ 495.78	General Technology	General Technology
365 DISPOSAL AND RECYCLIN	8/5/2025	P00005	Building & Ground	GREGORY WOOD	R.Guinto	\$ (500.00)	General Operations	General Operations
365 DISPOSAL AND RECYCLIN	8/6/2025	P00005	Building & Ground	GREGORY WOOD	R.Guinto	\$ 575.00	General Operations	General Operations
365 DISPOSAL AND RECYCLIN	8/6/2025	P0005	Building & Ground	GREGORY WOOD	R.Guinto	\$ 500.00	General Operations	General Operations
SMARTANDFINAL 409	8/6/2025	PO12073	CTE-Cooking Class	GREGORY WOOD	N.GAMEZ	\$ 266.10	CTE	CTE
PORTO'S BAKERY NORTHRI	8/7/2025	PO0346	PD-Back to work Lunch	GREGORY WOOD	C.Philip	\$ 2,216.35	General	General
SMARTANDFINAL 408	8/8/2025	PO12073	CTE-Cooking Class	GREGORY WOOD	N.GAMEZ	\$ 70.07	CTE	CTE
SMARTANDFINAL 408	8/8/2025	PO12073	CTE-Cooking Class	GREGORY WOOD	N.GAMEZ	\$ 164.85	CTE	CTE
365 DISPOSAL AND RECYCLIN	8/11/2025	P00005	Building & Ground	GREGORY WOOD	R.Guinto	\$ (376.52)	General Operations	General Operations
SMARTANDFINAL 409	8/13/2025	PO12073	CTE-Cooking Class	GREGORY WOOD	N.GAMEZ	\$ 309.02	CTE	CTE
SMARTANDFINAL 409	8/14/2025	PO12073	CTE-Cooking Class	GREGORY WOOD	N.GAMEZ	\$ 202.83	CTE	CTE
SMARTANDFINAL 409	8/14/2025	PO12073	CTE-Cooking Class	GREGORY WOOD	N.GAMEZ	\$ 299.58	CTE	CTE
AMERICAN RED CROSS	8/14/2025	PO11774	All Coaches Certifications	GREGORY WOOD	L.Paz	\$ 360.00	General Operations	General Operations
AMERICAN RED CROSS	8/14/2025	PO11774	All Coaches Certifications	GREGORY WOOD	L.paz	\$ 160.00	General Operations	General Operations
AGUAVIDA PREMIUM WATER	8/18/2025	PO12758	All Staff Water	GREGORY WOOD	G.PAEZ	\$ 347.90	General	General
SMARTANDFINAL 409	8/19/2025	PO12073	CTE-Cooking Class	GREGORY WOOD	N.GAMEZ	\$ 287.87	CTE	CTE
SMARTANDFINAL 409	8/20/2025	PO12073	CTE-Cooking Class	GREGORY WOOD	N.GAMEZ	\$ (299.58)	CTE	CTE
SMARTANDFINAL 409	8/21/2025	PO12073	CTE-Cooking Class	GREGORY WOOD	N.GAMEZ	\$ 373.32	CTE	CTE
SMARTANDFINAL 409	8/22/2025	PO12073	CTE-Cooking Class	GREGORY WOOD	N.GAMEZ	\$ 336.76	CTE	CTE
SMARTANDFINAL 409	8/22/2025	PO12073	CTE-Cooking Class	GREGORY WOOD	N.GAMEZ	\$ 125.01	CTE	CTE
WOOD TOTAL						\$ 7,497.50		



# Coversheet

## Approval of the Arts, Music, & Instructional Materials Block Grant

<b>Section:</b>	IV. Finance
<b>Item:</b>	D. Approval of the Arts, Music, & Instructional Materials Block Grant
<b>Purpose:</b>	Vote
<b>Submitted by:</b>	
<b>Related Material:</b>	9-16-2025 AMIM and Prop 28 Board Presentation.pdf



# **Arts, Music, and Instructional Materials (AMIM) Block Grant Plan & Prop 28 (Arts & Music in Schools Act)**

**2025-2026**

# AMIM vs. Prop 28 Funding Comparison

Feature	AMIM (Arts, Music & Instructional Materials Block Grant)	Prop 28 (Arts & Music in Schools Act)
Origin	AB 181 (2022 state budget)	CA Voter Initiative (2022)
Funding Type	<b>One-time discretionary block grant</b>	<b>Permanent annual allocation</b>
Duration	Through <b>June 30, 2026</b> only	<b>Ongoing every year</b>
Allocation Basis	Flat amount per LEA (size-based)	1% of prior year <b>Prop 98 GF</b> revenues: 70% based on ADA 30% based on unduplicated pupils  Year 1 - \$482,000 Year 2 - \$424,673 Year 3 - \$472,539
Total Amount	\$2,176,757.00	Dedicated to <b>arts education only</b>
Primary Purpose	Broad educational support (arts + other)	
Allowable Uses	5 broad categories: 1. Standards-aligned PD & materials 2. PD for school climate 3. Diverse/multilingual libraries 4. Operational costs (retirement, healthcare) 5. COVID-19 safety costs	Must be <b>arts education</b> : <ul style="list-style-type: none"><li>• 80% staff (teachers/aides)</li><li>• 20% materials, supplies, training, partnerships</li></ul>
Flexibility	Very flexible — can cover staffing, facilities, operations, tech	Narrowly restricted — <b>supplemental arts only</b>
Carryover	Allowed until June 30, 2026	Allowed, but must remain for arts purposes
Accountability	Local control; board approval; transparency required in plan	Strict reporting: <ul style="list-style-type: none"><li>• Public plan posted online</li><li>• Annual reporting to CDE</li><li>• Show expansion of arts access</li></ul>
Charter Schools	Receive proportionate allocation	Receive funds directly, same 80/20 rules apply
Key Goal	One-time <b>recovery &amp; flexibility</b> post-COVID	<b>Permanent expansion of arts staffing &amp; programs</b>







# Key Takeaway

## **AMIM (Block Grant)**

 Established: AB 181 (2022)

 \$2,176,757.00 (one-time)

 Ends June 30, 2026

 Flexible funding: arts, PD, libraries, school climate, ops, COVID safety

 Broad use, short-term recovery focus



## **Prop 28 (Ongoing)**

 Voter Initiative (2022)

 \$4XX,XXX annually

 Permanent (every year)

 Arts-only funding:

- 80% staff (teachers/aides)
- 20% supplies & partnerships







 Must supplement, not replace

 Public plans + annual CDE reporting



# ECRCHS Arts, Music, and Instructional Materials Plan 2025–26

## AMIM Goals

-  Enhancement of VAPA Programs
-  Provide and maintain instruments for our students
-  Theater & multipurpose hall lighting, stage, and audio/video upgrades
-  Professional Development opportunities
-  Facilities improvement for Visual Arts, Music, and school events
-  Upgrade classroom technology impacting all subject areas
-  Expansion of other programs

## AMIM Plan

-  Get teacher & student buy-in through surveys and outreach
-  Provide equity so funds benefit all students & the school community
-  Prioritize based on impact to program enhancement & student achievement
-  Ensure transparency with timely stakeholder updates
-  Present finalized plan for board approval in **October regular board meeting**

# Proposition 28 – Vote Item



- California *Education Code* (EC) Section 8820(g)(4)—Local Educational Agencies (LEAs) must have this annual report board approved, submitted to the California Department of Education (CDE), and posted to the LEA's website.
- The report includes the number of full-time equivalent teachers, classified personnel, and teaching aides; the number of pupils served; and the number of school sites providing arts education programs with AMS funds (worksheet on next slide).

# Proposition 28 – Expenditure



2025-26 Prop 28 Grant Budget											
2025-26 Staff		EE Status	Hr Rate	Calendar Days	Annual Salary	PERS/PARS	OASDI		Statutory Benefits	Health Ins	Total
							SS/Medicare	UI, WC			
Tech Director	FT + Benefits		35.77	234	\$ 66,961.44	\$ 17,952.36	\$ 5,122.55	\$ 1,004.42	\$ 24,079.33	\$ 20,563.00	\$ 111,603.77
Asst Music Director	FT + Benefits		32.17	213	\$ 54,817.68	\$ 14,696.62	\$ 4,193.55	\$ 822.27	\$ 19,712.44	\$ 20,563.00	\$ 95,093.12
Visual Arts Asst	FT + Benefits		22.86	213	\$ 38,953.44	\$ 10,443.42	\$ 2,979.94	\$ 584.30	\$ 14,007.66	\$ 20,563.00	\$ 73,524.10
Asst Theatre Director	PT 25 hrs/wk, No Benefits		34.44	213	\$ 36,678.60	\$ 1,283.75	\$ 531.84	\$ 550.18	\$ 2,365.77	\$ -	\$ 39,044.37
VAPA Asst	PT 20-30 hrs/wk, No Benefits		22.86	213	\$ 29,215.08	\$ 1,022.53	\$ 423.62	\$ 438.23	\$ 1,884.37	\$ -	\$ 31,099.45
Band Tech Asst	PT 20-30 hrs/wk, No Benefits		21.79	213	\$ 27,847.62	\$ 974.67	\$ 403.79	\$ 417.71	\$ 1,796.17	\$ -	\$ 29,643.79
Band Tech Asst	PT 20-30 hrs/wk, No Benefits		21.79	213	\$ 27,847.62	\$ 974.67	\$ 403.79	\$ 417.71	\$ 1,796.17	\$ -	\$ 29,643.79
Band Tech Asst	PT 20-30 hrs/wk, No Benefits		21.79	213	\$ 27,847.62	\$ 974.67	\$ 403.79	\$ 417.71	\$ 1,796.17	\$ -	\$ 29,643.79
Total Proposed											\$ 439,296.19
80% of total allocated											\$ 377,660.00
Job currently posted											
2025-26 Other Expenditures		Expenditure Category									Total
Music Program	Field Trip										\$ 20,000.00
Arts Program	Materials/Equipment										\$ 20,000.00
Band/Audio Production Program	Field Trip										\$ 30,000.00
Theatre Program	Materials/Equipment										\$ 60,000.00
Total Proposed											\$ 130,000.00
20% of total allocated											\$ 94,400.00
Total Entitlement-Prop 28											\$ 472,000.00
YR	Allocation	80% Staff	20% Other								
23-24	\$ 482,000.00	\$ 385,600.00	\$ 96,400.00								
24-25	\$ 424,000.00	\$ 339,200.00	\$ 84,800.00								
25-26	\$ 472,000.00	\$ 377,600.00	\$ 94,400.00								
	\$ 1,378,000.00	\$ 1,102,400.00	\$ 275,600.00								

# Coversheet

## Discussion and Update on Arbiter Pay

<b>Section:</b>	V. School Business
<b>Item:</b>	A. Discussion and Update on Arbiter Pay
<b>Purpose:</b>	Discuss
<b>Submitted by:</b>	
<b>Related Material:</b>	Arbiter Pay Contract.pdf





Subscription Order Form

Company Address	9815 S Monroe St, STE 204 Sandy, Utah 84070 United States	Expiration Date	
Created Date	09/04/2025	Quote Number	00692361
Prepared By	Shelby Aelvoet	Contract Length	1 Year
Phone		Start Date	10/01/2025
Email	shelby.aelvoet@arbitersports.com	End Date	09/30/2026
Billing Schedule	One-Time	Term Months	

Customer Billing

Account Name	El Camino Real Charter High School	Primary Contact	Fernando Delgado
Billing Contact	Fernando Delgado	Primary Title	Chief Operating Officer
Billing Email	f.delgado@ecrchs.net	Primary Email	f.delgado@ecrchs.net
Billing Phone	(818) 595-7500	Primary Phone	(818) 595-7500
Billing Address	5440 Valley Circle Boulevard Los Angeles, California, United States 91367	Shipping Address	5440 Valley Circle Blvd Woodland Hills, California, United States 91367-5996

Subscription Services

Subscription Services Year 1: 10/1/2025 to 9/30/2026				
Description	Qty	Unit Price	Notes	Year 1 Fees
300- (YEAR 1) ArbiterPay	1.00	\$3,060.00		\$3,060.00
Year 1 Payment Due	10/31/2025	Year 1 Total		\$3,060.00

Year Grand Total (does not include applicable taxes):	\$3,060.00
---	------------

Contract Total

Subtotal	\$3,060.00
Grand Total	\$3,060.00

Payment Remit Information

**Invoice Payment Remit Address:** ArbiterSports, LLC, 9815 S Monroe Street, Ste 204, Sandy, UT 84070

**Electronic Payment Website:** (please send requests for VersaPay payment links to):  
receivables@arbitersports.com

**Wire/ACH Instructions:** Bank Name: Chase Bank  
ACH Bank Routing/ABA#: 124001545  
Wire Bank Routing/ABA#: 021000021  
Account #: 670352696  
Name on Account: ArbiterSports, LLC  
Account Address: 9815 S Monroe Street, Ste 204 Sandy, UT 84070  
Telephone Number: (801) 576-1251  
Fax Number: (801) 748-3536  
Reference Notes: ArbiterSports.com Invoice  
# \_\_\_\_\_

**ArbiterPay Account:** For ArbiterPay renewals or if you are a current ArbiterPay user purchasing additional Arbiter products, you may provide your ArbiterPay Account number below and payment can be withdrawn using your ArbiterPay account funds.  
Pay Account # \_\_\_\_\_

### Terms and Conditions

1. This Subscription Order Form is governed by ArbiterSports website's standard Terms and Conditions ("Terms and Conditions") <https://www.arbitersports.com/terms-and-conditions/>. If Customer is subscribing to ArbiterPay, by ArbiterSports' standard Payor Agreement for ArbiterPay Users (the "ArbiterPay Agreement") <https://www.arbiterpay.com/s/Payor-Agreement-20210510.pdf> (if applicable), each incorporated herein by reference.
2. In the event of any conflict or inconsistency between the Special Instructions or Standard Conditions of this Subscription Order Form and any provisions of the Terms and Conditions or the ArbiterPay Agreement, this Subscription Order Form shall govern and control.
3. Notwithstanding any provision of the Terms and Condition or the ArbiterPay Agreement, upon a material breach by ArbiterSports which is not cured within 30 days following receipt of written notice, Customer may terminate its subscription and receive the prorated amount paid by Customer for the applicable year.
4. The Terms and Conditions and the ArbiterPay Agreement (if applicable), together with this Subscription Order Form, represent the entire agreement between the parties and cannot be overridden by terms contained in any later received document unless the additional terms are accepted in writing by both parties.
5. All references to monetary values shall mean United States dollars and do not include any taxes that may apply.
6. Customer must provide arbitersports with valid automated payment information as a condition to receive or use the services. By providing arbitersports with automated payment information, customer authorizes arbitersports to charge customer's payment account for any amounts arising from or relating to the above services without further authorization from customer. Customer is responsible for and agrees to update arbitersports with any changes to customer's billing and/or automated payment information (e.G., new or updated credit card, credit card expiration date or other payment bank account information)
7. Customer authorizes arbitersports to charge customer's arbitersports account for any amounts arising from or relating to the above services without further authorization from customer.

8. Unless customer notifies arbitersports in writing (including via the above arbitersports email address) 10 days prior to the end of customer's subscription, customer's subscription will automatically renew for an additional term equal to the length of the original term (for example, a two-year term will automatically renew for an additional two-year term). If arbitersports increases the annual subscription price for any services, arbitersports will notify customer in writing (including via the abovecustomer email address) of such increase at least 30 days prior to the end of customer's subscription. In the event customer does not terminate, the renewal will be at the increased price
9. I hereby authorize ArbiterSports, LLC to initiate a withdrawal from my account within ArbiterPay to pay for services as indicated. I also authorize ArbiterSports, LLC to make deposits to this account in the event that an entry is made in error. I agree that no prior notification will be provided unless the date or amount changes, in which case you will receive notice at least 10 days prior to the payment being collected.

### Customer to Complete:

Is a Purchase Order required for ArbiterSports to receive payment for the Services in this Subscription Order Form? Please fill in **YES** or **NO** here:

**YES**

### Acknowledgment and Acceptance of Terms

By signing this Subscription Order Form, the individual signing on behalf of Customer is committing and confirming that they are authorized by Customer to execute this Subscription Order Form and to purchase the Service listed above.

#### Accepted By (Legal Entity):

El Camino Real Charter High School

#### Signature:

Signed by:

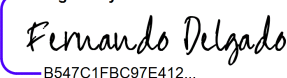
  
B547C1FBC97E412...

#### Print Name:

Fernando Delgado

#### Title:

Chief Operating Officer

#### Date:

9/16/2025

#### Accepted By (Legal Entity):

ArbiterSports, LLC

#### Signature:

Signed by:

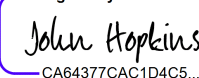
  
CA64377CAC1D4C5...

#### Print Name:

John Hopkins

#### Title:

Chief Financial Officer

#### Date:

9/16/2025

# Coversheet

## Approval for Request to Increase Budget for the Digital Marquee and Front / Corner Monument Project

**Section:** V. School Business  
**Item:** B. Approval for Request to Increase Budget for the Digital Marquee and Front / Corner Monument Project  
**Purpose:** Vote  
**Submitted by:**  
**Related Material:** Budget Increase Proposal For Digital Marquee.pdf  
Digital Marquee.pdf  
Front Letter and corner signs.pdf

## Budget for the Digital Marquee

### 23-24 Capitalization Project Budget

Kardent Architect/ DSA approval	\$28,000
---------------------------------	----------

### 24-25 Capitalization Project Budget

LAUSD Oversight	\$75,341
-----------------	----------

---

<b>Total Spent</b>	<b>\$103,341</b>
--------------------	------------------

### 25-26 Capitalization Project Budget

Digital Marquee	\$176,857
-----------------	-----------

Corner Monument & ECR Planter	\$73,483.63
-------------------------------	-------------

LAUSD Electrical wok - (Estimate)	\$75,000
-----------------------------------	----------

---

<b>Total 25'-26'</b>	<b>\$325,341</b>
----------------------	------------------

<b>Total Project Cost</b>	<b>\$428,682</b>
---------------------------	------------------

Budget Carry-Over	\$219,543.57
-------------------	--------------

---

Proposed budget increase	\$105,797.06
--------------------------	--------------

+ 20% Contingencies	\$21,159.41
---------------------	-------------

Total Budget Increase	\$126,956.47
-----------------------	--------------

📍 3520 Valhalla Dr  
Burbank, CA, 91505  
☎ 844-833-1188  
✉ hello@frontsigns.com  
🌐 https://www.frontsigns.com

Contractors Lic. #C45-1053708

 Underwriters Laboratories # E508823

Once you approve the digital proof for your project, we are not responsible for any misspellings, typos or mistakes that occurred in your final product. Errors that we are not responsible for include, but are not limited to: any spelling, graphics, grammar, punctuation, alignment mistakes that are approved by the customer.

#### Description

### Exterior Illuminated Monument sign

Front view

Side view

Back view

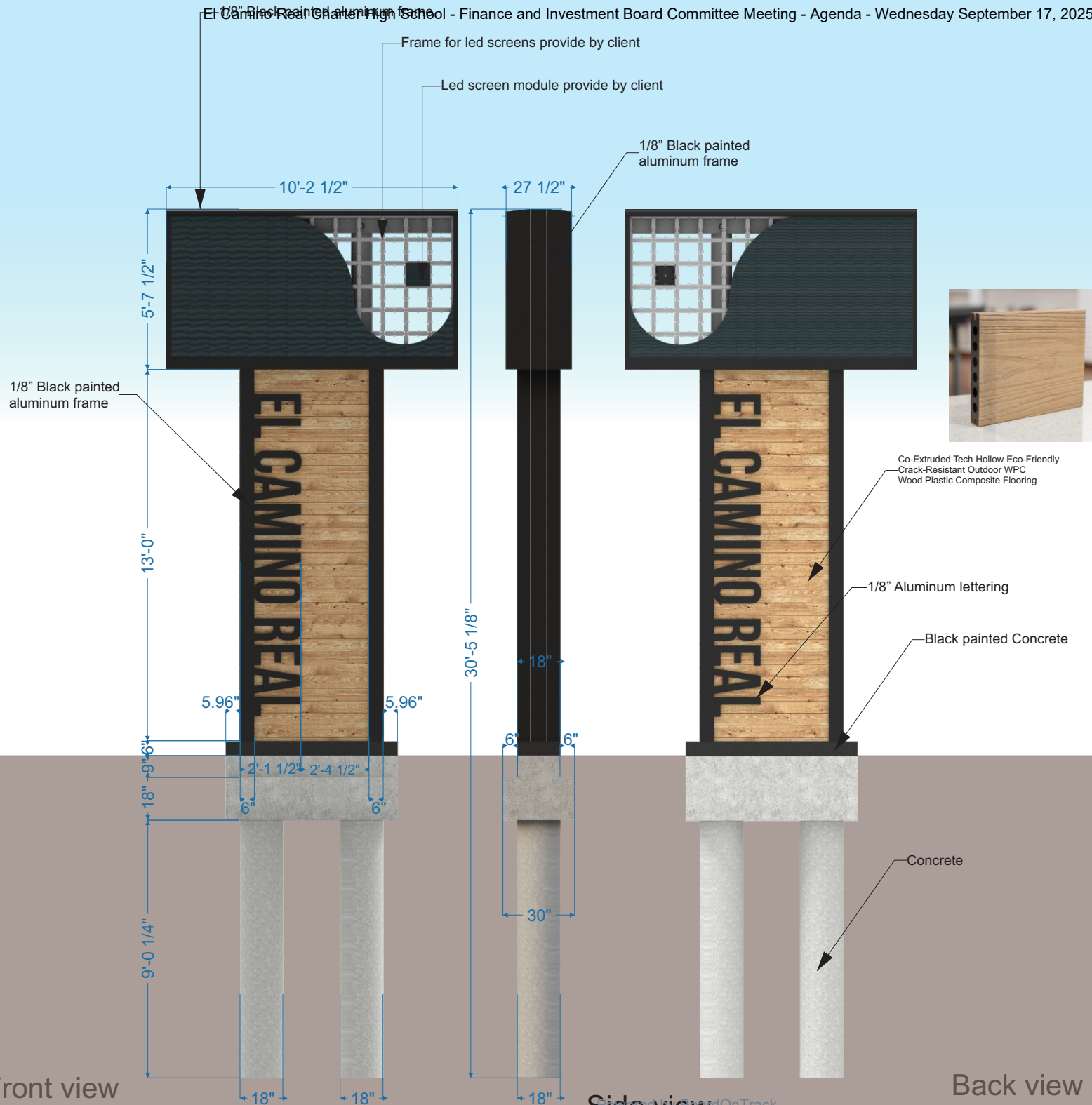



📍 3520 Valhalla Dr  
Burbank, CA, 91505  
☎ 844-833-1188  
✉ hello@frontsigns.com  
🌐 <https://www.frontsigns.com>

Contractors Lic. #C45-1053708

 Underwriters Laboratories # E508823

*Once you approve the digital proof for your project, we are not responsible for any misspellings, typos or mistakes that occurred in your final product. Errors that we are not responsible for include, but are not limited to: any spelling, graphics, grammar, punctuation, alignment mistakes that are approved by the customer.*

Description

**Exterior Illuminated Monument sign**  
**3D Visualization**





📍 3520 Valhalla Dr  
Burbank, CA, 91505  
☎ 844-833-1188  
✉ hello@frontsigns.com  
🌐 <https://www.frontsigns.com>

Contractors Lic. #C45-1053708  
 Underwriters Laboratories # E508823

*Once you approve the digital proof for your project, we are not responsible for any misspellings, typos or mistakes that occurred in your final product. Errors that we are not responsible for include, but are not limited to: any spelling, graphics, grammar, punctuation, alignment mistakes that are approved by the customer.*

Description

**Exterior Illuminated Monument sign**  
**3D Visualization**



Led screen

Top View

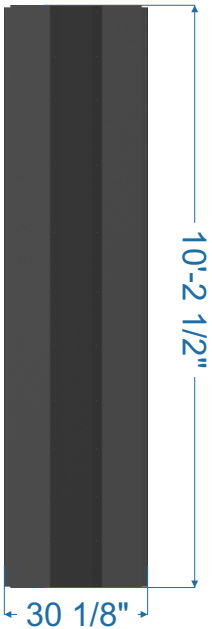



📍 3520 Valhalla Dr  
Burbank, CA, 91505  
☎ 844-833-1188  
✉ hello@frontsigns.com  
🌐 https://www.frontsigns.com

Contractors Lic. #C45-1053708

 Underwriters Laboratories # E508823

Once you approve the digital proof for your project, we are not responsible for any misspellings, typos or mistakes that occurred in your final product. Errors that we are not responsible for include, but are not limited to: any spelling, graphics, grammar, punctuation, alignment mistakes that are approved by the customer.

#### Description

### Exterior Illuminated Monument sign 3D Visualization

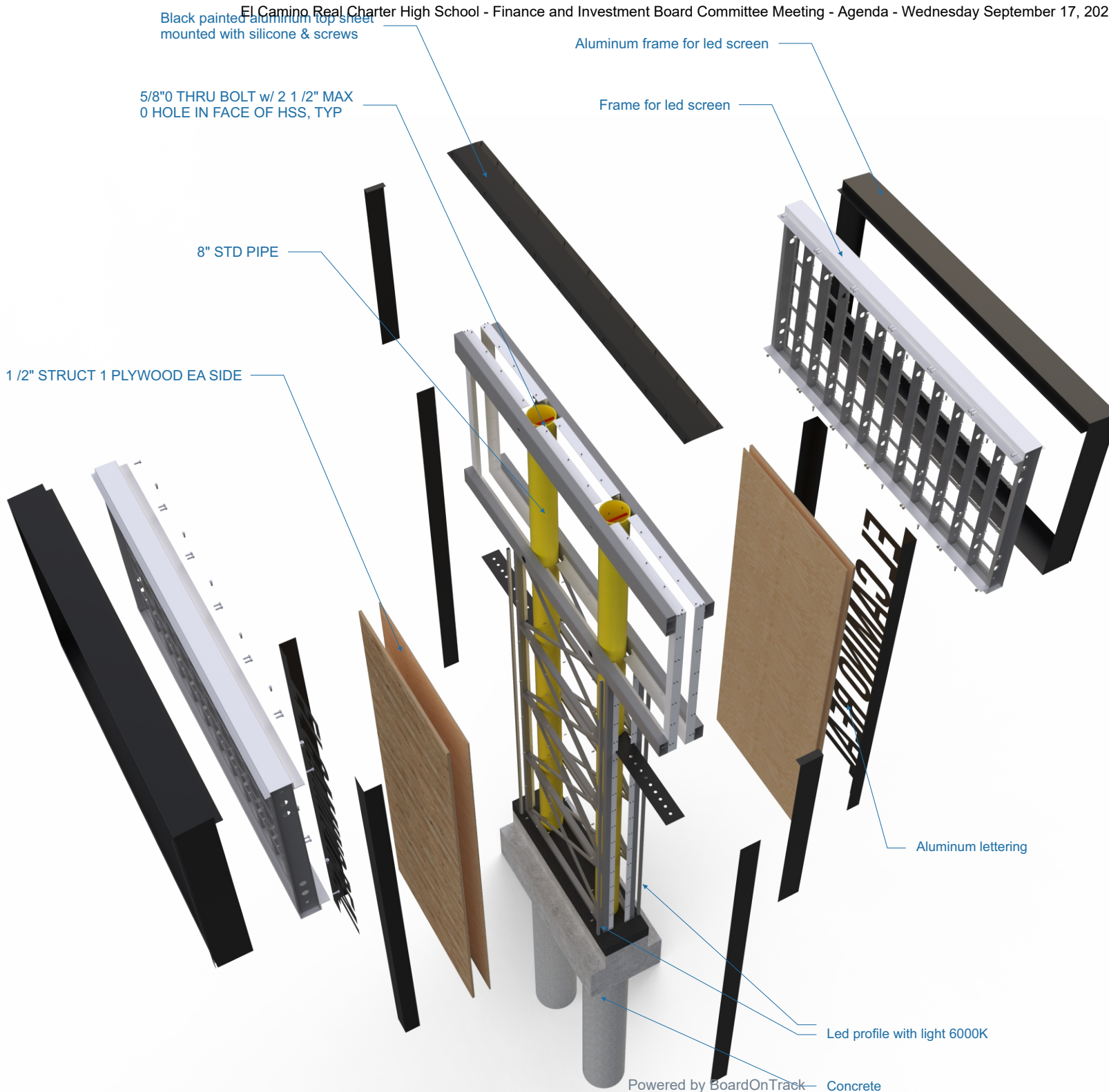

📍 3520 Valhalla Dr  
Burbank, CA, 91505  
☎ 844-833-1188  
✉ hello@frontsigns.com  
🌐 https://www.frontsigns.com

Contractors Lic. #C45-1053708

 Underwriters Laboratories # E508823

*Once you approve the digital proof for your project, we are not responsible for any misspellings, typos or mistakes that occurred in your final product. Errors that we are not responsible for include, but are not limited to: any spelling, graphics, grammar, punctuation, alignment mistakes that are approved by the customer.*

#### Description

### Exterior Illuminated Monument sign

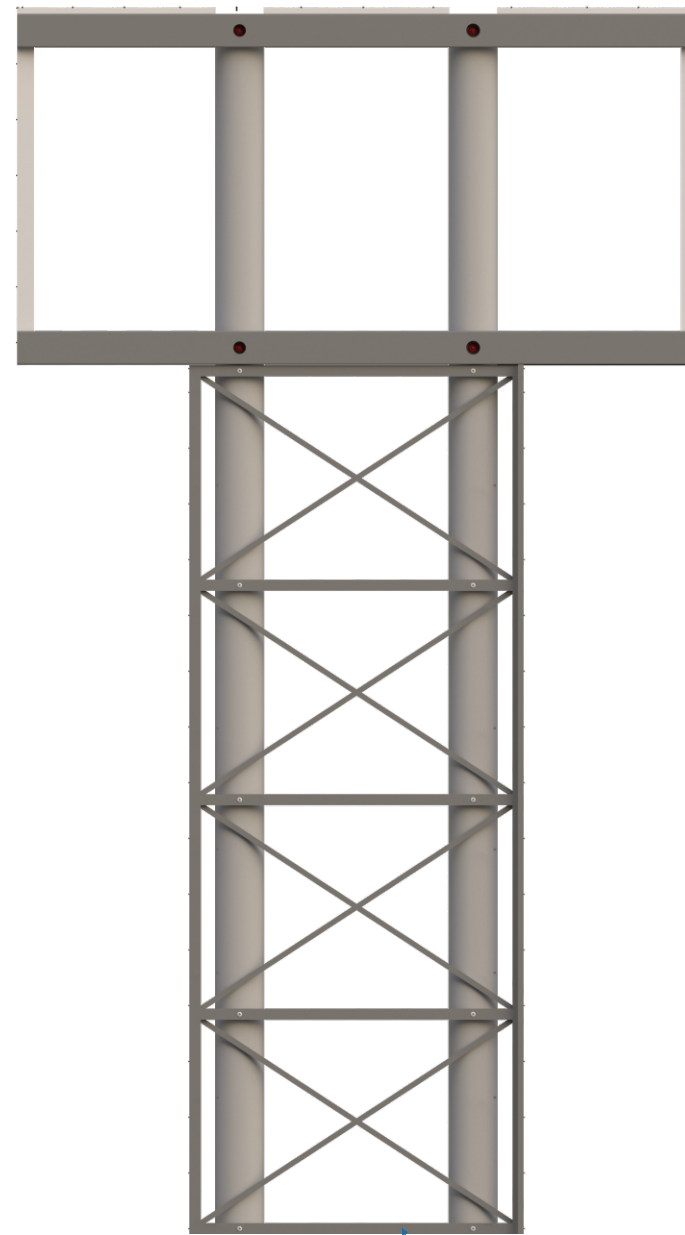
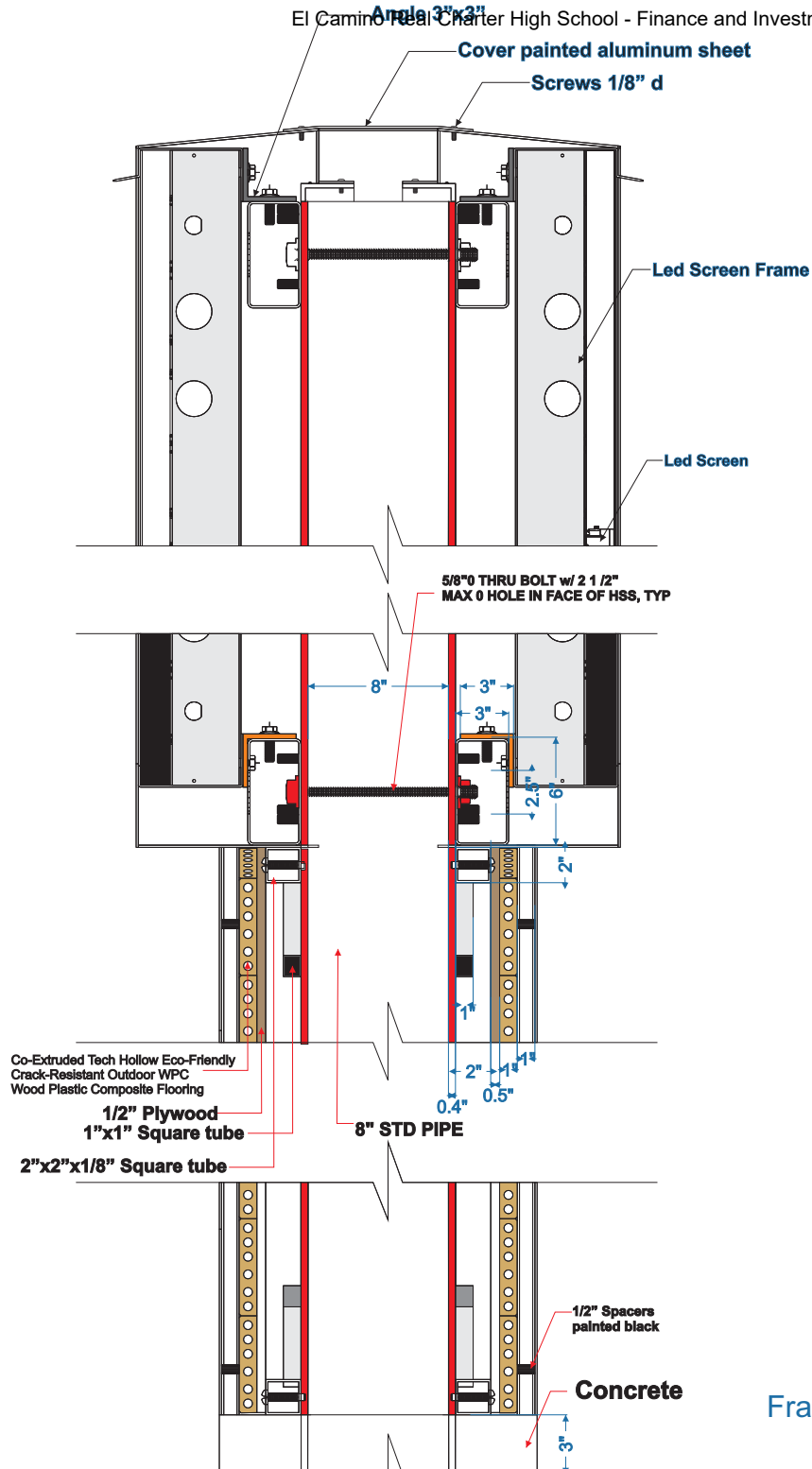

Frame construction for plywood

📍 3520 Valhalla Dr  
Burbank, CA,91505  
☎ 844-833-1188  
✉ hello@frontsigns.com  
🌐 <https://www.frontsigns.com>

Contractors Lic. #C45-1053708  
 Underwriters Laboratories # E508823

*Once you approve the digital proof for your project, we are not responsible for any misspellings, typos or mistakes that occurred in your final product. Errors that we are not responsible for include, but are not limited to: any spelling, graphics, grammar, punctuation, alignment mistakes that are approved by the customer.*

Description

**Exterior Illuminated Monument sign**

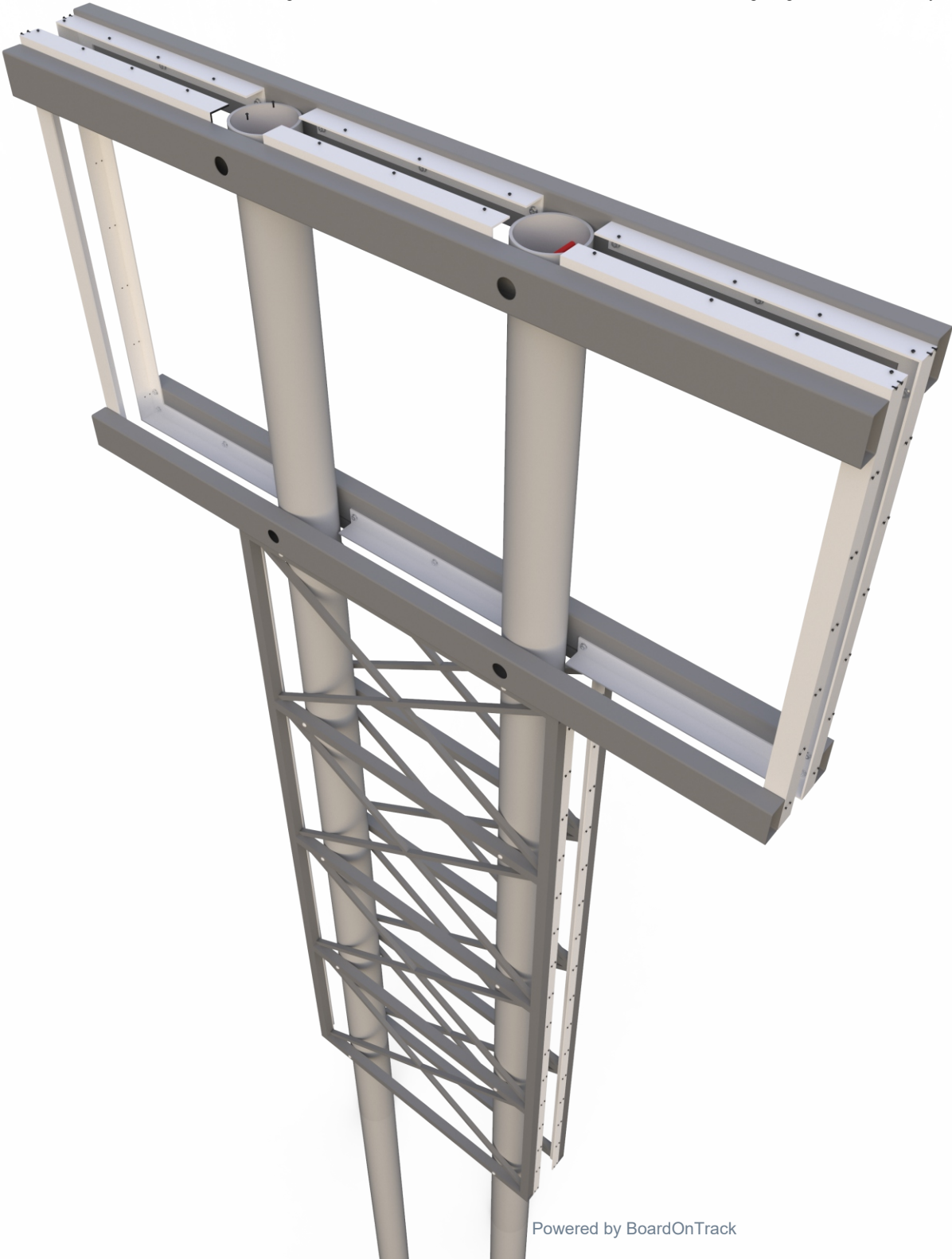



📍 3520 Valhalla Dr  
Burbank, CA, 91505  
☎ 844-833-1188  
✉ hello@frontsigns.com  
🌐 <https://www.frontsigns.com>

Contractors Lic. #C45-1053708

 Underwriters Laboratories # E508823

*Once you approve the digital proof for your project, we are not responsible for any misspellings, typos or mistakes that occurred in your final product. Errors that we are not responsible for include, but are not limited to: any spelling, graphics, grammar, punctuation, alignment mistakes that are approved by the customer.*

#### Description

### Exterior Illuminated Monument sign



5/8"Ø THRU BOLT w/ 2 1/2" MAX Ø HOLE IN FACE OF HSS, TYP

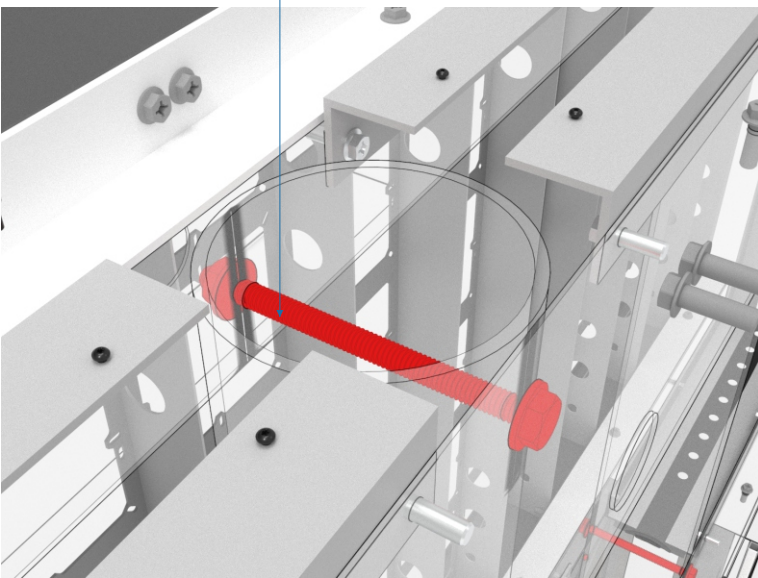

📍 3520 Valhalla Dr  
Burbank, CA, 91505  
☎ 844-833-1188  
✉ hello@frontsigns.com  
🌐 <https://www.frontsigns.com>

Contractors Lic. #C45-1053708

 Underwriters Laboratories # E508823

*Once you approve the digital proof for your project, we are not responsible for any misspellings, typos or mistakes that occurred in your final product. Errors that we are not responsible for include, but are not limited to: any spelling, graphics, grammar, punctuation, alignment mistakes that are approved by the customer.*

Description

**Exterior Illuminated Monument sign**

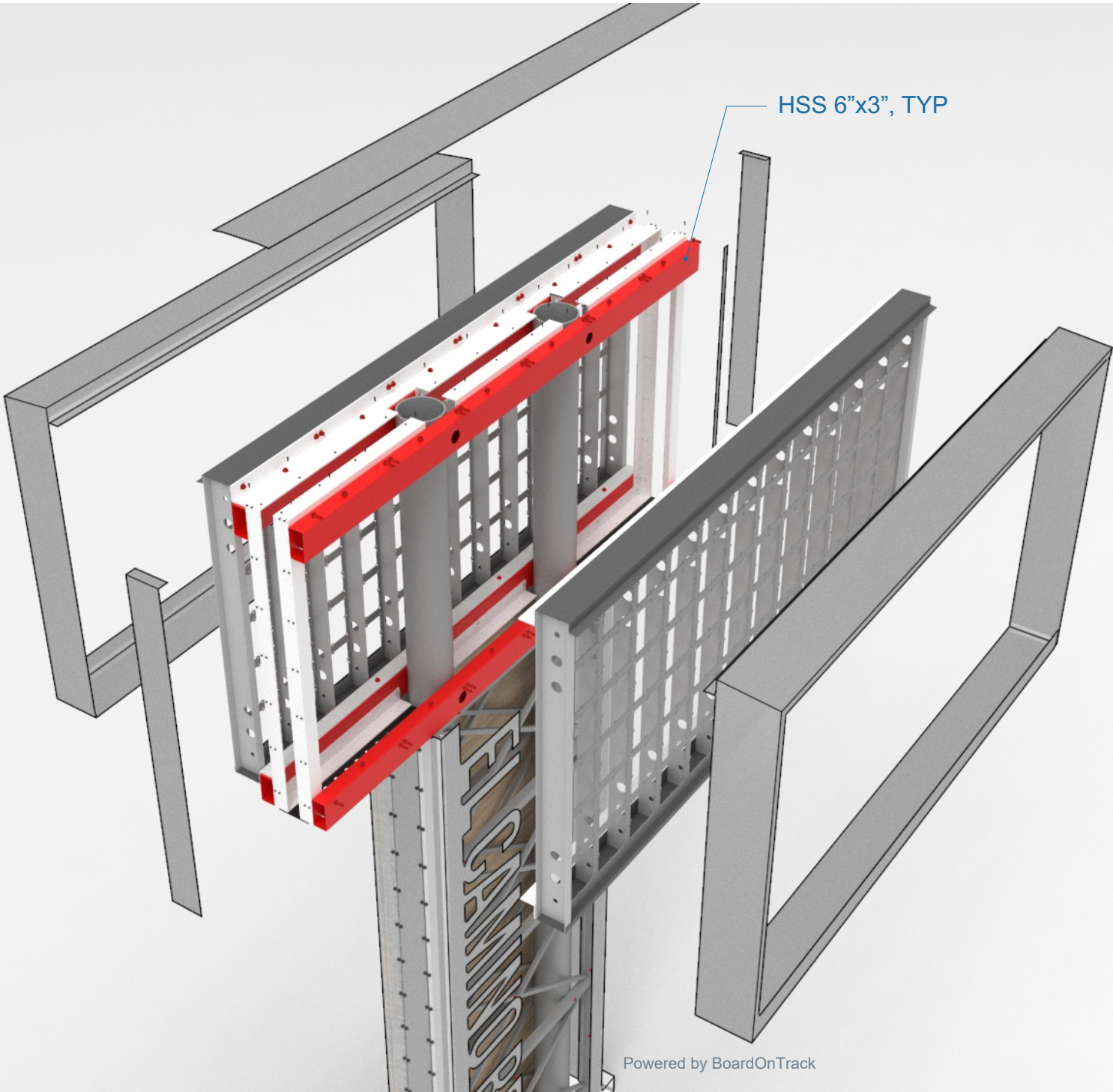



📍 3520 Valhalla Dr  
Burbank, CA, 91505  
☎ 844-833-1188  
✉ hello@frontsigns.com  
🌐 <https://www.frontsigns.com>

Contractors Lic. #C45-1053708

 Underwriters Laboratories # E508823

*Once you approve the digital proof for your project, we are not responsible for any misspellings, typos or mistakes that occurred in your final product. Errors that we are not responsible for include, but are not limited to: any spelling, graphics, grammar, punctuation, alignment mistakes that are approved by the customer.*

#### Description

### Exterior Illuminated Monument sign

# Footing details

3520 Valhalla Dr  
 Burbank, CA, 91505  
 844-833-1188  
 hello@frontsigns.com  
 https://www.frontsigns.com

Contractors Lic. #C45-1053708

 Underwriters Laboratories # E508823

Once you approve the digital proof for your project, we are not responsible for any misspellings, typos or mistakes that occurred in your final product. Errors that we are not responsible for include, but are not limited to: any spelling, graphics, grammar, punctuation, alignment mistakes that are approved by the customer.

## Description

## Exterior Illuminated Monument sign

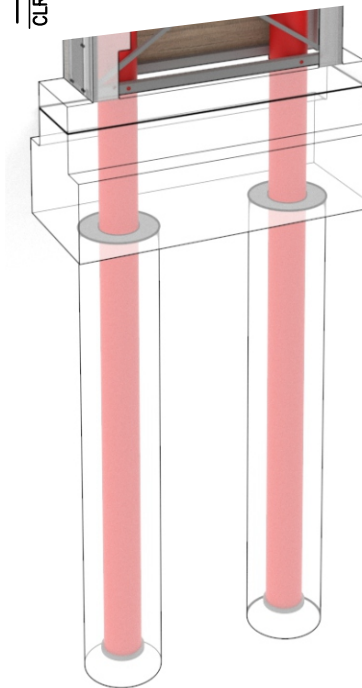
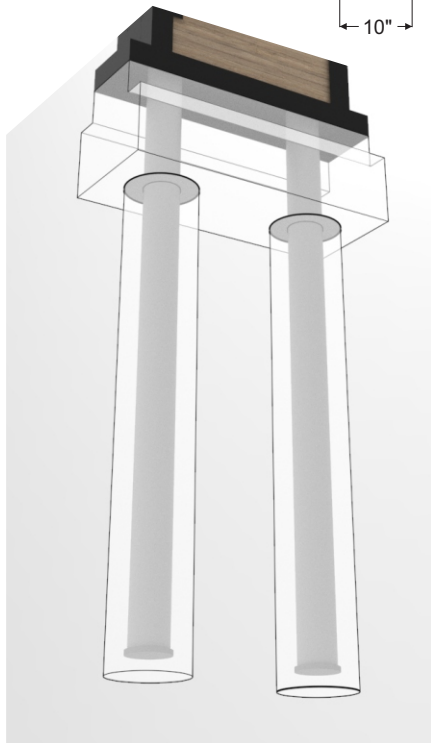
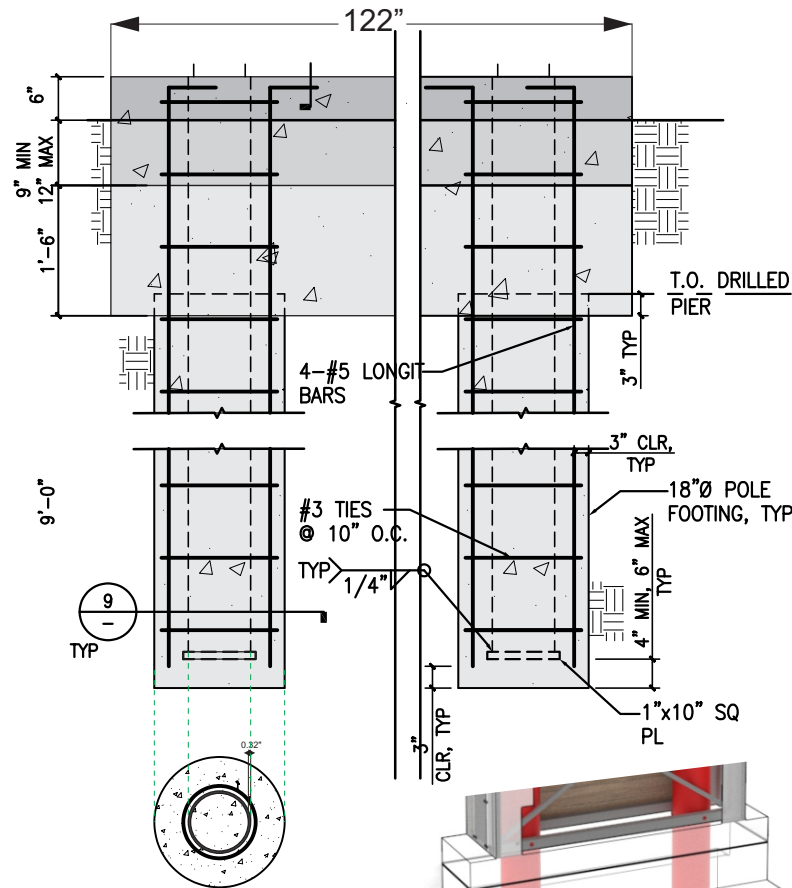
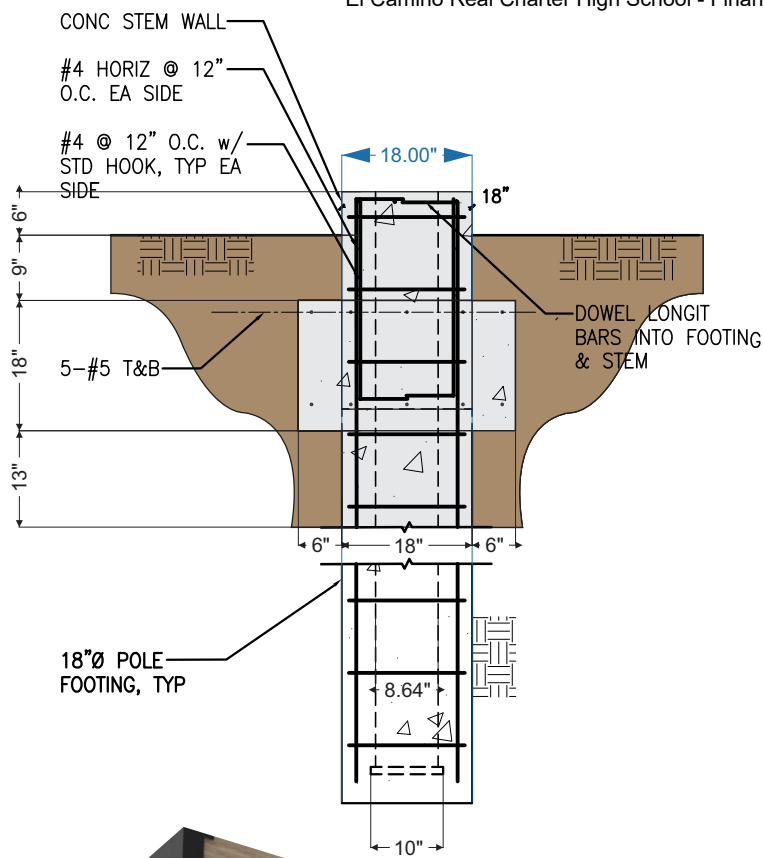

**OPTION 2****01****Exterior Non-illuminated Monument sign****3' H x 12' W x 6" D - Qty: 1****Painted Aluminum Box w/****1/2" Thick Acrylic White****letters Will Spell: "El Camino Real Charter High School"****Single-sided****Concrete Ground w/ artificial brick panels****FONT NAME: "EL CAMINO REAL CHARTER HIGH SCHOOL"****FatFrank Heavy**

**Push-through**  
**1/2" Thick Acrylic Circle**  
**w/ Printed Translucent**  
**Adhesive Vinyl Overlay**



📍 3520 Valhalla Dr  
 Burbank, CA, 91505  
 ☎ 844-833-1188  
 ✉ hello@frontsigns.com  
 🌐 https://www.frontsigns.com

Contractors Lic. #C45-1053708

 Underwriters Laboratories # E508823

Once you approve the digital proof for your project, we are not responsible for any misspellings, typos or mistakes that occurred in your final product. Errors that we are not responsible for include, but are not limited to: any spelling, graphics, grammar, punctuation, alignment mistakes that are approved by the customer.

**Description****Sign 1**



📍 3520 Valhalla Dr  
Burbank, CA, 91505  
☎ 844-833-1188  
✉ hello@frontsigns.com  
🌐 <https://www.frontsigns.com>

Contractors Lic. #C45-1053708

 Underwriters Laboratories # E508823

*Once you approve the digital proof for your project, we are not responsible for any misspellings, typos or mistakes that occurred in your final product. Errors that we are not responsible for include, but are not limited to: any spelling, graphics, grammar, punctuation, alignment mistakes that are approved by the customer.*

Description

***Sign 1***  
***OPTION 2***



**EL CAMINO  
REAL CHARTER  
HIGH SCHOOL**



**7' H x 12" D**

**Non-illuminated**

**Aluminum Painted Letters**

**on top of existing concrete circles**

📍 3520 Valhalla Dr  
Burbank, CA, 91505  
☎ 844-833-1188  
✉ hello@frontsigns.com  
🌐 <https://www.frontsigns.com>

Contractors Lic. #C45-1053708

 Underwriters Laboratories # E508823

*Once you approve the digital proof for your project, we are not responsible for any misspellings, typos or mistakes that occurred in your final product. Errors that we are not responsible for include, but are not limited to: any spelling, graphics, grammar, punctuation, alignment mistakes that are approved by the customer.*

Description

**Sign 3**

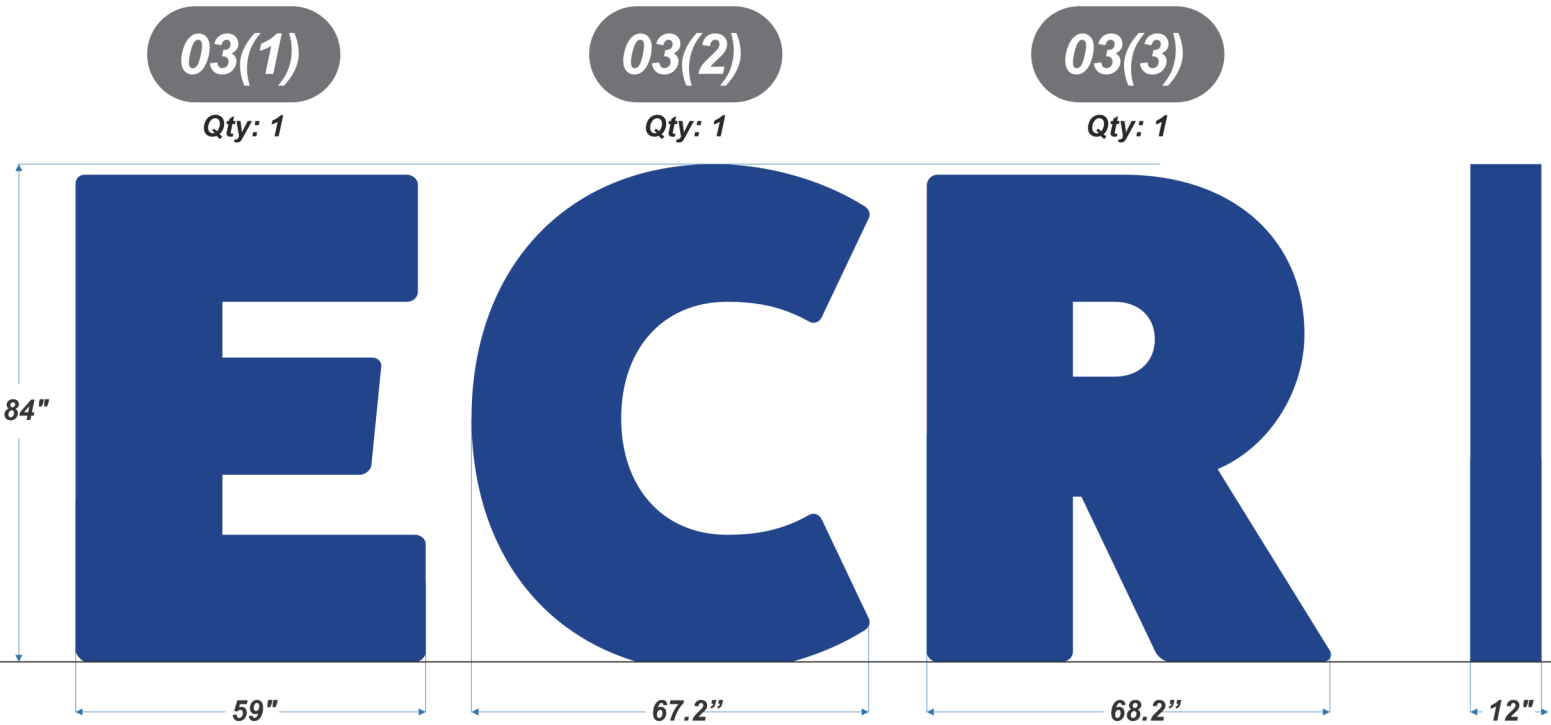

03(4)

Qty: 1

**Exterior Non-illuminated Monument sign**

**on top of existing concrete circles**

**Painted Aluminum Box w/**

**1/2" Thick Acrylic White**

**Single-sided**

**Concrete Ground w/ artificial brick panels**

**OPTION 1**

**FONT NAME: "EL CAMINO REAL CHARTER HIGH SCHOOL"**

**FatFrank Heavy**



📍 3520 Valhalla Dr  
Burbank, CA, 91505  
☎ 844-833-1188  
✉ hello@frontsigns.com  
🌐 https://www.frontsigns.com

Contractors Lic. #C45-1053708

UL Underwriters Laboratories # E508823

Once you approve the digital proof for your project, we are not responsible for any misspellings, typos or mistakes that occurred in your final product. Errors that we are not responsible for include, but are not limited to: any spelling, graphics, grammar, punctuation, alignment mistakes that are approved by the customer.

Description

**Sign 3**



03(4)

Qty: 1

**Exterior Non-illuminated Monument sign**

**on top of existing concrete circles**

**Painted Aluminum Box w/**

**1/2" Thick Acrylic White**

**Single-sided**

**Concrete Ground w/ artificial brick panels**

**OPTION 2**

**FONT NAME: "EL CAMINO REAL CHARTER HIGH SCHOOL"**

**FatFrank Heavy**



📍 3520 Valhalla Dr  
Burbank, CA, 91505  
☎ 844-833-1188  
✉ hello@frontsigns.com  
🌐 https://www.frontsigns.com

Contractors Lic. #C45-1053708

UL Underwriters Laboratories # E508823

Once you approve the digital proof for your project, we are not responsible for any misspellings, typos or mistakes that occurred in your final product. Errors that we are not responsible for include, but are not limited to: any spelling, graphics, grammar, punctuation, alignment mistakes that are approved by the customer.

Description

**Sign 3**



03(4)

Qty: 1

**Exterior Non-illuminated Monument sign**

**on top of existing concrete circles**

Painted Aluminum Box w/

"ROYALS": 1/2" Thick Acrylic White

"EL CAMINO REAL CHS": Cutout Letters

Single-sided

Concrete Ground w/ artificial brick panels

**OPTION 3**

**FONT NAME: "EL CAMINO REAL CHARTER HIGH SCHOOL"**

**FatFrank Heavy**

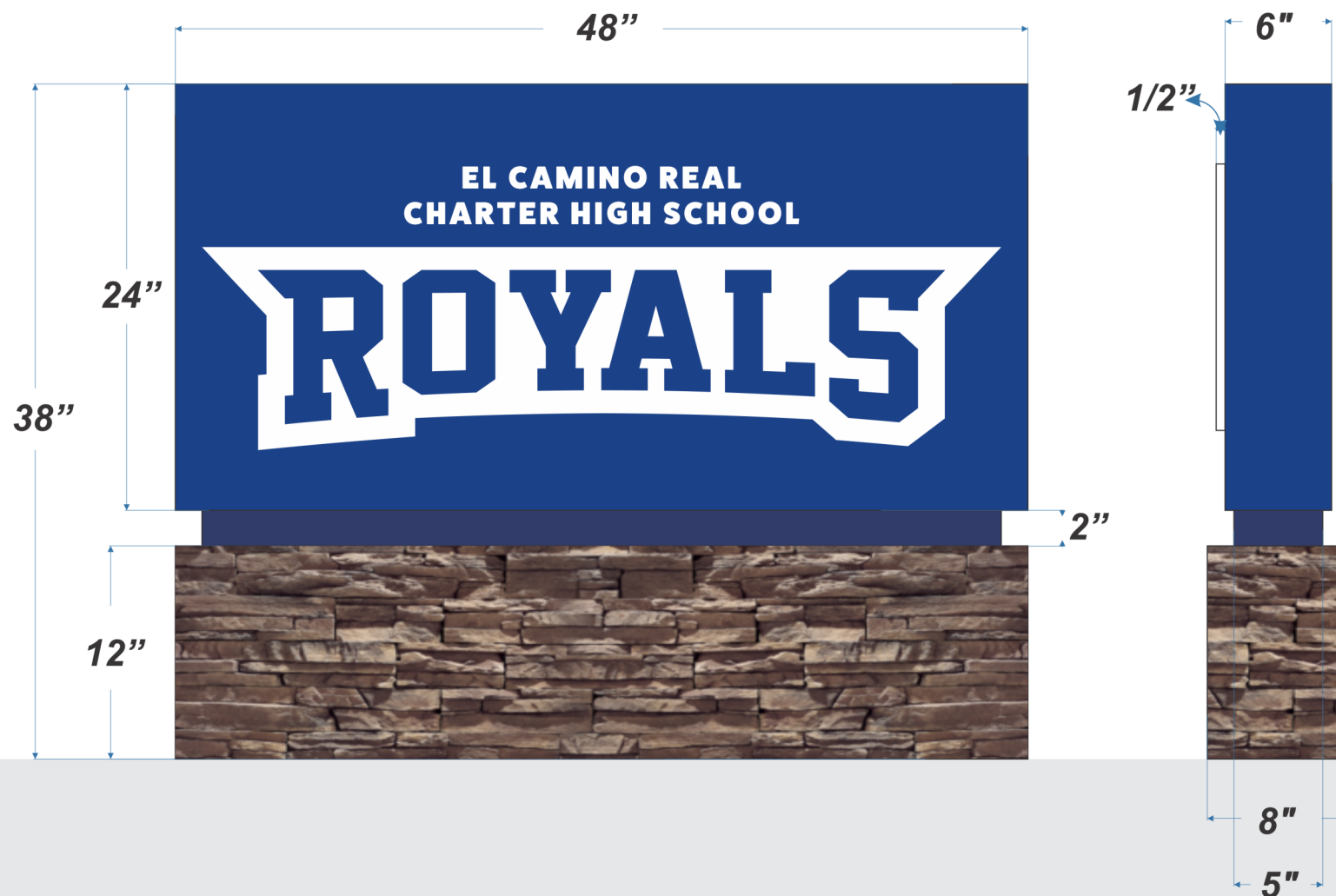

📍 3520 Valhalla Dr  
Burbank, CA, 91505  
☎ 844-833-1188  
✉ hello@frontsigns.com  
🌐 https://www.frontsigns.com

Contractors Lic. #C45-1053708

UL Underwriters Laboratories # E508823

Once you approve the digital proof for your project, we are not responsible for any misspellings, typos or mistakes that occurred in your final product. Errors that we are not responsible for include, but are not limited to: any spelling, graphics, grammar, punctuation, alignment mistakes that are approved by the customer.

Description

**Sign 3**

