



Facility Inspection Tool

Summary of Ratings For Williams Facility Inspection

SCHOOL DISTRICT/COUNTY OFFICE OF EDUCATION Los Angeles Unified (LAUSD) / Los Angeles County Office of Education			COUNTY Los Angeles	
SCHOOL SITE / ADDRESS Bert Corona Charter , 9400 Remick Ave., Pacoima, CA 91331			SCHOOL TYPE (GRADE LEVELS) High	NUMBER OF CLASSROOMS ON SITE 17
INSPECTOR'S NAME Vallo, Anthony			NAME OF DISTRICT REPRESENTATIVE Mr. Rios	TITLE OF DISTRICT REPRESENTATIVE Plant Staff
DATE OF INSPECTION 08/30/2022 am	FOLLOW-UP INSPECTION DATE:	Announced Visit		CDS CODE 19647330106872

Total # of Areas Evaluated ↓ 19	Category Totals	A. SYSTEMS			B. INTERIOR	C. CLEANLINESS		D. ELECTRICAL	E. RESTROOMS/ FOUNTAINS		F. SAFETY		G. STRUCTURAL		H. EXTERNAL	
		GAS	MECH/HVAC	SEWER	INTERIOR SURFACES	OVERALL CLEANLINESS	PEST/VERMIN INFESTATION	ELECTRICAL	RESTROOMS	SINKS / FOUNTAINS	FIRE SAFETY	HAZARDOUS MATERIAL	STRUCTURAL	ROOFS / GUTTERS	PLAYGROUND SCHOOL GROUNDS	Windows/Doors Gates/Fences
		# of '✓'s	18	18	18	18	19	15	3	18	17	18	18	19	19	18
		# of "D"s				1		3			1					
		# of "X"s														
	# of "NA"s	1	1	1	1			1	16	1	1	1	1			1
% of System in Good Repair # of ✓'s divided by (Total Areas - "NA"s)*		100.00	100.00	100.00	100.00	94.74	100.00	83.33	100.00	100.00	94.44	100.00	100.00	100.00	100.00	100.00
Total % per Category (Average of above)*		100			100	97.37		83.33	100		97.22		100		100	
Rank Good=90-100% Fair=75-89.99% Poor=0-74.99%		Good			Good	Good		Fair	Good		Good		Good		Good	

*Note - An extreme deficiency in any area automatically results in a "Poor" rating for that category and a zero for "Total % per Category".

OVERALL RATING: DETERMINE AVERAGE PERCENTAGE OF 8 CATEGORIES ABOVE → **97.24%** SCHOOL RATING → **GOOD**

Ratings Reduction Rationale		Site SqFt	Building	Students	Adults
		75000	14299	Female Fixtures	4
				Male Urinals	3
				Male Toilets	2
				Gender-Neutral Fixtures	1

Percentage	Description	Rating
99%-100%	The school meets most or all standards of good repair. Deficiencies noted, if any, are not significant and/or impact a very small area of school.	Exemplary
90%-98.99%	The school is maintained in good repair with a number of non-critical deficiencies noted. These deficiencies are isolated, and/or resulting from minor wear and tear, and/or in the process of being mitigated.	Good
75-89.99%	The school is not in good repair. Some deficiencies noted are critical and/or widespread. Repairs an/or additional maintenance are necessary in several areas of the school site.	Fair
0-74.99%	The school facilities are in poor condition. Deficiencies of various degrees have been noted throughout the site. Major repairs and maintenance are necessary throughout the campus.	Poor

The Los Angeles County Office of Education provides observations on approximately 25-60% of classrooms, chosen at random, for this report. Not all deficiencies will be observed; this inspection is merely a snapshot in time showing the condition of the school on one day and is not meant to be comprehensive. It is the responsibility of the School and District to ensure that the site is kept in Good Repair as defined by Williams Legislation.

Page 1

As of 09/02/2022 at 9:13 AM

Detail Report

Williams Facility Inspections

School year 2022-2023



Los Angeles County Office of Education
Serving Students • Supporting Communities • Leading Educators

64733 - Los Angeles Unified (LAUSD) - ESC Northeast

19647330106872 - Bert Corona Charter , Decile

# of Instruction Rooms	17	# Inspected	15	% Instruction Rooms	88%
------------------------	----	-------------	----	---------------------	-----

Fire Safety

Classroom 13

Fuel canisters unsecured

Electrical

Classroom 1

Missing outlet cover

Classroom 2

Missing outlet cover

Classroom 7

Improper usage of extension cords or extension cord trip hazard.

Overall Cleanliness

Classroom 1

Unsecured items stored too high

Unsecured bookshelf

The following rooms were inspected:

- | | | |
|-------------------------------------|--|---|
| 1 - Classroom 1 | 8 - Classroom 8 - (no deficiencies) | 15 - Classroom 13 |
| 2 - Classroom 2 | 9 - Classroom 9 - (no deficiencies) | 16 - Classroom 14 - (no deficiencies) |
| 3 - Classroom 3 - (no deficiencies) | 10 - Boys RR Main - (no deficiencies) | 17 - Classroom 15 - (no deficiencies) |
| 4 - Classroom 4 - (no deficiencies) | 11 - Girls RR Main - (no deficiencies) | 18 - Outdoor Dining - (no deficiencies) |
| 5 - Classroom 5 - (no deficiencies) | 12 - Classroom 10 - (no deficiencies) | 19 - Grounds - (no deficiencies) |
| 6 - Classroom 6 - (no deficiencies) | 13 - Classroom 11 - (no deficiencies) | |
| 7 - Classroom 7 | 14 - Classroom 12 - (no deficiencies) | |

**Detail Report
Williams Facility Inspections
School year 2022-2023**

64733 - Los Angeles Unified (LAUSD) - ESC Northeast

19647330106872 - Bert Corona Charter , Decile

OBSERVATIONS: None

District did not provide any comments about how they are addressing deficiencies.

Inspection Reviewed by:

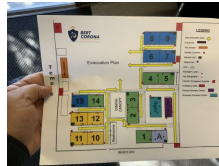

Mr. Rios
Plant Staff
8/30/2022 10:47:24 AM

Note: When a deficiency is observed that involves moisture of any kind, including, but not limited to a stained ceiling tile or damp carpeting, it is the responsibility of the District to perform any necessary testing to determine the source of the moisture or any other hazards and then provide appropriate repairs. This report is a list of observations only and is not intended to diagnose the cause of a deficiency.