

1 2 3 4 5 6 7 8 9 10 11 12 13 14 15

**BUREAU OF ENGINEERING
DEPARTMENT OF PUBLIC WORKS
CITY OF LOS ANGELES**

RESEDA SKATING FACILITY



VIEW FROM SHERMAN WAY

THE CITY OF LOS ANGELES OR ITS OFFICERS OR AGENTS SHALL NOT BE RESPONSIBLE FOR THE ACCURACY OR COMPLETENESS OF ELECTRONIC COPIES OF THIS PLAN SHEET.

REVISION DATES (DESIGN STAGE ONLY)

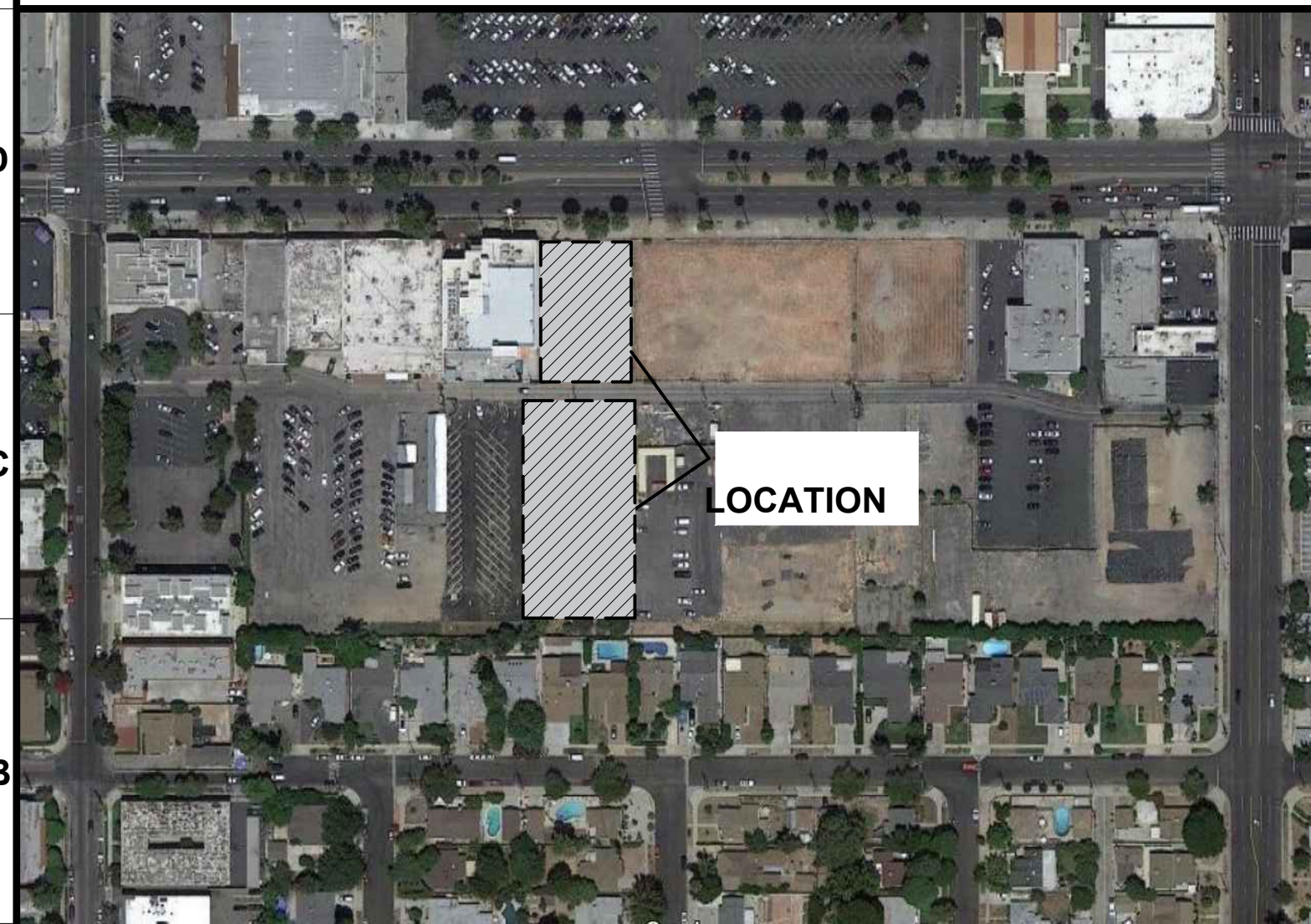

VICINITY MAP

NOT TO SCALE

BUREAU OF ENGINEERING

ENGINEERING
CITY OF LOS ANGELES

DATE: BY:	
NO. REVISIONS:	
WORK ACCEPTED	SERIAL NO.
INDEX NO.	STRUCTURE NO.

DEPARTMENT OF PUBLIC WORKS

GARY LEE MORE, P.E. ENV. SP. CITY ENGINEER

ACCEPTED BY:

DEPUTY CITY ENGINEER / PROGRAM MANAGER DATE

CITY ENGINEER DATE

CITY OF LOS ANGELES

VERTICAL CONTROL: (SAMPLE) 24-03875, 18-05830, NGS/028, 1885 AD
HORIZONTAL CONTROL: (SAMPLE) NAD83, EPOCH 1991.5

SHEET TITLE: COVER SHEET

PROJECT: RESEDA SKATE FACILITY

ADDRESS: 18210 SHERMAN WAY
RESEDA, CA 91335

WORK ORDER NO. **E170121B**

DRAWING NO. **A0.00**

SHEET 01 OF 230 SHEETS



06



03



05



02



04



01

NOTE: SEE SHT. A1.00 FOR ALL LOCATIONS OF THESE 3D MODEL IMAGES. THESE IMAGES ARE FOR CLARIFYING PURPOSES ONLY, CONTRACTOR SHALL REFER TO A2.00 & A2.01 AND OTHER SHEETS FOR TECHNICAL INFORMATION.

ENGINEERING
CITY OF LOS ANGELES
Environmental Engineering Division

LICENSED ARCHITECT
LAWRENCE SORRA
C 21812
REN 10/31/2023
STATE OF CALIFORNIA

BUREAU OF ENGINEERING

VERTICAL CONTROL:
HORIZONTAL CONTROL:

SHEET TITLE: 3D VIEWS
PROJECT: REVEDA SKATE FACILITY
ADDRESS: 18210 SHERMAN WAY, REVEDA CA 91335

DEPARTMENT OF PUBLIC WORKS

DATE: BY:
NO. REVISIONS:

CIP NO.
INDEX NO.

CITY OF LOS ANGELES

GARY LEE MOORE, P.E., ENV SP
DESIGN GROUP

ENGINEER: GARY LEE MOORE, P.E., ENV SP
DESIGNED BY:
DRAWN BY:
CHECKED BY:
APPROVED BY:

WORK ORDER NO.
E170121B

SHEET NAME
A0.02
SHEET 04 OF 230 SHEETS

REVISION DATES (DESIGN STAGE ONLY)

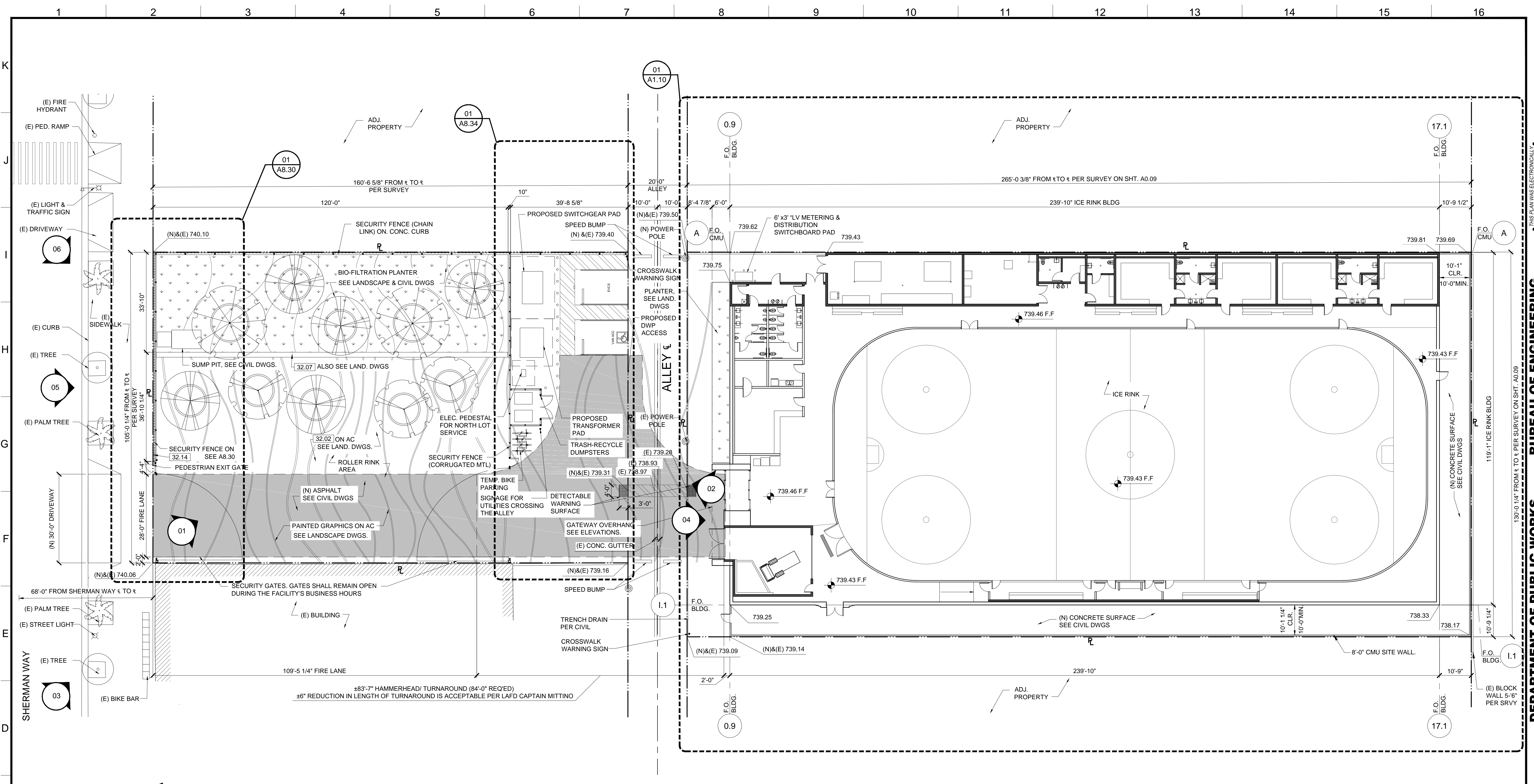

NOTES:
 1. ALL ELEVATION BUBBLES ON THIS SHEET REFER TO SHEET A0.02 3D MODEL IMAGES. SEE A2.00 & A2.01 FOR TECHNICAL ELEVATIONS THAT ARE CROSS-REFERENCED ON PLANS.

2. ELEVATIONS @ CORNER OF PROPERTY AND DIMENSIONS NOT SHOWN ON SURVEY ARE EXTRAPOLATED FROM SURVEY. CONTRACTOR SHALL VERIFY ALL PROPERTY DIMENSIONS, CORNERS AND ELEVATIONS W/ SURVEYING EQUIPMENT PRIOR TO BEGINNING CONSTRUCTION AND NOTIFY ARCHITECT OF ANY DISCREPANCY OF (E) ELEVATIONS OR (E) PROPERTY DIMENSIONS. ARCHITECT SHALL BE COMPENSATED BY OWNER FOR ANY CHANGES DUE TO INCOMPLETE SURVEY.

SITE PLAN 01
 REF: SURVEY, A0.09, A0.30, A0.41, A0.50
 SCALE: 1/16" = 1'-0"

KEYNOTES NOTE: ITEMS IDENTIFIED ARE TYPICAL TO ALL LIKE ITEMS UNLESS NOTED OTHERWISE. 01 - GENERAL REQUIREMENTS 02 - NOT USED 03 - CONCRETE 3.01 CONC. SLAB ON GRADE PER STRUCTL. 3.02 CONC. O/MTL. DECK PER STRUCTL. 3.03 CONC. CURB 3.04 CONC. FOOTING PER STRUCTL. 3.05 CONC. PAVING PER CIVIL DWGS. 3.06 CONC. SIDEWALK PER CIVIL DWGS. 3.07 CONC. PAD 04 - MASONRY 4.01 CMU BLDG. WALL 4.02 CMU SITE WALL W/ 2" CMU CAP.	05 - METALS 5.01 STL. COLUMN PER STRUCTL. PTD. 5.02 STL. BEAM PER STRUCTL. PTD. 5.03 HSS POST PER STRUCTL. PTD. 5.04 HSS BEAM PER STRUCTL. PTD. 5.05 MEMBRANE STRUCTURE I BEAM. 5.06 MTL. DECK. 5.07 MTL. GUARD RAILING. 5.08 MTL. STUD WALL. 06 - WOOD AND PLASTICS 07 - THERMAL & MOISTURE PROTECTION 7.01 W.P. MEMBRANE PER DETL. & SPECS. 7.02 SINGLE PLY PVC ROOFING PER SPECS. 7.03 R-21 RIGID INSULATION @ WALLS. 7.04 UNDERSLAB MOISTURE VAPOR BARRIER. 7.05 ROOF DRAIN AND OVERFLOW.	7.06 CLEAR WATER-REPELLENT GRAFITTI COATING AT CMU WALL. (ALL EXPOSED SURFACES). 7.07 BATT INSULATION. 08 - OPENINGS (SEE DOOR/WINDOW SCHED) 8.01 STL. DOOR & FRAME, PAINTED. 8.02 CLR. ANODIZED ALUM. STOREFRONT DOOR. 8.03 CLR. ANODIZED ALUM. STOREFRONT WINDOW. 8.04 DOOR HARDWARE SET PER SCHED. 8.05 EXTERIOR WALL LOUVER. 8.06 EXTERIOR WALL VENT WITH CAP. 8.07 ROLLING STL. DOOR & FRAME. 8.08 ICE RINK GATES. 8.09 OVERHEAD GLASS DOOR. 8.10 ACCESS PANEL, COLOR TO MATCH ADJACENT MATERIAL. 8.11 ROOF ACCESS HATCH.	09 - FINISHES (SEE FIN. SCHED) 9.01 5/8" TYPE 'X' GYP. BD., PROVIDE 'WET RATED' AT BATHROOMS, PAINT. CONC. FLR. SEAL PER FIN. SCHED. 9.02 RUBBER FLR. PER SPECS. 9.03 PAINT PER SPECS. 9.04 REVEAL PER DETAILS. 9.05 GRAFITTI COATING, TYP. @ ALL EXTERIOR SOLID WALLS. 9.06 GLAZED FINISH ON CMU. 9.07 CERAMIC TILE. 10 - SPECIALTIES 10.01 MIRROR PER SPECS. 10.02 SIGNAGE. 10.03 TOILET PAPER ROLL HOLDER PER ACCESSORY SCHED. 10.04 GRAB BAR. 10.05 COAT HOOK.	10.06 WASTE RECEPTACLE. 10.07 FOLDING SHOWER SEAT. 10.08 SHOWER ROD. 10.09 SHELF. 10.10 NETTING, NIC 10.11 FIRE EXTINGUISHER, RECESSED CABINET. 10.12 TOILET SEAT COVER DISPENSER. 10.13 PAPER TOWEL DISPENSER. 10.14 BATHROOM PARTITION W/ ROBE HOOK @ EA. DOOR 11 - EQUIPMENT/APPLIANCES (SEE EQMT. SCHED) 12 - FURNISHINGS 12.01 BICYCLE RACKS FOR SHORT-TERM BIKE PARKING. 12.02 DASHBOARD, NIC 12.03 BENCH, NIC	12.04 BLEACHERS, NIC 12.05 SCOREBOARD, NIC 12.06 SKATE RACKS, NIC 13 - SPECIAL CONSTRUCTION 13.01 MEMBRANE STRUCTURE. 14 - CONVEYING EQUIPMENT (NOT USED) 21 - FIRE SUPPRESSION 21.01 FIRE EXTINGUISHER. 21.02 FIRE SPRINKLER HORIZ. MAIN (SEE DIAGRAM) 21.03 FIRE SPRINKLER VALVE ASSEMBLY 21.04 FIRE DEPT. MAIN CONNECTION @ FRONT OF PROJECT. LAFD SHALL APPROVE FINAL LOCATION. 21.05 FIRE SPRINKLER HEAD. 22 - PLUMBING 22.01 WATER CLOSET PER PLUMBING LEGEND 22.02 LAV. SINK & FAUCET, PER PLUMBING LEGEND 22.03 JANITOR MOP SINK. 22.04 PLUMBING VENT PIPE. 22.05 DRINKING FOUNTAIN. 22.06 ULTRA LOW-FLOW TOILET. 22.07 SHOWER HEAD/ CONTROLS. 22.08 SHOWER DRAIN. 22.09 AREA DRAIN. 22.10 HOSE BIB.	23.05 BATHRM EXHAUST FAN PER SPECS. 23.06 BATHRM EXHAUST DUCT. 23.07 MECH. DUCT. 23.08 MECH. EQUIPMENT. 26 - ELECTRICAL 26.01 ELEC. PANEL PER PLANS & SCHED. 26.02 EXTERIOR LIGHT PER SCHED. 26.03 INTERIOR LIGHT PER SCHED. 27 - COMMUNICATION 28 - ELECTRONIC SAFETY AND SECURITY 28.01 SMOKE ALARM. 28.02 SECURITY CAMERA. 28.03 FIRE ALARM MAIN PANEL. 31 - EARTHWORK 31.01 APPROVED COMPACT FILL PER GEO & SOIL ENGINEER REPORT.	32 - EXTERIOR IMPROVEMENTS 32.01 ASPHALT PAVING PER CIVIL DWGS. 32.02 GRAPHICS/PAINT, SEE LAND. DWGS. 32.03 STORMWATER MANAGEMENT PER CIVIL DWGS. 32.04 STL. SECURITY GATE, PTD. 32.05 STL. SECURITY FENCE, PTD. 32.06 EXTERIOR AREA DRAINS. 32.07 BENCH. 32.08 TRENCH DRAIN. 32.09 TREE, SEE LANDSCAPE DWGS. 32.10 PLANTING, SEE LANDSCAPE DWGS. 32.11 (N) CONCRETE SIDEWALK, CURB. 32.12 (N) CONC. APRON & DRIVEWAY CURB CUT PER CITY OF LA STANDARDS. 32.13 EQUIPMENT SCREEN. 32.14 CONC. WALL @ SITE FENCE.	33 - UTILITIES 33.01 WATER METER. 33.02 ELECTRICAL TRANSFORMER W/ BOLLARDS AS REQ'D. 33.03 ELECTRICAL METER. 33.04 POWER POLE.
--	---	--	---	---	--	---	--	---

THE CITY OF LOS ANGELES OR ITS OFFICERS OR AGENTS SHALL NOT BE RESPONSIBLE FOR THE ACCURACY OR COMPLETENESS OF ELECTRONIC COPIES OF THIS PLAN SHEET.

ENGINEERING
 CITY OF LOS ANGELES
 Environmental Engineering Division

LICENSED ARCHITECT
 LAWRENCE SOMPA
 C21812
 REN 10/31/2023
 STATE OF CALIFORNIA

DEPARTMENT OF PUBLIC WORKS
BUREAU OF ENGINEERING

VERTICAL CONTROL:
 HORIZONTAL CONTROL:
 SHEET TITLE: SITE PLAN
 PROJECT: RESEDA SKATE FACILITY
 ADDRESS: 18210 SHERMAN WAY, RESEDA CA 91335

CITY ENGINEER: GARY LEE MOORE, P.E., ENV SP
 DESIGN GROUP: DATE: BY: INDEX NO. CIP NO.

WORK ORDER NO. E170121B
 SHEET NAME: A1.00
 SHEET 38 OF 230 SHEETS

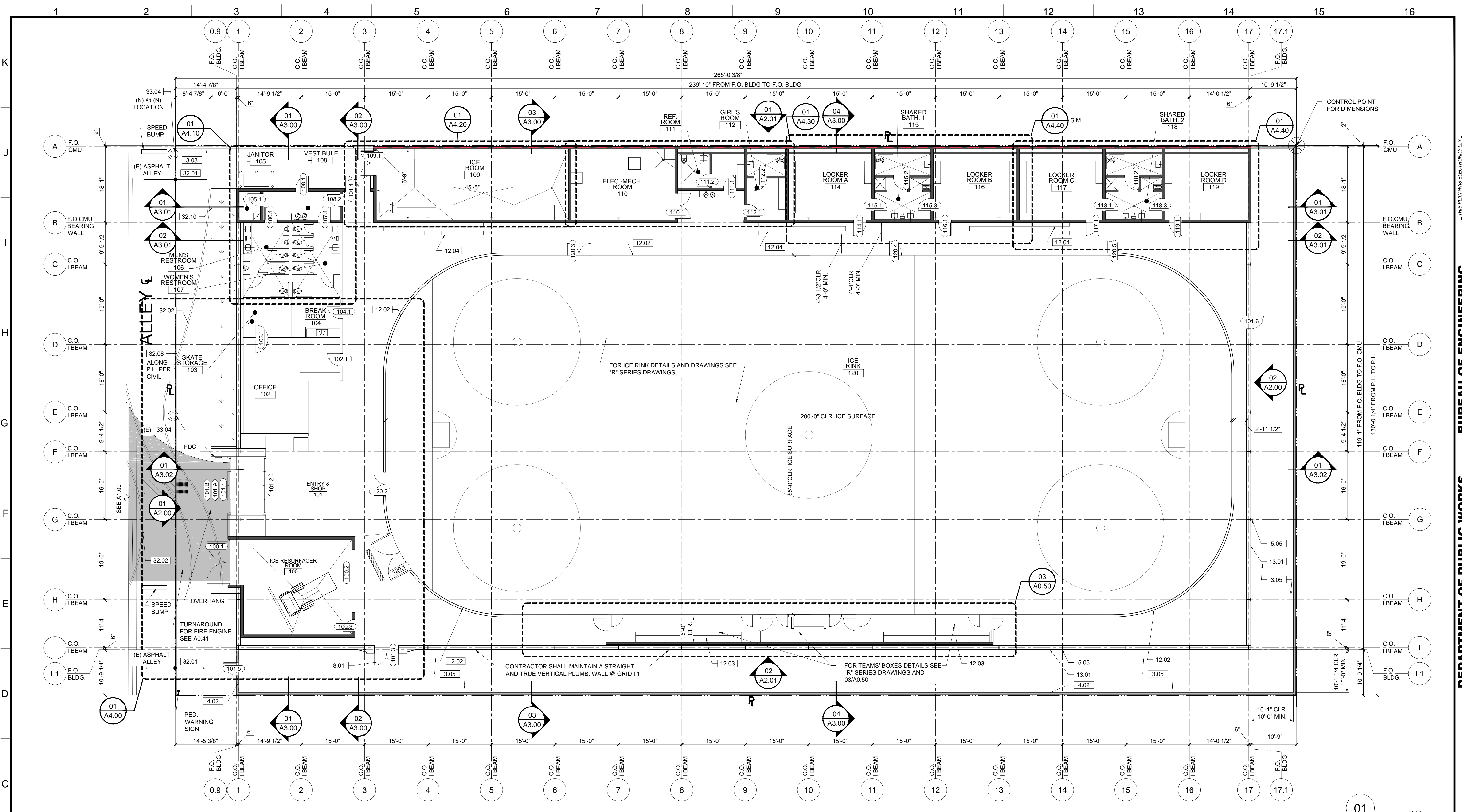

ICE RINK FLOOR PLAN

REF: A0.30, A0.50, A1.00, A1.10A, A1.11, A1.12 SCALE: 3/32" = 1'-0"

- KEYNOTES**
NOTE: ITEMS IDENTIFIED ARE TYPICAL TO ALL LIKE ITEMS UNLESS NOTED OTHERWISE.
- 01 - GENERAL REQUIREMENTS**
02 - NOT USED
 - 03 - CONCRETE**
3.01 CONC. SLAB ON GRADE PER STRUCT'L.
3.02 CONC. O/MTL. DECK PER STRUCT'L.
3.03 CONC. CURB
3.04 CONC. FOOTING PER STRUCT'L.
3.05 CONC. PAVING PER CIVIL DWGS.
3.06 CONC. SIDEWALK PER CIVIL DWGS.
3.07 CONC. PAD
 - 04 - MASONRY**
4.01 CMU BLDG. WALL
4.02 CMU SITE WALL W/ 2" CMU CAP.
 - 05 - METALS**
5.01 STL. COLUMN PER STRUCT'L. PTD.
5.02 STL. BEAM PER STRUCT'L. PTD.
5.03 HSS POST PER STRUCT'L. PTD.
5.04 HSS BEAM PER STRUCT'L. PTD.
5.05 MEMBRANE STRUCTURE I BEAM.
5.06 MTL. DECK.
5.07 MTL. GUARD RAILING.
5.08 MTL. STUD WALL.
 - 06 - WOOD AND PLASTICS**
6.01 W.P. MEMBRANE PER DETL. & SPECS.
6.02 SINGLE PLY PVC ROOFING PER SPECS.
6.03 R-21 RIGID INSULATION @ WALLS.
6.04 UNDERSLAB MOISTURE VAPOR BARRIER.
6.05 ROOF DRAIN AND OVERFLOW.
 - 07 - THERMAL & MOISTURE PROTECTION**
7.01 W.P. MEMBRANE PER DETL. & SPECS.
7.02 SINGLE PLY PVC ROOFING PER SPECS.
7.03 R-21 RIGID INSULATION @ WALLS.
7.04 UNDERSLAB MOISTURE VAPOR BARRIER.
7.05 ROOF DRAIN AND OVERFLOW.
 - 08 - OPENINGS (SEE DOOR/WINDOW SCHED)**
8.01 STL. DOOR & FRAME, PAINTED.
8.02 CLR. ANODIZED ALUM. STOREFRONT DOOR.
8.03 CLR. ANODIZED ALUM. STOREFRONT WINDOW.
8.04 DOOR HARDWARE SET PER SCHED.
8.05 EXTERIOR WALL LOUVER.
8.06 EXTERIOR WALL VENT WITH CAP.
8.07 ROLLING STL. DOOR & FRAME.
8.08 ICE RINK GATES.
8.09 OVERHEAD GLASS DOOR.
8.10 ACCESS PANEL, COLOR TO MATCH ADJACENT MATERIAL.
8.11 ROOF ACCESS HATCH.
 - 09 - FINISHES (SEE FIN. SCHED)**
9.01 5/8" TYPE 'X' GYP. BD., PROVIDE 'WET RATED' AT BATHROOMS, PAINT, CONC. FLR. SEAL PER FIN. SCHED.
9.02 RUBBER FLR. PER SPECS.
9.03 PAINT PER SPECS.
9.04 REVEAL PER DETAILS.
9.05 GRAFITTI COATING, TYP. @ ALL EXTERIOR SOLID WALLS.
9.06 GLAZED FINISH ON CMU.
9.07 CERAMIC TILE.
 - 10 - SPECIALTIES**
10.01 MIRROR PER SPECS.
10.02 SIGNAGE.
10.03 TOILET PAPER ROLL HOLDER PER ACCESSORY SCHED.
10.04 GRAB BAR.
10.05 COAT HOOK.
 - 11 - EQUIPMENT/APPLIANCES (SEE EQMT. SCHED)**
11.01 BICYCLE RACKS FOR SHORT-TERM BIKE PARKING.
11.02 DASHBOARD, NIC
11.03 BENCH, NIC
 - 12 - FURNISHINGS**
12.01 BICYCLE RACKS FOR SHORT-TERM BIKE PARKING.
12.02 DASHBOARD, NIC
12.03 BENCH, NIC
 - 13 - SPECIAL CONSTRUCTION**
13.01 MEMBRANE STRUCTURE.
 - 14 - CONVEYING EQUIPMENT (NOT USED)**
 - 21 - FIRE SUPPRESSION**
21.01 FIRE EXTINGUISHER.
21.02 FIRE SPRINKLER HORIZ. MAIN (SEE DIAGRAM)
21.03 FIRE SPRINKLER VALVE ASSEMBLY
21.04 FIRE DEPT. MAIN CONNECTION @ FRONT OF PROJECT. LAFD SHALL APPROVE FINAL LOCATION.
21.05 FIRE SPRINKLER HEAD.
 - 22 - PLUMBING**
 - 23 - HEATING, VENTILATING, AND AIR-CONDITIONING**
23.01 HVAC UNIT PER MECH.
23.02 AIR REGISTER WALL MOUNTED.
23.03 CEILING AIR REGISTER.
23.04 MAKE UP AIR LOUVER PER MECH. DWGS
 - 25 - ELECTRICAL**
25.01 ELEC. PANEL PER PLANS & SCHED.
25.02 EXTERIOR LIGHT PER SCHED.
25.03 INTERIOR LIGHT PER SCHED.
 - 26 - ELECTRICAL**
26.01 ELEC. PANEL PER PLANS & SCHED.
26.02 EXTERIOR LIGHT PER SCHED.
26.03 INTERIOR LIGHT PER SCHED.
 - 27 - COMMUNICATION**
 - 28 - ELECTRONIC SAFETY AND SECURITY**
28.01 SMOKE ALARM.
28.02 SECURITY CAMERA.
28.03 FIRE ALARM MAIN PANEL.
 - 31 - EARTHWORK**
31.01 APPROVED COMPACT FILL PER GEO & SOIL ENGINEER REPORT.
 - 32 - EXTERIOR IMPROVEMENTS**
32.01 ASPHALT PAVING PER CIVIL.
32.02 GRAPHICS/PAINT.SEE LAND. DWGS.
32.03 STORMWATER MANAGEMENT PER CIVIL DWGS.
32.04 STL. SECURITY GATE, PTD.
32.05 STL. SECURITY FENCE, PTD.
32.06 EXTERIOR AREA DRAINS.
32.07 BENCH.
32.08 TRENCH DRAIN.
32.09 TREE, SEE LANDSCAPE DWGS.
32.10 PLANTING, SEE LANDSCAPE DWGS.
32.11 (N) CONCRETE SIDEWALK, CURB, GUTTER PER CITY OF LA STANDARDS.
32.12 (N) CONC. APRON & DRIVEWAY CURB CUT PER CITY OF LA STANDARDS.
32.13 EQUIPMENT SCREEN.
32.14 CONC. WALL @ SITE FENCE.
 - 33 - UTILITIES**
33.01 WATER METER.
33.02 ELECTRICAL TRANSFORMER W/ BOLLARDS AS REQ'D.
33.03 ELECTRICAL METER.
33.04 POWER POLE.

ENGINEERING
CITY OF LOS ANGELES

BUREAU OF ENGINEERING

LICENSED ARCHITECT
LAWRENCE S. MOORE
C 21812
REN. 10/31/2023
STATE OF CALIFORNIA

DEPARTMENT OF PUBLIC WORKS

ICE RINK FLOOR PLAN
RESEDA SKATE FACILITY

18210 SHERMAN WAY, RESEDA CA 91335

INDEX NO. CIP NO.

CITY ENGINEER: GARY LEE MOORE, P.E., ENV SP
DESIGN GROUP

WORK ORDER NO. E170121B

SHEET NAME: A1.10
SHEET 40 OF 230 SHEETS

THE CITY OF LOS ANGELES OR ITS OFFICERS OR AGENTS SHALL NOT BE RESPONSIBLE FOR THE ACCURACY OR COMPLETENESS OF ELECTRONIC COPIES OF THIS PLAN SHEET.