



SUMMARY

Date 04/08/20

Project: Keller Saginaw Field Expansion
 Owner: International Leadership of Texas
 Location: 10537 US 287
 Fort Worth, Texas 76131
 Architect: Pivot North
 Estimate Type: GMP

First Floor	0
Second Floor	0
Total Building (SF)	0
Site Area Disturbed (SF)	429,619
Gross Off-Site Area Disturbed (SF)	0
Duration (MO)	4.0

Project Summary - BREAKDOWN BY CSI DIVISION				
CSI Division	Trade		Total	Cost/SF
Div 01	GENERAL CONDITIONS		\$ 140,000	\$0.33 /SSF
Div 01	GENERAL REQUIREMENTS		\$ 38,000	\$0.09 /SSF
Div 02	EARTHWORK & GRADING (BALANCED SITE)		\$ 173,000	\$0.40 /SSF
Div 02	SITE CONCRETE		\$ 106,000	\$0.25 /SSF
Div 02	SITE UTILITIES - WET		\$ 20,950	\$0.05 /SSF
Div 02	SITE UTILITIES - ELECTRICAL		\$ 3,500	\$0.01 /SSF
Div 02	PERIMETER AND SPORTS FENCING		\$ 339,000	\$0.79 /SSF
Div 02	LANDSCAPE / IRRIGATION		\$ 309,400	\$0.72 /SSF
Div 11	SOCCER GOALS, DUGOUT BENCHES, 3 ROWS - 21' x 7' FIXED BLEACHERS, BASES AND INSERTS		\$12,250	\$0.03 /SSF
Subtotal			\$ 1,142,100	\$2.66 /SSF
0.0%	Building Permit, Plan Check Fee		\$ -	\$0.00 /SSF
3.5%	City Inspections (Allowance)		\$ 39,974	\$0.09 /SSF
5.0%	Construction Contingency		\$ 57,105	\$0.13 /SSF
1.4%	Insurance & General Liability		\$ 17,349	\$0.04 /SSF
0.50%	Builders Risk/Subguard Insurance		\$ 6,283	\$0.01 /SSF
1.1%	Performance & Payment Bond		\$ 13,891	\$0.03 /SSF
5.0%	OH & Fee		\$ 63,835	\$0.15 /SSF
Site Estimate			\$ 1,340,536	\$3.12 Total/SSF

Alternate 1	Description	Qty	Unit	\$/Unit	Total
Div 2	Landscape Maintenance - 1 Year	1	year	\$ 59,476	59,476
Div 2					-
	Markups:	1	% Above	9,814	9,814
Landscape Maintenance - 1 Year				TOTAL Alternate 1	69,290

- 9 - Fencing - 3,112 LF
- 10 - Overall Site Sq. Ft. - 429,619 SF
- 11 - Soccer Sq. Ft. - 69,346 SF
- 12 - Baseball Field - 106,393 SF
- 13 - Site Concrete - 6,599 SF
- 14 - Landscape - 81,742 SF

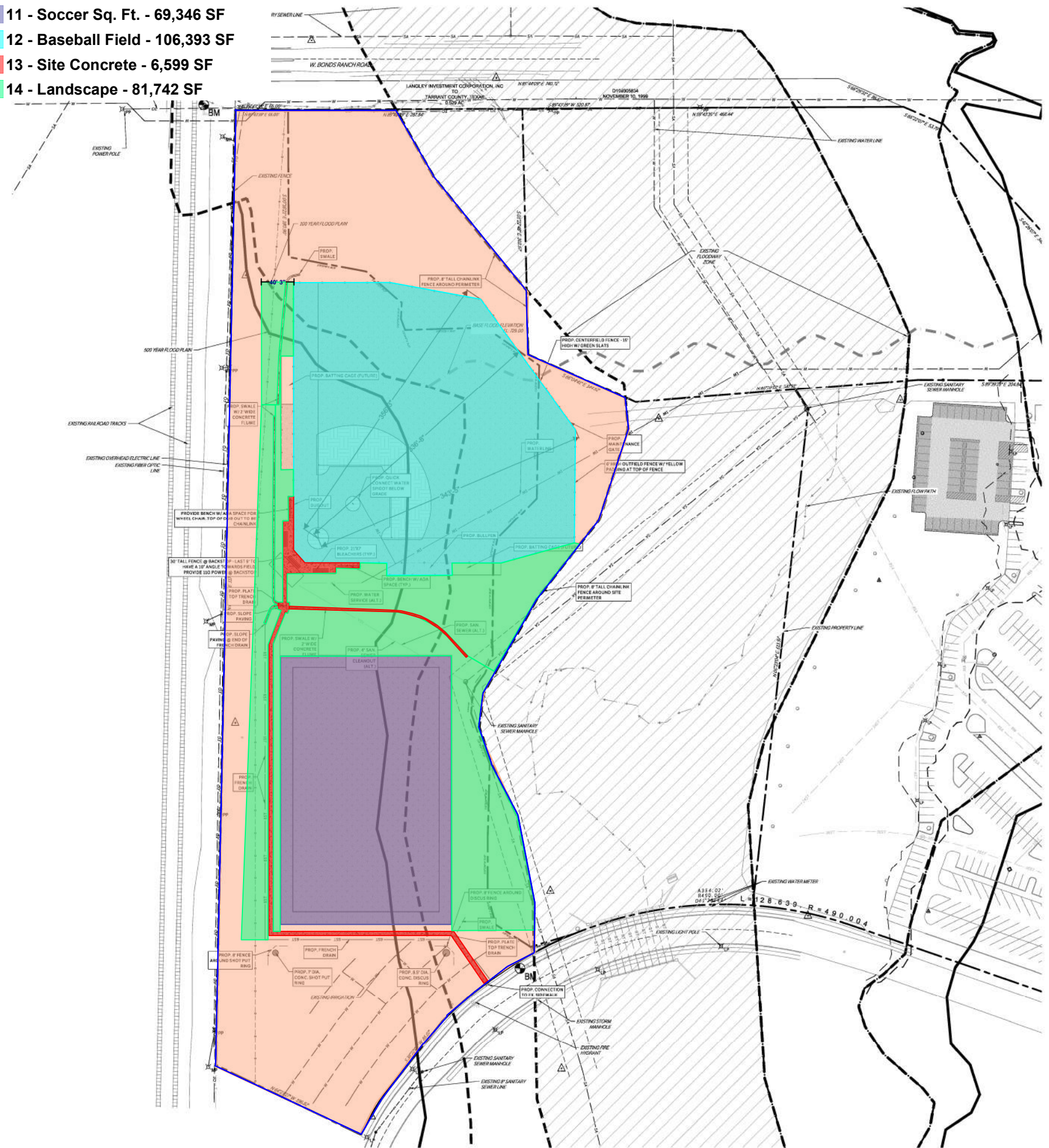

CAUTION: CONTACT TEXAS 811 AND LOCAL UTILITY PROVIDERS TO LOCATE EXISTING UTILITIES PRIOR TO CONSTRUCTION.
CONTACT GESSNER ENGINEERING IF CONFLICTS OCCUR.

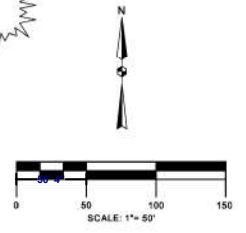

GESSNER ENGINEERING
 CIVIL / EMT / GEOTECHNICAL
 LAND SURVEYING / STRUCTURAL

CORPORATE OFFICE
 3501 ASHFORD DRIVE
 COLLEGE STATION, TEXAS 77840
 1-877-GESSNER (437-7837)
 www.gessnerengineering.com
 FIRM REGISTRATION NUMBERS:
 TBPE F-7451, TBPLS F-10393510

PRELIMINARY
 NOT FOR CONSTRUCTION

PIVOT NORTH
 architecture

PIVOT NORTH ARCHITECTURE, PLLC
 1101 W. GROVE STREET
 BOISE, ID 83702
 www.pivotnorthdesign.com

THIS DOCUMENT IS INCOMPLETE AND IS RELEASED TEMPORARILY FOR INTERIM REVIEW ONLY. IT IS NOT INTENDED FOR CONSTRUCTION, BIDDING, OR PERMIT PURPOSES.
 ALFRED A. PAINE, P.E.
 10/20

LEGEND	
	PROP. 4" THICK CONCRETE PAVEMENT
	PROP. 8" THICK CONCRETE PAVEMENT
	PROP. PLAYING FIELD SURFACE
	APPROX. PROPERTY LINE
	ADJACENT PROPERTY LINE
	EX. PAVEMENT EDGE
	EX. WATER LINE
	EX. SANITARY SEWER LINE
	EX. STORM SEWER LINE
	EX. GAS LINE
	EX. SANITARY SEWER MANHOLE
	EX. STORM SEWER MANHOLE
	EX. FIBER OPTIC
	EX. OVERHEAD ELECTRIC
	EX. SWALE
	EX. FIRE HYDRANT
	EX. WATER VALVE
	EX. WATER METER
	EX. LIGHT POLE
	EX. POWER POLE
	EX. MECHANICAL POLE
	EX. FENCE
	PROP. STORM SEWER
	PROP. WATERLINE
	PROP. UNDERGROUND ELECTRIC
	PROP. FLOW PATH
	PROP. CHAINLINK FENCE

PRELIMINARY NOT FOR CONSTRUCTION

Project:
**INTERNATIONAL LEADERSHIP OF TEXAS
 KELLER-SAGINAW HIGH SCHOOL PLAYING FIELD ADDITIONS**
 10637 NW HWY 287 SAGINAW, TEXAS

Revisions:

Project No: 19-1288
 Date: 12.18.2019
 Checked By: FP
 Drawn By: MK

Sheet Name:
OVERALL SITE PLAN

Sheet No:
C2.0

CAUTION: CONTACT TEXAS AND LOCAL UTILITY PROVIDERS TO LOCATE EXISTING UTILITIES PRIOR TO CONSTRUCTION. CONTACT GESSNER ENGINEERING IF CONFLICTS OCCUR.



PROJECT BENCHMARKS:
 BM1: SQUARE CUT IN CONCRETE SET IN THE WEST CORNER OF A STORM SEWER BOX ON THE NORTH SIDE OF LANDMONT DRIVE, APPROXIMATELY 70' NORTHEAST OF A FIRE HYDRANT. ELEVATION = 722.00'
 BM2: AN ALUMINUM DISK STAMPED "TBM 120" SET BY THE COAST AND GEODETIC SURVEY IN THE EAST HEADQUARTERS OF A DELBERT UNDER THE GULF, COLORADO AND SANTA FE RAILROAD, APPROXIMATELY 80' SOUTH OF THE CENTERLINE OF WEST BENDS RANCH ROAD. ELEVATION = 729.85'

LEGEND	
[Pattern]	PROP. 4" THICK CONCRETE PAVEMENT
[Pattern]	PROP. 4" THICK CONCRETE PAVEMENT
[Pattern]	PROP. FIELD GRASS
[Pattern]	PROP. CLAY, SILT, AND SAND MATERIAL
[Line]	PROPERTY LINE
[Line]	ADJACENT PROPERTY LINE
[Line]	EX. PAVEMENT EDGE
[Line]	EX. WATER LINE
[Line]	EX. SANITARY SEWER LINE
[Line]	EX. STORM SEWER LINE
[Line]	EX. GAS LINE
[Symbol]	EX. SANITARY SEWER MANHOLE
[Symbol]	EX. STORM SEWER MANHOLE
[Symbol]	EX. FIBER OPTIC
[Symbol]	EX. OVERHEAD ELECTRIC
[Symbol]	EX. DRAIN
[Symbol]	EX. FIRE HYDRANT
[Symbol]	EX. WATER VALVE
[Symbol]	EX. WATER METER
[Symbol]	EX. LIGHT POLE
[Symbol]	EX. POWER POLE
[Symbol]	EX. MECHANICAL POLE
[Symbol]	EX. FENCE
[Symbol]	PROP. WALL TO ACCESS
[Symbol]	PROP. STORM SEWER
[Symbol]	PROP. WATER LINE
[Symbol]	PROP. 12" DOUBLE GATE
[Symbol]	PROP. FLOW PATH
[Symbol]	PROP. 12" DOUBLE GATES

NOTE 1: ALL DISTURBED AREAS NOT PAVED TO BE REVEGETATED - REF. LANDSCAPE FOR TYPE

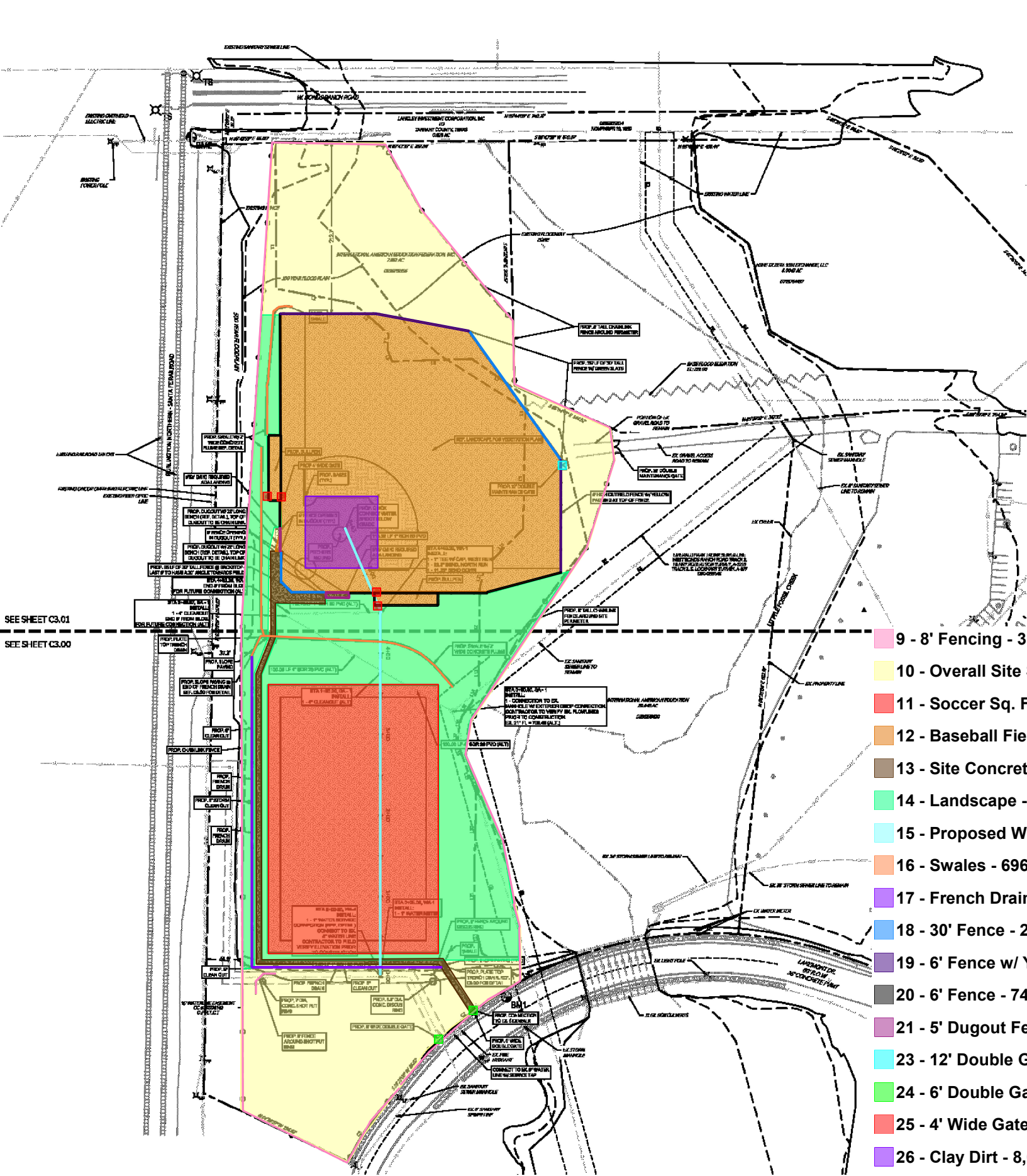

- 9 - 8' Fencing - 3,071 LF
- 10 - Overall Site Sq. Ft. - 382,517 SF
- 11 - Soccer Sq. Ft. - 70,549 SF
- 12 - Baseball Field - 108,349 SF
- 13 - Site Concrete - 6,829 SF
- 14 - Landscape - 80,167 SF
- 15 - Proposed Water Line - 564 LF
- 16 - Swales - 696 LF
- 17 - French Drain - 621 LF
- 18 - 30' Fence - 289 LF
- 19 - 6' Fence w/ Yellow Padding - 377 LF
- 20 - 6' Fence - 749 LF
- 21 - 5' Dugout Fence - 100 LF
- 23 - 12' Double Gates - 1 EA
- 24 - 6' Double Gates - 2 EA
- 25 - 4' Wide Gate - 4 EA
- 26 - Clay Dirt - 8,019 SF

SEE SHEET C3.01
SEE SHEET C3.00

CONSTRUCTION SET

Project:
INTERNATIONAL LEADERSHIP OF TEXAS
KELLER-SAGINAW HIGH SCHOOL PLAYING FIELD ADDITIONS
30557 HWY 281, FORT WORTH, TEXAS 76131

Revised By: [Signature]
 Design: [Signature]
 Checked By: [Signature]
 Date: 08/22/20
 Scale: AS
 Sheet Name:
OVERALL SITE PLAN
 Sheet No.:
C2.00